

NOTES:

1. MATCHED SET - DO NOT ISSUE SEPARATELY.
2. ROTOR AND STATOR TO BE MOUNTED AXIALLY FLUSH $\pm .010$.
3. CUSTOMER MUST MAINTAIN SHAFT RUNOUT WITH RESPECT TO DATUM 'A' WITHIN .003 T.I.R.
4. LEADWIRES COVERED IN SHRINKABLE VITON NOT TO EXCEED LENGTH SHOWN.
5. COIL COVERS ARE NOT RATED TO 204° C

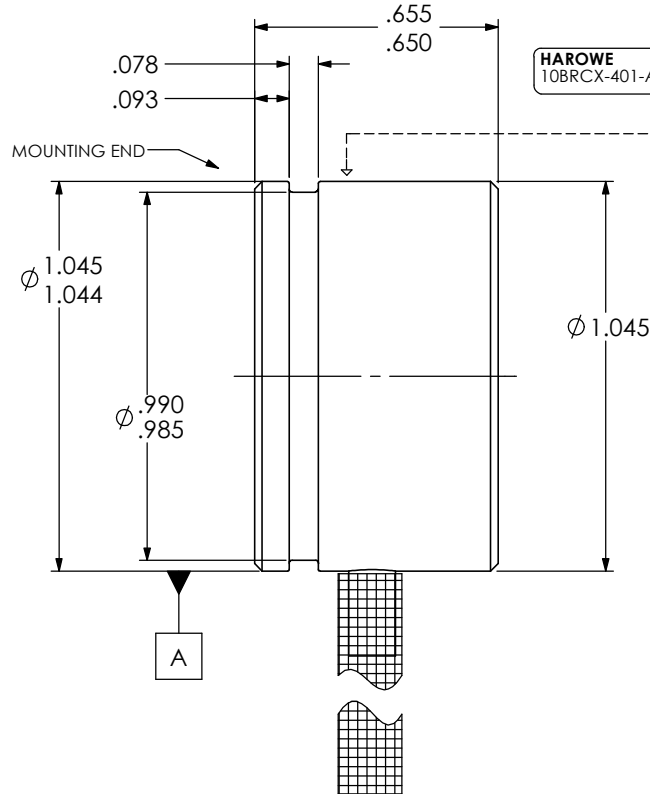
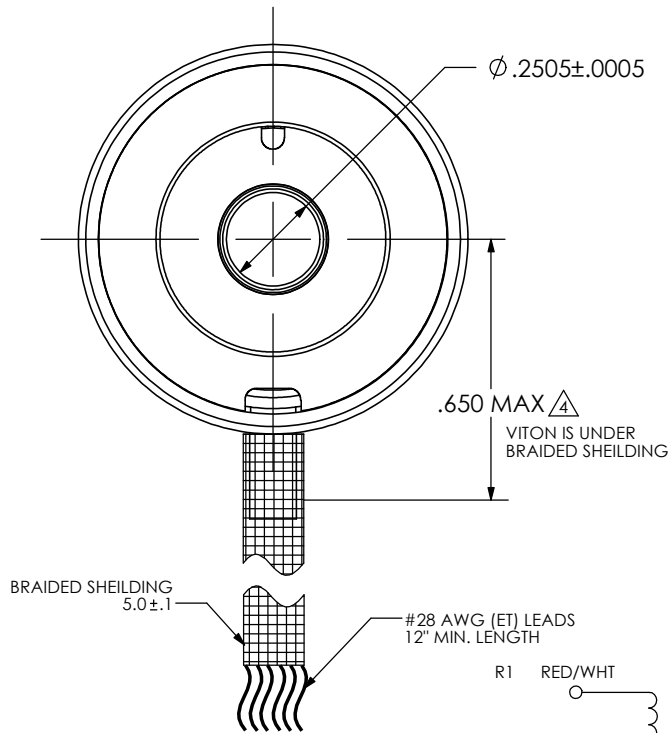

HAROWE
10BRCX-401-A2HR
S/N _____ D/C _____
MADE IN ST. KITTS, WI

ELECTRICAL & MECHANICAL DATA AT 25°C			
VALUES ARE REFERENCE UNLESS OTHERWISE TOLERANCED			
HIPOT TESTING PERFORMED AT 60HZ, 4 SECOND DURATION			
ELEC CYC / MECH CYC	deg/deg		1
EXCITATION FREQUENCY	±5% kHz		10
INPUT VOLTAGE	±10% Vrms		7.0
INPUT CURRENT	Max. mArms		35
INPUT POWER	Watts		.25
IMPEDANCE ZRO	Ohms		227
IMPEDANCE ZRS	Ohms		TBD
IMPEDANCE ZSO	Ohms		TBD
IMPEDANCE ZSS	Ohms		382
TRANSFORMATION RATIO	±10%		0.5
DC RESISTANCE (R1-R2)	±15% Ohms		42
DC RESISTANCE (S1-S3, S2-S4)	±15% Ohms		72
ERROR	Max. arcminutes		±20
PK-PK ERROR	Max. arcminutes		-
PK-PK VELOCITY RIPPLE ERROR	Max. %		-
PHASE SHIFT, OPEN CIRCUIT	degrees		-5
NULL VOLTAGE	Max. mVrms		20
HIPOT, LEADS TO CASE, 500VAC	Max. mArms		2
HIPOT, INTERPHASE, 250VAC	Max. mArms		2
TEMPERATURE RANGE	°C		-55 TO 204
ROTOR MOMENT OF INERTIA	oz-in-sec ²		3.1 X 10 ⁻⁵
WEIGHT	oz		1.3
CONTINUOUS SPEED	Max. kRPM		20

PHASING EQUATION
INCREASING ANGLE
FOR CCW ROTATION AS VIEWED
FROM MOUNTING END

$$E(S1-S3) = KE(R1-R2) \cos \phi$$

$$E(S2-S4) = KE(R1-R2) \sin \phi$$

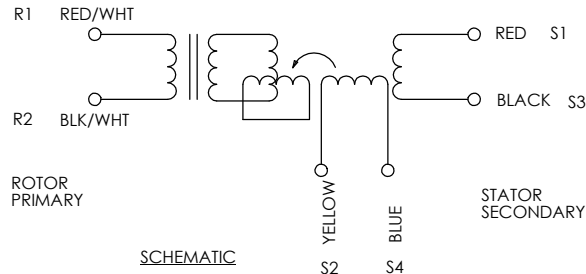

SCHEMATIC

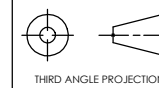

THIRD ANGLE PROJECTION
THE INFORMATION CONTAINED
IN THIS DRAWING IS THE SOLE
PROPERTY OF HAROWE. ANY
REPRODUCTION IN PART OR
WHOLE WITHOUT THE WRITTEN
PERMISSION OF HAROWE IS
PROHIBITED.

UNLESS OTHERWISE SPECIFIED: DIMENSIONS ARE IN INCHES DIAMETERS CONCENTRIC .003 TIR FACES PERPENDICULAR .003 INTERPRETATION PER ASME Y14.5M-1994			
FRACTIONS ±1/64	DECIMALS .00 ±.01 .000 ±.005	ANGLES ±30°	MACHINE SURFACES 63
HEAT TREAT	-	MTG ENG	-
FINISH	-	QUAL ENG	-

REMOVE ALL BURRS AND BREAK SHARP EDGES - .005/5/10 ALL INSIDE CORNERS TO BE .015 R MAX UNLESS OTHERWISE SPECIFIED	
APPROVALS	DATE
DRAWN SEW	12/20/10
CHECKED	-
DES ENG SEW	12/20/10
MTG ENG	-
QUAL ENG	-

Harowe

OUTLINE & PERFORMANCE
SPECIFICATION

RESOLVER BRUSHLESS FRAMELESS

SIZE DWG. NO. 10BRCX-401-A2HR

SCALE 3:1 SHEET 1 OF 2 CODE IDENT: 58655

Mouser Electronics

Authorized Distributor

Click to View Pricing, Inventory, Delivery & Lifecycle Information:

[API Delevan:](#)

[10BRCX-401-A2HR](#)