

NOTES:

1. MATCHED SET - DO NOT ISSUE SEPARATELY.
2. ROTOR AND STATOR TO BE MOUNTED AXIALLY FLUSH ± .010 [.25].
3. CUSTOMER MUST MAINTAIN SHAFT RUNOUT WITH RESPECT TO DATUM 'A' WITHIN .003 [.07] T.I.R.
4. [MM DIMENSIONS] ARE FOR REFERENCE ONLY.

REVISIONS					
REV	ECO	DESCRIPTION	DATE	BY	CHECKED
1		NEW DRAWING	04/19/05	DRW	
2		ADDED 'X' TO PART NUMBER IN TITLE BLOCK AND LABEL	11/17/06	SEW	
3		REMOVED 'X' FROM PN, CHGD PHASE SHIFT TO .5 PER STK DATA	8/6/08	SEW	
4	100118	SEE ECO	03/27/13	TSM	MCP
A	100246	SEE ECO	1/30/2015	DRW	MCP

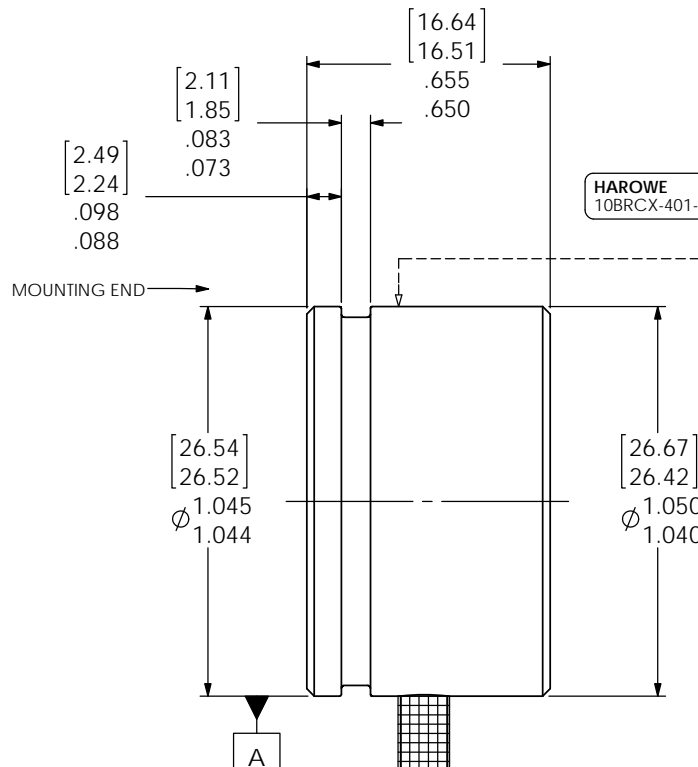
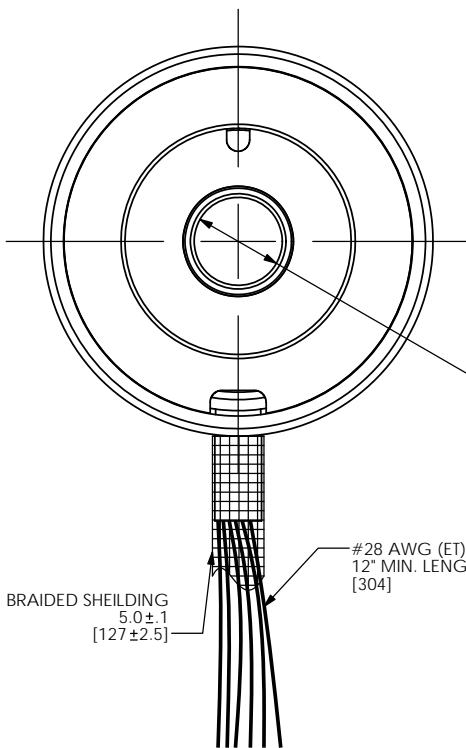

HAROWE
10BRCX-401-A1HR
MADE IN ST. KITTS, WI
S/N _____ D/C _____

ELECTRICAL & MECHANICAL DATA AT 25°C		
VALUES ARE REFERENCE UNLESS OTHERWISE TOLERANCED		
HIPOT TESTING PERFORMED AT 60HZ, 4 SECOND DURATION		
ELEC CYC / MECH CYC	deg/deg	1
EXCITATION FREQUENCY	±1% kHz	10
INPUT VOLTAGE	±5% Vrms	7.0
INPUT CURRENT	Max. mAmps	55
INPUT POWER	Watts	.14
IMPEDANCE [ZRO]	Ohms	184
IMPEDANCE [ZRS]	Ohms	163
IMPEDANCE [ZSO]	Ohms	493
IMPEDANCE [ZSS]	Ohms	439
TRANSFORMATION RATIO	±10%	0.5
DC RESISTANCE (R1-R2)	±15% Ohms	34
DC RESISTANCE (S1-S3, S2-S4)	±15% Ohms	74
ERROR	Max. arcminutes	±20
PHASE SHIFT, OPEN CIRCUIT	degrees	-5
NULL VOLTAGE	Max. mVrms	20
HIPOT, LEADS TO CASE, 500VAC	Max. mAmps	2
HIPOT, INTERPHASE, 250VAC	Max. mAmps	2
TEMPERATURE RANGE	°C	-55 TO +204
WEIGHT	oz	1.3
CONTINUOUS SPEED	Max. kRPM	20

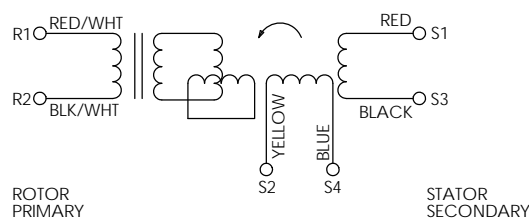

SCHMATIC

PHASING EQUATION
INCREASING ANGLE FOR CCW ROTATION AS VIEWED FROM MOUNTING END

$$E (S1-S3) = KE (R1-R2) \cos \phi$$

$$E (S2-S4) = KE (R1-R2) \sin \phi$$

<p>THIRD ANGLE PROJECTION</p>	<p>UNLESS OTHERWISE SPECIFIED: DIMENSIONS ARE IN INCHES - DIAMETERS CONCENTRIC - .003 TIR FACES PERPENDICULAR - .003 INTERPRETATION PER ASME Y14.5M-1994</p> <p>6/32 MACHINE SURFACES</p> <p>FRACTIONS ±1/64 DECIMALS .00 ±.01 ANGLES ±30' .000 ±.005</p>	<p>REMOVE ALL BURRS AND BREAK SHARP EDGES - .005/010 ALL INSIDE CORNERS TO BE .015 R MAX UNLESS OTHERWISE SPECIFIED</p>	<p>Harowe</p>	
			<p>APPROVALS DATE</p> <p>DRAWN DRW 04/19/05</p> <p>CHECKED MCP 03/27/13</p> <p>DESIGN DRW 04/19/05</p>	
<p>THE INFORMATION CONTAINED IN THIS DRAWING IS THE SOLE PROPERTY OF HAROWE. ANY REPRODUCTION IN PART OR WHOLE WITHOUT THE WRITTEN PERMISSION OF HAROWE IS PROHIBITED.</p>			<p>RESOLVER BRUSHLESS FRAMELESS</p>	
<p>FINISH</p>			<p>SIZE DWG. NO. 10BRCX-401-A1HR</p> <p>SCALE 3:1 SHEET 1 OF 2 CODE IDENT: 58655</p>	

Mouser Electronics

Authorized Distributor

Click to View Pricing, Inventory, Delivery & Lifecycle Information:

[API Delevan:](#)

[10BRCX-401-A1HR](#)