

# FM series

Snap-in rocker switches •  
panel cut-out 19 x 13 (.750 x .508)



## DISTINCTIVE FEATURES

For class II appliances

VDE and UL approved

Protection against moisture by double-shell case

Illuminated or non-illuminated

Optional sealing boot



## ELECTRICAL AND GENERAL SPECIFICATIONS

- Approved ratings (functions 1 and 6) :  
VDE : 10(4) A 250 VAC T85 °C - UL : 6 A 250 VAC & 125 VAC T 65°C
- Max. contact rating :  
- functions 1 and 6 : see above.  
- function 3 : 4 A 250 VAC  
- functions 8 and 9 : 6 A 250 VAC
- LED types available :  
3.3 V (4 V max.) 10 mA LED (resistor to be series connected by the user)  
5 V or 12 V LED with integrated resistor
- Initial contact resistance : 20 mΩ max.
- Insulation resistance : 1,000 MΩ min. at 500 VDC
- Dielectric strength :  
- functions 1 and 6 : 2,500 Vrms between terminals  
- functions 3, 8 and 9 : 1,500 Vrms between terminals
- Electrical life at full load : 10,000 cycles
- Operating temperature : -20 °C to +85 °C (-4 °F to +185 °F)



## MATERIALS

- Case, frame, rocker : PA6/6
- Contacts : silver
- Terminals : silver plated
- Lens : PC
- Lamp terminal : no plating
- Fluorescent lamp for blue or green lens, neon lamp for other colors

APEM products may be recycled at end-of-life for the re-claiming of valuable metal components.

The company reserves the right to change specifications without notice.



# FM series

Snap-in rocker switches •  
panel cut-out 19 x 13 (.750 x .508)

## AGENCY APPROVALS



EN 61058-1

**Availability :** functions 1 and 6.  
**Marking :** approved models are standard marked.



## PANEL CUT-OUT

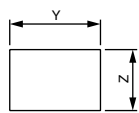

Panel thickness	Dim. Y	Dim. Z
0.75 to 1.25 mm	19.2 +0/-0.1	12.9 +0.15/-0
1.25 to 2 mm	19.4 +0/-0.1	12.9 +0.15/-0
2 to 3 mm	19.8 +0/-0.1	12.9 +0.15/-0



## TERMINALS

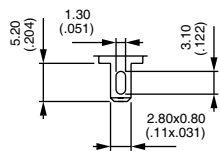

2  
Solder lug

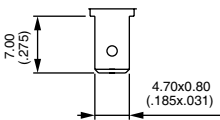

8  
Quick-connect

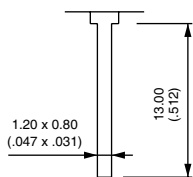

9  
Straight PC  
(functions 1 and 6 only)

# FM series

Snap-in rocker switches •  
panel cut-out 19 x 13 (.750 x .508) • non-illuminated



## BUILD YOUR PART NUMBER

NON-ILLUMINATED  
ILLUMINATED SEE NEXT PAGES

### BASIC PART NUMBER

<div>FM</div>	<div>C</div>		
SERIES	ROCKER	ELECTRICAL FUNCTIONS	TERMINALS
	<div>C</div> Non illuminated Concave	<div>1</div> ON - OFF	<div>2</div> Solder lug
		<div>3</div> MOM - OFF	<div>8</div> Quick-connect
		<div>6</div> ON - ON	<div>9</div> Straight PC (funct. 1 & 6)
		<div>8</div> ON OFF MOM	
		<div>9</div> ON OFF ON	

### OPTIONS

<div>A</div> <div>CONTACTS</div>	<div></div> <div>FRAME COLOR</div>	<div></div> <div>ROCKER COLORS</div>	<div>0</div> <div>LENS COLOR</div>	<div>0</div> <div>LAMP</div>	<div></div> <div>MARKING</div>
<div>A</div> Silver	<div>2</div> Black  Others : on request.	<div>1</div> Blue <div>2</div> Black (std) <div>3</div> Green <div>4</div> Grey <div>5</div> Yellow <div>6</div> Red (std) <div>7</div> Ivory <div>7/1</div> White <div>9</div> Orange	<div>0</div> No lens	<div>0</div> None	<div>000</div> None <div>001</div> <div>0</div> <div>002</div> <div>0</div> — <div>003</div> <div>0</div>   <div>004</div>   0    <div>005</div> <div>OFF</div> <div>ON</div>



## ABOUT THIS SERIES

On the following pages, you will find successively basic part numbers of switches and options in the same order as in above chart.

- ⚠ **Notice** : please note that not all combinations of above numbers are available. Refer to the following pages for further information.
- 💧 **A sealing boot** is available to protect the switches against sand or splashing water. Part number U7720. See "Sealing boots" section of website.

# FM series

Snap-in rocker switches •  
panel cut-out 19 x 13 (.750 x .508) • non-illuminated

## NON-ILLUMINATED QUICK-CONNECT TERMINALS



Single pole	1-2		2-3
FMC18	ON	-	OFF
FMC38	MOM	-	OFF
FMC68	ON	-	ON
FMC88	ON	OFF	MOM
FMC98	ON	OFF	ON

For solder lug terminals, replace 8 with 2 (FMC•2)  
For straight PC terminals, replace 8 with 9 (FMC•9)

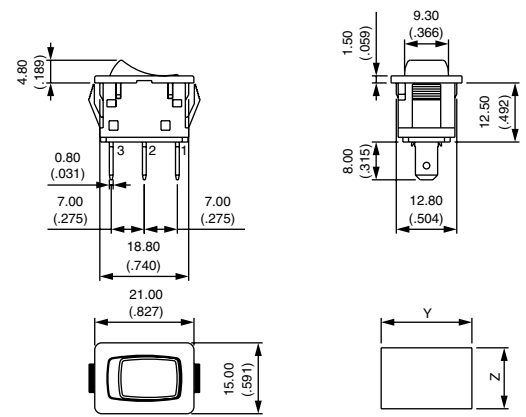

### CONTACT MATERIALS



A Silver

### FRAME COLOR



2 Black

Others : on request

### ROCKER COLORS



- 1 Blue
- 2 Black (std)
- 3 Green
- 4 Grey
- 5 Yellow
- 6 Red (std)
- 7 Ivory
- 7/1 White
- 9 Orange

### LENS COLOR



0 No lens

# FM series

Snap-in rocker switches •  
panel cut-out 19 x 13 (.750 x .508) • non-illuminated

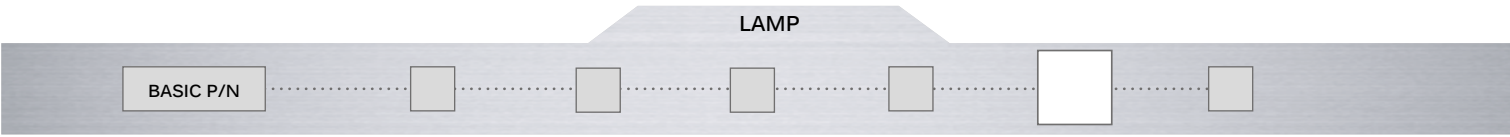

0      None

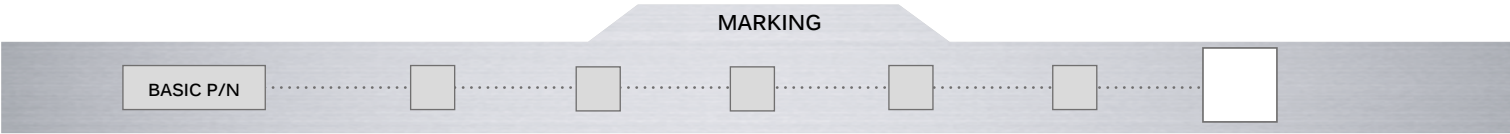

Color of marking : white for black rockers - black for other colors - Other : on request.

000	None
001	<div>0</div>
002	<div>0 -</div>
003	<div>0 I</div>
004	<div>I 0 II</div>
005	<div>OFF ON</div>

# FM series

Snap-in rocker switches •  
panel cut-out 19 x 13 (.750 x .508) • illuminated

## BUILD YOUR PART NUMBER

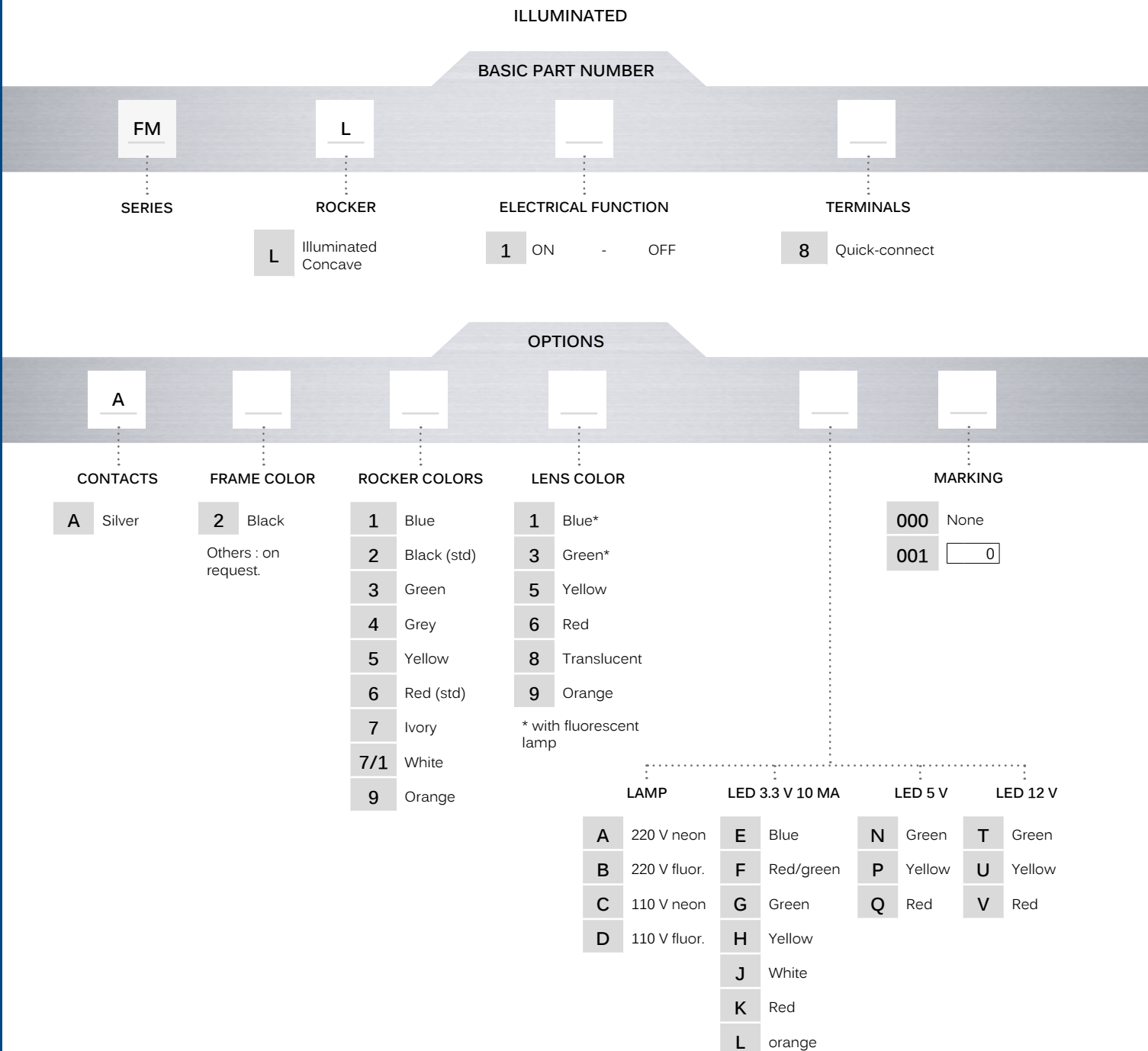



\*\* Resistor value =  $\frac{\text{supply voltage} - \text{LED forward voltage}}{\text{LED forward current}}$

No resistor\*\*

## ABOUT THIS SERIES

On the following pages, you will find successively basic part numbers of switches and options in the same order as in above chart.

-  **Notice** : please note that not all combinations of above numbers are available. Refer to the following pages for further information.
-  **A sealing boot** is available to protect the switches against sand or splashing water. Part number U7720. See "Sealing boots" section of website.

# FM series

Snap-in rocker switches •  
panel cut-out 19 x 13 (.750 x .508) • illuminated

## ILLUMINATED QUICK-CONNECT TERMINALS



Single pole

**FML18**

ON - OFF

For LED models, terminal 2 = cathode (-), terminal 3 = anode (+)

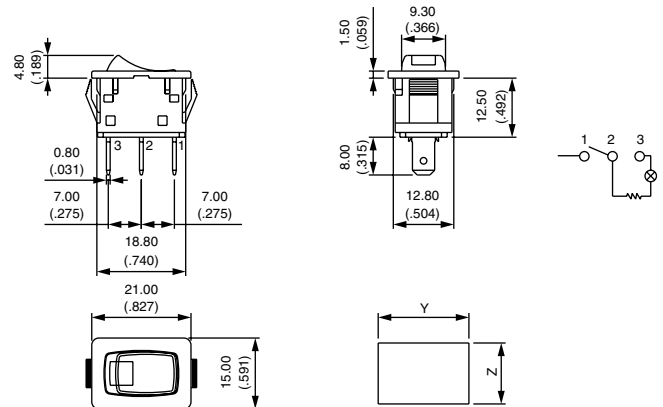

### CONTACT MATERIALS



A Silver

### FRAME COLOR



2 Black  
Others : on request

### ROCKER COLORS

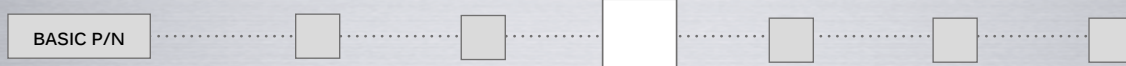

- 1 Blue
- 2 Black (std)
- 3 Green
- 4 Grey
- 5 Yellow
- 6 Red (std)
- 7 Ivory
- 7/1 White
- 9 Orange

### LENS COLORS

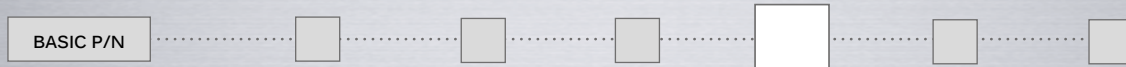

- 1 Blue \*
- 3 Green \*
- 5 Yellow
- 6 Red
- 8 Translucent
- 9 Orange

\* with fluorescent lamp

# FM series

Snap-in rocker switches •  
panel cut-out 19 x 13 (.750 x .508) • illuminated

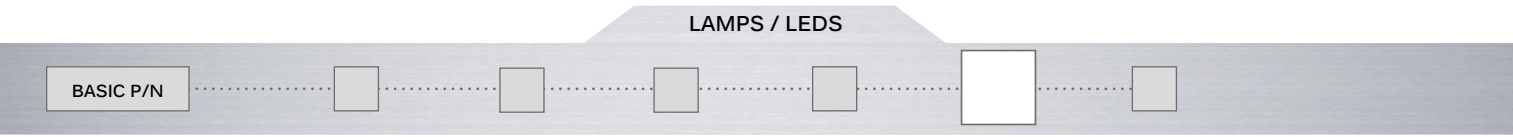

LAMP		LED 3.3 V 10 mA		LED 5 V		LED 12 V	
A	220 V neon	E	Blue	N	Green	T	Green
B	220 V fluorescent	F	Red/green	P	Yellow	U	Yellow
C	110 V neon	G	Green	Q	Red	V	Red
D	110 V fluorescent	H	Yellow				
		J	White				
		K	Red				
		L	Orange				
		No resistor **					

\*\* Resistor value =  $\frac{\text{supply voltage} - \text{LED forward voltage}}{\text{LED forward current}}$

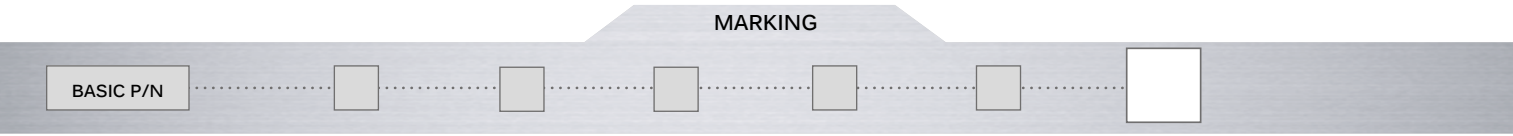

Color of marking : white for black rockers - black for other colors - Other : on request.

000	None
001	<div>0</div>



# Mouser Electronics

Authorized Distributor

Click to View Pricing, Inventory, Delivery & Lifecycle Information:

## Apem:

<a href="#"><u>FMC62A2200000</u></a>	<a href="#"><u>FMC92A2200000</u></a>	<a href="#"><u>FMC32A2200000</u></a>	<a href="#"><u>FMC12A2200000</u></a>	<a href="#"><u>FML18A276A000</u></a>	<a href="#"><u>FMC12A2200005</u></a>
<a href="#"><u>FMC12A2500000</u></a>	<a href="#"><u>FMC12A2600000</u></a>	<a href="#"><u>FMC18A2200000</u></a>	<a href="#"><u>FMC18A2200002</u></a>	<a href="#"><u>FMC18A2200003</u></a>	<a href="#"><u>FMC18A2200005</u></a>
<a href="#"><u>FMC18A2300000</u></a>	<a href="#"><u>FMC18A2600002</u></a>	<a href="#"><u>FMC18A2600003</u></a>	<a href="#"><u>FMC18A2700001</u></a>	<a href="#"><u>FMC19A2200000</u></a>	<a href="#"><u>FMC19A2200005</u></a>
<a href="#"><u>FMC38A2200000</u></a>	<a href="#"><u>FMC38A2200002</u></a>	<a href="#"><u>FMC38A2200003</u></a>	<a href="#"><u>FMC38A2600000</u></a>	<a href="#"><u>FMC38A2600003</u></a>	<a href="#"><u>FMC68A2200000</u></a>
<a href="#"><u>FMC68A2200003</u></a>	<a href="#"><u>FMC68A2200006</u></a>	<a href="#"><u>FMC68A2600000</u></a>	<a href="#"><u>FMC69A2900000</u></a>	<a href="#"><u>FMC78A2200006</u></a>	<a href="#"><u>FMC82A2200000</u></a>
<a href="#"><u>FMC88A2200000</u></a>	<a href="#"><u>FMC88A2200006</u></a>	<a href="#"><u>FMC92A2200004</u></a>	<a href="#"><u>FMC98A2200000</u></a>	<a href="#"><u>FMC98A2200004</u></a>	<a href="#"><u>FMC98A2200006</u></a>
<a href="#"><u>FMC98A2600004</u></a>	<a href="#"><u>FML18A221D000</u></a>	<a href="#"><u>FML18A223B000</u></a>	<a href="#"><u>FML18A225A000</u></a>	<a href="#"><u>FML18A226A000</u></a>	<a href="#"><u>FML18A226V000</u></a>
<a href="#"><u>FML18A228A000</u></a>	<a href="#"><u>FML18A228B000</u></a>	<a href="#"><u>FML18A236A000</u></a>	<a href="#"><u>FML18A266A000</u></a>	<a href="#"><u>FML18A226Q000</u></a>	