

MPB SERIES PUSHBUTTON SWITCHES

FEATURES

- Single pole single throw momentary action.
- Normally open and normally closed models.
- Permanent cap is standard.
- Single hole mounting w/mtg. nut & lk'wshr supplied.

MATERIALS

Base: PBT thermoplastic, color black
Bushing: Brass, nickel plated
Actuator: ABS thermoplastic
Terminals: Brass, silver plated
Shorting Contact: Brass or phos. brz., silver plated

GENERAL SPECIFICATIONS

ELECTRICALS

Contact rating:	300 mA @ 125 VAC
Insulation resistance:	100 megohms min. (500 VDC)
Dielectric withstanding voltage:	500 VAC for 1 minute
Contact resistance:	25 milliohms max. at 1 amp, 5 VDC
Electrical/Mechanical life:	10,000 cycles min.
Contact bounce:	less than 10 milliseconds

MECHANICALS, THERMALS

Plunger travel:	MPB1110: .063" (1.6mm) MPB1140: .078" (2mm)
Actuation force:	300 grams \pm 150 grams
Operating temperature range:	-20 °C to +60 °C

SOLDERING

Wave or hand soldering:	235°C max. for 5 seconds max.
Solvent washing:	Non-washable. Do not apply flux to terminals or switch mtg. surface

MPB1110

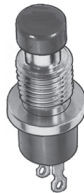

NORMALLY OPEN



SCHEMATIC

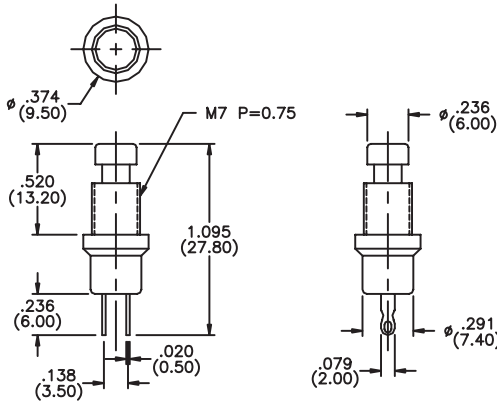

MECHANICAL OUTLINE

Model No.	Cap Color
MPB11102	Black
MPB11106	Red

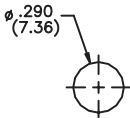

TOLERANCE FOR PANEL
MTG. HOLE: $+0.005$ (0.13)
 -0.000 (0.00)

PANEL MTG. HOLE

MPB1140



NORMALLY CLOSED



SCHEMATIC

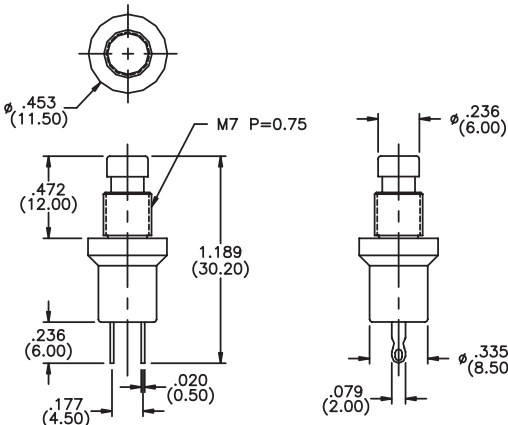

MECHANICAL OUTLINE

Model No.	Cap Color
MPB11402	Black
MPB11406	Red

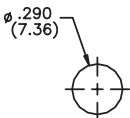

TOLERANCE FOR PANEL
MTG. HOLE: $+0.005$ (0.13)
 -0.000 (0.00)

PANEL MTG. HOLE

Mouser Electronics

Authorized Distributor

Click to View Pricing, Inventory, Delivery & Lifecycle Information:

[Apem:](#)

[MPB11102](#) [MPB11106](#) [MPB11402](#) [MPB11406](#)