

SOCKETS FOR PUSHWHEEL SWITCHES

FEATURES

- Glass fiber reinforced, self extinguishing body.
- Solder lug or p.c. terminals.
- Permanently marked terminals.
- High insertion/withdrawal force.

MATERIALS

Body: Glass fiber reinforced PPO (self-extinguishing, non drip group 1).

Contacts: Gold over nickel over phosphor bronze

SPECIFICATIONS

Contact spacing: .079" (2mm)

Contact rating: 40 V at 1 Amp

Contact resistance: Less than 15 milliohms

Insulation resistance: Greater than 10^{12} ohms

Test voltage: 500 V

Operating temperature: -40°C to 100°C

Insertion force/contact: Approx. 7.2 oz.

Withdrawal force/contact: Approx. 6.5 oz.

Socket integrity: 100 insertions min. with no change to above values

TERMINATIONS

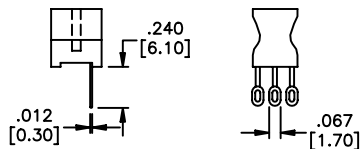

L Solder lug (for .100" (2.54mm) spacing only).

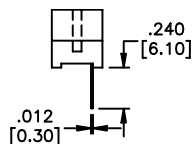

LS Printed circuit

ORDER FORMAT:

Make selections shown below boxes for complete connector model number.

Series: ☐ A or B

No. of poles: ☐ 9 or 12 for Series A
☐ 5, 9, 11 or 12 for Series B

Terminations: ☐ L for solder lug
☐ LS for printed circuit

Example of complete model no.: B11LS

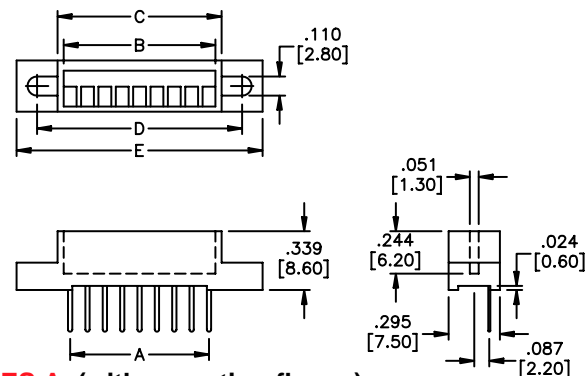
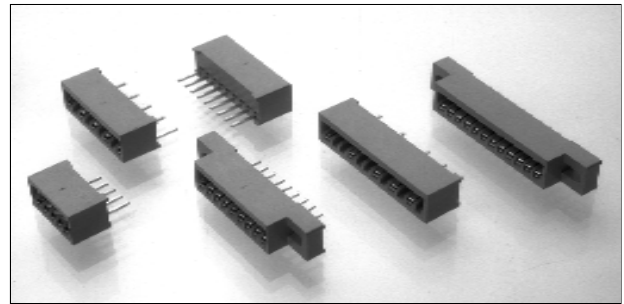

SERIES A (with mounting flange)

| Poles/models | A | B | C | D | E |
|---------------------------|---------------------|-----------------|---------------|---------------|---------------|
| 9 poles for SMCD & DPS8 | 8 X .100" (2.54mm) | .874" (22.2mm) | .945" (24mm) | 1.180" (30mm) | 1.417" (36mm) |
| 12 poles for DPS9 & DPS10 | 11 x .100" (2.54mm) | 1.200" (30.5mm) | 1.300" (33mm) | 1.535" (39mm) | 1.772" (45mm) |

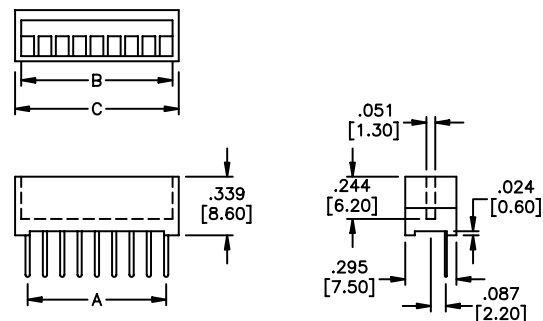

SERIES B (without mounting flange)

| Poles/models | A | B | C |
|---------------------------|---------------------|-----------------|----------------|
| 5 poles for PICOD | 4 X .100" (2.54mm) | .559" (14.2mm) | .598" (15.2mm) |
| 9 poles for SMCD & DPS8 | 8 X .100" (2.54mm) | .874" (22.2mm) | .945" (24mm) |
| 11 poles for SMCD & DPS8 | 10 X .079" (2.00mm) | .874" (22.2mm) | .945" (24mm) |
| 12 poles for DPS9 & DPS10 | 11 x .100" (2.54mm) | 1.200" (30.5mm) | 1.300" (33mm) |

Mouser Electronics

Authorized Distributor

Click to View Pricing, Inventory, Delivery & Lifecycle Information:

[Apem:](#)

[B5LS](#)