

5000M series

Miniature toggle switches •
threaded bushing Ø 11.9 mm



DISTINCTIVE FEATURES

Bushing Ø 11.9 (15/32)

Panel mounting and PCB terminal combination available

1 to 4 pole configurations

UL and CSA approved



ELECTRICAL SPECIFICATIONS

- Current/voltage rating with resistive load :

Contact	Maximum	Minimum	Level*
Silver (A)	4 A 30 VDC	50 mA 10 VDC	III and IV
Silver, gold plated (AD)	4 A 30 VDC Gold plating withstands up to 100 mA 30 VDC	10 mA 50 mV 10 µA 5 V	I to IV
Brass, gold plated (CD)	0.4 VA at 20 VAC or DC	10 mA 50 mV 10 µA 5 V	I and II

*For details, see Technical Information on website.

- For inductive, lamp or capacitive load, consult factory.
- Initial contact resistance : 10 mΩ max.
- Insulation resistance : 1,000 MΩ min. at 500 VDC
- Dielectric strength :
1,000 Vrms 50 Hz min. between terminals
1,500 Vrms 50 Hz min. between poles
1,500 Vrms 50 Hz min. between terminals and frame
- Contact bounce : 2 ms max.
- Electrical life at full load :
50,000 cycles for single and double pole
40,000 cycles for 3 pole
30,000 cycles for 4 pole
- Low level or mechanical life : 100,000 cycles



GENERAL SPECIFICATIONS

- Torque : 1.25 Nm (.922 Ft.lb) max. applied to nut
- Panel thickness : up to 6 mm (.236)
- Operating temperature : -40 °C to +85 °C (-40 °F to +185 °F)

The company reserves the right to change specifications without notice.



5000M series

Miniature toggle switches •
threaded bushing Ø 11.9 mm



MATERIALS

- Case : diallylphthalate (DAP) or high temperature plastic material (UL94-V0)
- Actuator : brass, nickel plated
- Bushing : brass, nickel plated
- Housing : stainless steel or steel tin plated
- Contacts
 - A : silver
 - AD : silver, gold plated
 - CD : brass, gold plated
 - X814 : for peak currents, see "Special options".
- Terminal seal : epoxy

AGENCY APPROVALS



3 A 250 VAC, 6 A 125 VAC

Availability : consult factory for details of approved models.

Marking : to order switches marked UL or CSA, complete appropriate box of ordering format. The preferential list does not appear on the switches.



PANEL CUT-OUT

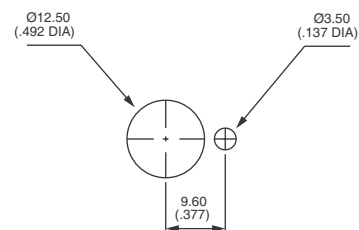

Standard

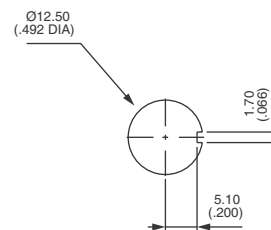

With K sealing option



ELECTRICAL FUNCTION

→ KEYWAY

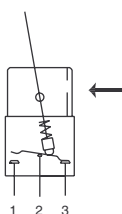

TERMINALS

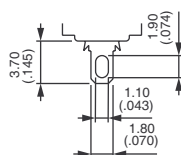

5000M series

Miniature toggle switches •
threaded bushing Ø 11.9 mm



BUILD YOUR PART NUMBER

BASIC PART NUMBER									
5									
SERIES	TERMINALS	NUMBER OF POLES			TERMINALS		MOMENTARY FOR FUNCTION 4		
	2	3	4	5	6	M	1R	2R	
	Straight PC terminals, 4.70 (.185) terminal spacing - On request.	Single pole	Double pole	Three pole	Four pole	Solder lugs with Ø 11.9 (15/32) bushing	ON ON MOM	MOM ON MOM	Leave blank for other functions.
	6								
	Solder lug terminals								
ELECTRICAL FUNCTIONS									
6	ON	-	ON	8	ON	OFF	MOM		
9	ON	OFF	ON	4	ON	ON	ON		
7	MOM	OFF	MOM		ON	ON	MOM ▲		
CONNECTIONS FOR FUNCTION 4									
							TH	Standard	
							CT	Reversed	
For functions 4, 4-1R, 4-2R (leave blank for all other functions). Wiring diagrams, see Technical information on website.									

Function 4
▲ Must not have blank in «momentary» box.
Wiring diagrams, see Technical information, on website.

OPTIONS				
CONTACT MATERIALS	FINISH	SEALING	LEVERS	AGENCY APPROVALS
A	Blank	Blank	Blank (std)	UL, CSA
AD	G	K	-27	
CD		B		
Silver	Nickel plated	No sealing	Length 17.5 (.688)	Availability : Consult factory for details of approved models.
Silver, gold plated	Black finish on bushing, actuator and hardware.	Front panel sealing by one O-ring and sealing washer	Length 11.7 (.460)	
Brass, gold plated		Epoxy sealed terminals		



ABOUT THIS SERIES

On the following pages, you will find successively basic part numbers of switches and options in the same order as in above chart.

⚠ **Notice:** please note that not all combinations of above numbers are available. Refer to the following pages for further information.

⚙ Mounting accessories : standard hardware supplied with all models : 2 hex nuts 14 mm (.551) across flats and 1 locking ring. Standard and special hardware is presented in the "Hardware" section of website.

5000M series

Miniature toggle switches •
threaded bushing Ø 11.9 mm

SOLDER LUG TERMINALS SINGLE POLE



	III	II	I
5636M	2-3	-	1-2
5639M	ON	OFF	ON
5637M	MOM	OFF	MOM
5638M	ON	OFF	MOM

SOLDER LUG TERMINALS DOUBLE POLE



	III	II	I
5646M	2-3	-	1-2
5649M	5-6	-	4-5
5647M	ON	OFF	ON
5648M	MOM	OFF	MOM
5644 M*	ON	ON	ON
5644M 1R*	ON	ON	MOM
5644M 2R*	MOM	ON	MOM

SOLDER LUG TERMINALS THREE POLE



	III	II	I
5656M	2-3	-	1-2
5659M	5-6	-	4-5
5657M	8-9	-	7-8
5658M	ON	OFF	ON
5659M	ON	OFF	ON
5657M	MOM	OFF	MOM
5658M	ON	OFF	MOM

SOLDER LUG TERMINALS FOUR POLE



	III	II	I
5666M	2-3	-	1-2
5669M	5-6	-	4-5
5667M	8-9	-	7-8
5668M	11-12	-	10-11
5666M	ON	OFF	ON
5669M	ON	OFF	ON
5667M	MOM	OFF	MOM
5668M	ON	OFF	MOM
5664 M*	ON	ON	ON
5664M 1R*	ON	ON	MOM
5664M 2R*	MOM	ON	MOM

→ KEYWAY

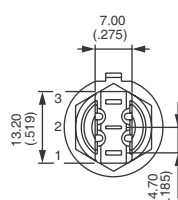

Shown with standard lever

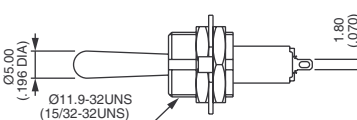
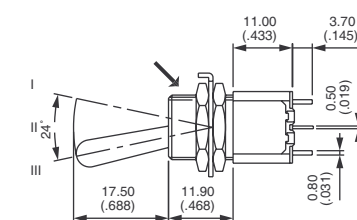

→ KEYWAY

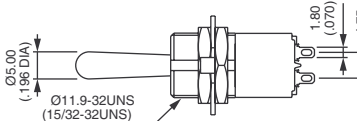
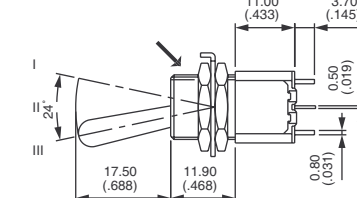
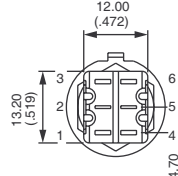

*Function 4 : DP in 4P case - specify CT or TH connections, see "Technical information" on website.

→ KEYWAY

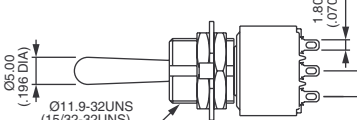
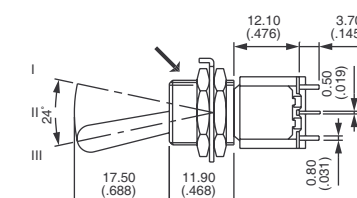
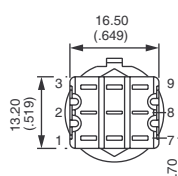

→ KEYWAY

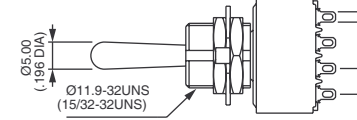
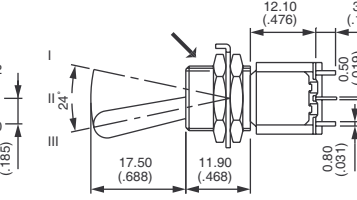
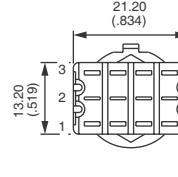

*Function 4 : DP in 4P case - specify CT or TH connections, see "Technical information" on website.

5000M series

Miniature toggle switches • threaded bushing Ø 11.9 mm

CONTACT MATERIAL



- A Silver
- AD Silver, gold plated
- CD Brass, gold plated

FINISH

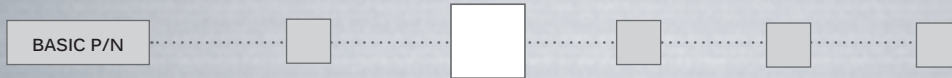

- Blank Nickel plated
- G Black finish on bushing, actuator and hardware

SEALING

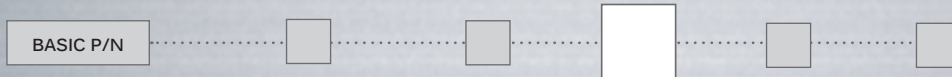

- Blank No sealing required
- K Keyway bushing, Includes washer **U60**
Front panel sealing by one O-ring and sealing washer.
Protects the switch against water and dust.
Panel seal withstands 1 bar pressure and remains sealed even when switch is operated.
- B Epoxy sealed terminals
- KB Combined sealings

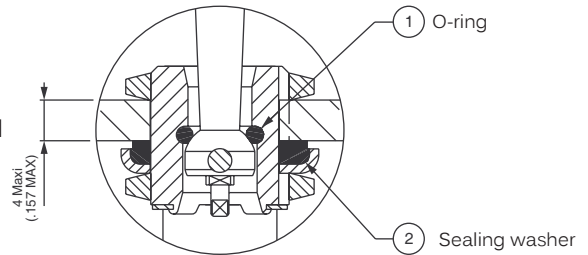

K

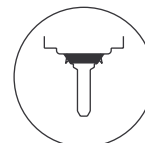

B

LEVERS

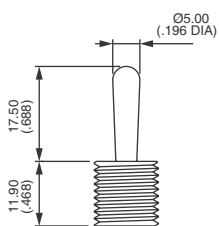
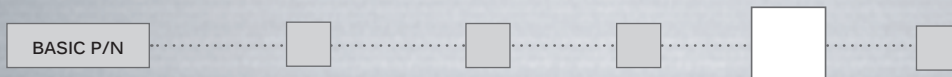

Blank
Standard

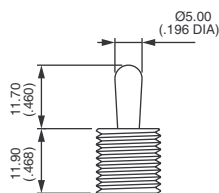

-27

5000M series

Miniature toggle switches •
threaded bushing Ø 11.9 mm

AGENCY APPROVALS

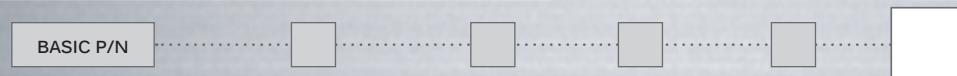

UL

CSA

Blank No agency approval required.

Availability : consult factory for details of approved combinations or options.

Marking : to order switches marked UL or CSA, complete above box with desired approvals, in this order & without space (ex. : ULCSA).

Mouser Electronics

Authorized Distributor

Click to View Pricing, Inventory, Delivery & Lifecycle Information:

[Apem:](#)

[5656AB9](#) [5666AB9](#) [5637ADB9](#) [5242MIWRADB449](#)