

Features

- Halogen Free Available Upon Request By Adding Suffix "-HF"
- Lead Free Finish/RoHS Compliant(Note 1) ("P" Suffix Designates Compliant. See Ordering Information)
- Epoxy Meets UL 94 V-0 Flammability Rating
- Low Power Loss and High Efficiency
- Guardring for Overvoltage Protection
- High Junction Temperature Capability

Maximum Ratings @ 25°C (Unless Otherwise Specified)

Parameter	Symbol	Value			Unit
		MBR20100FCTH	MBR20150FCTH	MBR20200FCTH	
Peak Repetitive Reverse Voltage	V_{RRM}	100	150	200	V
Working Peak Reverse Voltage	V_{RWM}				
DC Blocking Voltage	V_R				
RMS Reverse Voltage	V_{RMS}	70	105	140	V
Average Rectified Forward Current	$I_{F(AV)}$	10 20			A
Per Diode Per Device					
Non-Repetitive Peak Surge Current (Per Diode) @8.3ms Half Sine Wave	I_{FSM}	200			A
Current Squared Time (Per Diode) @ $1ms \leq t \leq 8.3ms$	I^2t	166			A ² s

Marking Code

Part Number	Marking Code
MBR20100FCTH	MBR20100FCTH
MBR20150FCTH	MBR20150FCTH
MBR20200FCTH	MBR20200FCTH

Internal Structure

Pin	Description	Simplified Outline	Graphic Symbol
2	Cathode		
1&3	Anode		

Note :1. High Temperature Solder Exemption Applied, See EU Directive Annex 7a.

20 Amp Schottky Barrier Rectifier 100 to 200 Volts

ITO-220AB

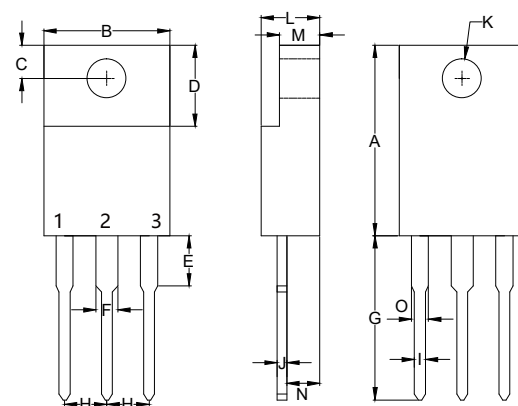

DIM	INCHES		MM		NOTE
	MIN	MAX	MIN	MAX	
A	0.567	0.642	14.40	16.30	
B	-----	0.421	-----	10.70	
C	0.085	0.128	2.15	3.25	
D	0.248	0.272	6.30	6.90	
E	-----	0.177	-----	4.50	
F	-----	0.071	-----	1.80	
G	0.500	0.539	12.70	14.20	
H	0.100		2.55		
I	-----	0.035	-----	0.90	
J	-----	0.032	-----	0.80	
K	0.102	0.150	2.60	3.80	Φ
L	-----	0.201	-----	5.10	
M	-----	0.140	-----	3.56	
N	0.083	0.126	2.10	3.20	
O	-----	0.071	-----	1.80	

Thermal characteristics

Symbol	Parameter	Conditions	Min	Typ	Max	Unit
T_J	Operating Junction Temperature Range		-55		175	°C
T_{stg}	Storage Temperature Range		-55		175	°C
$R_{th(J-C)}$	Thermal Resistance from Junction to Case	Per Leg		3.2		°C/W
$R_{th(J-A)}$	Thermal Resistance from Junction to Ambient	Without Heatsink, Free air		60		°C/W

Mechanical Data

Recommended Mounting Torque: 5in·lbs

Electrical Characteristics @ 25°C Unless Otherwise Specified

Parameter	Symbol	Test Conditions	Min	Typ	Max	Unit
Forward Voltage Per Diode MBR20100FCTH MBR20150FCTH MBR20200FCTH	V_F	$I_F=10A; T_J=25^{\circ}C$			0.80 0.85 0.90	V
Reverse Current Per Diode	I_R	at Rated $V_R; T_J=25^{\circ}C$			10	μA
		at Rated $V_R; T_J=125^{\circ}C$			2	mA
Junction Capacitance Per Diode MBR20100FCTH MBR20150FCTH MBR20200FCTH	C_J	$V_R=4V; f=1MHz; T_J=25^{\circ}C$		270 215 165		pF

Curve Characteristics

Fig. 1 - Forward Current Derating Curve

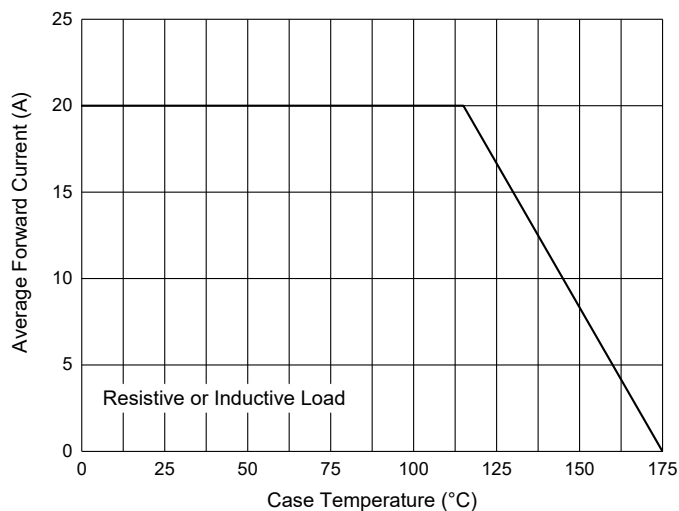

Fig. 2 - Maximum Non-Repetitive Peak Forward Surge Current Per Diode

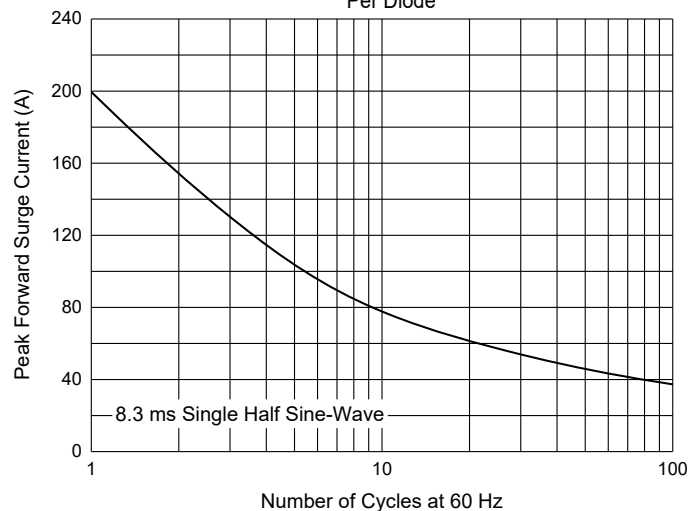

Fig. 3 - Typical Forward Characteristics Per Diode

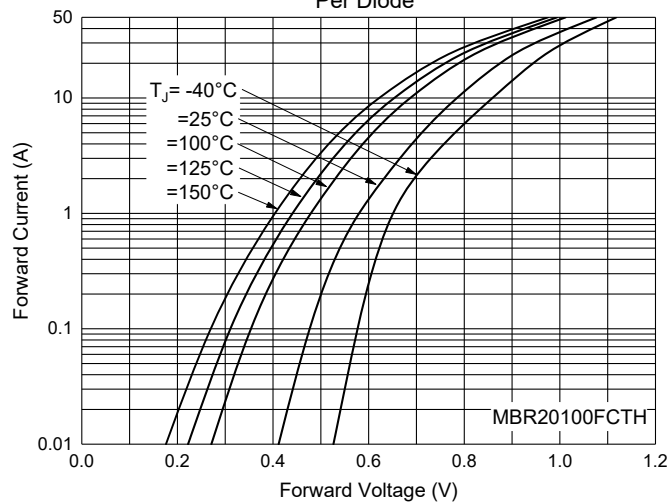

Fig. 4 - Typical Reverse Leakage Characteristics Per Diode

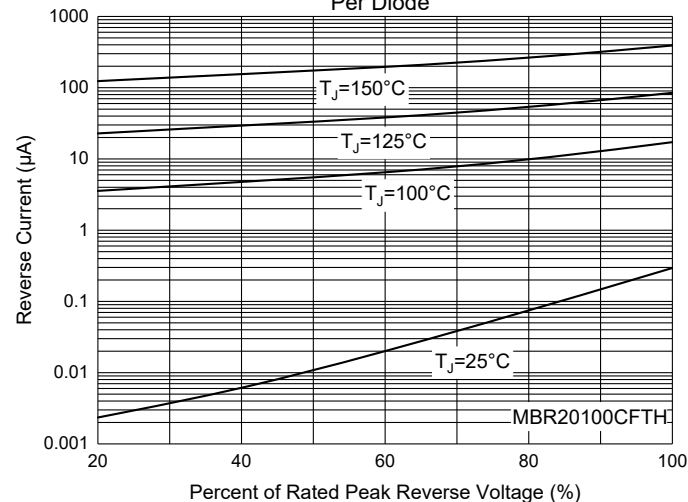

Fig. 5 - Typical Forward Characteristics Per Diode

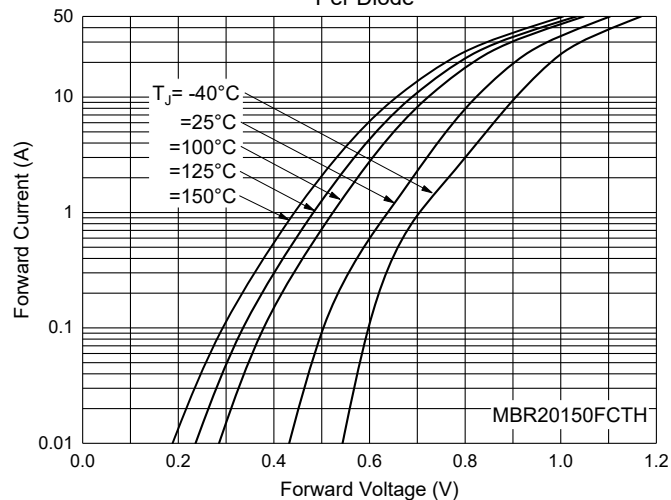
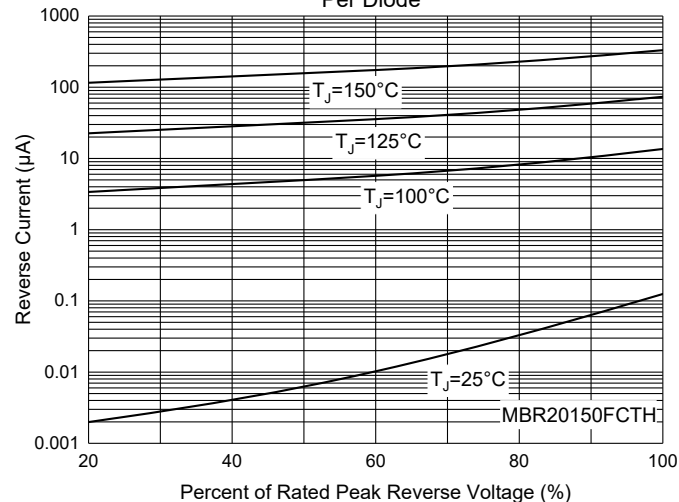

Fig. 6 - Typical Reverse Leakage Characteristics Per Diode



Curve Characteristics

Fig. 7 - Typical Forward Characteristics
Per Diode

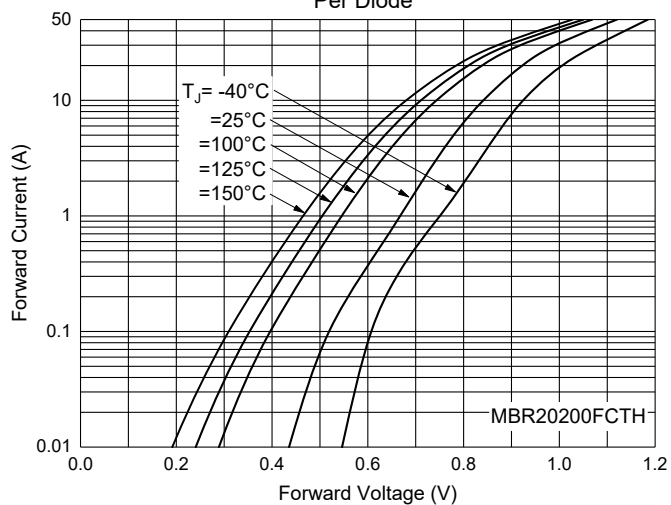

Fig. 8 - Typical Reverse Leakage Characteristics
Per Diode

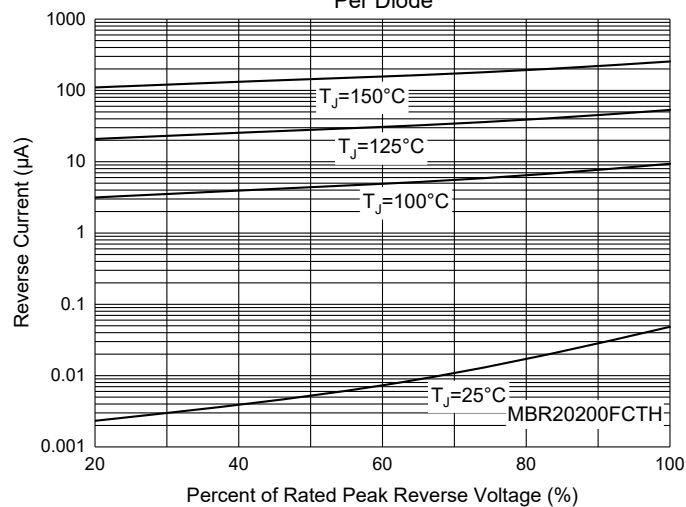
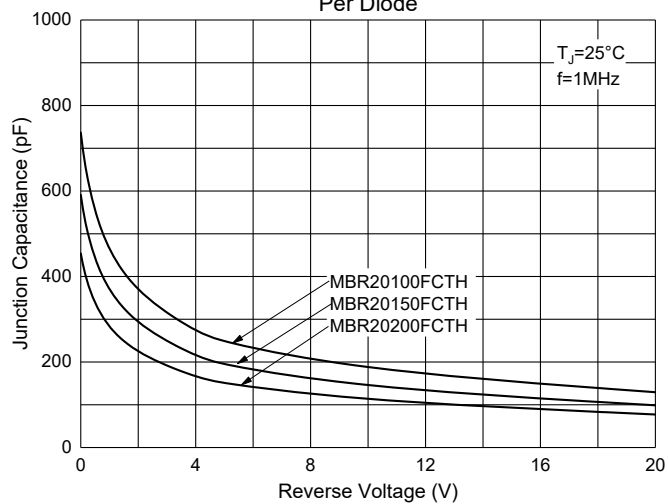

Fig. 9 - Typical Capacitance Characteristics
Per Diode



Ordering Information

Device	Packing
Part Number-BP	Bulk:50pcs/Tube, 1Kpcs/Box, 5Kpcs/Carton

Note : Adding "-HF" Suffix For Halogen Free, eg. Part Number-BP-HF

IMPORTANT NOTICE

Micro Commercial Components Corp. reserves the right to make changes without further notice to any product herein to make corrections, modifications , enhancements , improvements , or other changes . **Micro Commercial Components Corp.** does not assume any liability arising out of the application or use of any product described herein; neither does it convey any license under its patent rights ,nor the rights of others . The user of products in such applications shall assume all risks of such use and will agree to hold **Micro Commercial Components Corp.** and all the companies whose products are represented on our website, harmless against all damages. **Micro Commercial Components Corp.** products are sold subject to the general terms and conditions of commercial sale, as published at <https://www.mccsemi.com/Home/TermsAndConditions>.

LIFE SUPPORT

MCC's products are not authorized for use as critical components in life support devices or systems without the express written approval of Micro Commercial Components Corporation.

CUSTOMER AWARENESS

Counterfeiting of semiconductor parts is a growing problem in the industry. Micro Commercial Components (MCC) is taking strong measures to protect ourselves and our customers from the proliferation of counterfeit parts. MCC strongly encourages customers to purchase MCC parts either directly from MCC or from Authorized MCC Distributors who are listed by country on our web page cited below. Products customers buy either from MCC directly or from Authorized MCC Distributors are genuine parts, have full traceability, meet MCC's quality standards for handling and storage. **MCC will not provide any warranty coverage or other assistance for parts bought from Unauthorized Sources.** MCC is committed to combat this global problem and encourage our customers to do their part in stopping this practice by buying direct or from authorized distributors.

Mouser Electronics

Authorized Distributor

Click to View Pricing, Inventory, Delivery & Lifecycle Information:

[Micro Commercial Components \(MCC\):](#)

[MBR20200FCTH-BP](#) [MBR20100FCTH-BP](#) [MBR20150FCTH-BP](#)