

Obsolete

M.C.C.

Micro Commercial Components



Micro Commercial Components
20736 Marilla Street Chatsworth
CA 91311

Phone: (818) 701-4933

Fax: (818) 701-4939

2N2907
2N2907A

Features

- High current (max.600mA)
- Low voltage (max.60V)
- Lead Free Finish/RoHS Compliant(Note 1) ("P" Suffix designates RoHS Compliant. See ordering information)

Maximum Ratings

Symbol	Rating	Rating	Unit
V_{CEO}	Collector-Emitter Voltage 2N2907 2N2907A	40 60	V
V_{CBO}	Collector-Base Voltage	60	V
V_{EBO}	Emitter-Base Voltage	5.0	V
I_C	Collector Current (DC)	600	mA
I_{CM}	Peak Collector Current	800	mA
I_{BM}	Peak Base Current	200	mA
T_J	Operating Junction Temperature	-55 to +150	°C
T_{STG}	Storage Temperature	-55 to +150	°C

Thermal Characteristics

Symbol	Rating	Max	Unit
P_{tot}	Total power Dissipation $T_A \leq 25^\circ\text{C}$ $T_C \leq 25^\circ\text{C}$	400 1.2	mW W
R_{JC}	Thermal Resistance, Junction to Case	146	K/W
R_{JA}	Thermal Resistance, Junction to Ambient	350	K/W

Electrical Characteristics @ 25°C Unless Otherwise Specified

Symbol	Parameter	Min	Max	Units
--------	-----------	-----	-----	-------

OFF CHARACTERISTICS

I_{CBO}	Collector cut-off current ($V_{CB}=50\text{Vdc}$, $I_E=0$)	2N2907	---	20	nAdc
	($V_{CB}=50\text{Vdc}$, $I_E=0$, $T_A=150^\circ\text{C}$)	2N2907	---	20	μAdc
	($V_{CB}=50\text{Vdc}$, $I_E=0$)	2N2907A	---	10	nAdc
	($V_{CB}=50\text{Vdc}$, $I_E=0$, $T_A=150^\circ\text{C}$)	2N2907A	---	10	μAdc
I_{EBO}	Emitter Cut-off current ($I_C=0$, $V_{EB}=5.0\text{Vdc}$)	---	50	nAdc	
h_{FE}	DC Current Gain ($I_C=0.1\text{mA}$, $V_{CE}=10\text{Vdc}$)	2N2907	35	300	
	($I_C=1.0\text{mA}$, $V_{CE}=10\text{Vdc}$)	2N2907	50		
	($I_C=10\text{mA}$, $V_{CE}=10\text{Vdc}$)	2N2907	75		
	($I_C=150\text{mA}$, $V_{CE}=10\text{Vdc}$)*	2N2907	100		
	($I_C=500\text{mA}$, $V_{CE}=10\text{Vdc}$)*	2N2907	30		
h_{FE}	DC Current Gain ($I_C=0.1\text{mA}$, $V_{CE}=10\text{Vdc}$)	2N2907A	75	300	
	($I_C=1.0\text{mA}$, $V_{CE}=10\text{Vdc}$)	2N2907A	100		
	($I_C=10\text{mA}$, $V_{CE}=10\text{Vdc}$)	2N2907A	100		
	($I_C=150\text{mA}$, $V_{CE}=10\text{Vdc}$)*	2N2907A	100		
	($I_C=500\text{mA}$, $V_{CE}=10\text{Vdc}$)*	2N2907A	50		

Notes:1.High Temperature Solder Exemption Applied, see EU Directive Annex 7.

PNP Switching Transistors

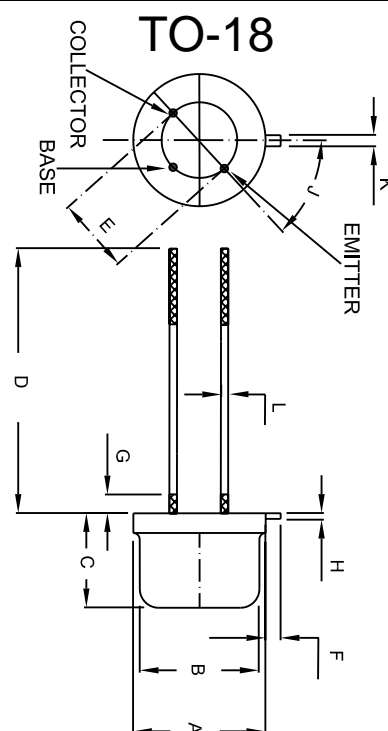

DIM	INCHES		MM		NOTE
	MIN	MAX	MIN	MAX	
A	.209	.230	5.309	5.842	Φ
B	.178	.195	4.521	4.953	Φ
C	.170	.210	4.318	5.334	
D	.50	.75	12.7	19.05	
E	.100		2.54		ΦTYP
F	.028	.048	7.112	1.219	
G	-----	.050	-----	1.27	
H	.009	.031	0.229	0.787	
J	44°	46°	44°	46°	
K	.036	.046	0.914	1.168	
L	.016	.021	0.406	0.533	

www.mccsemi.com

2N2907,2N2907A

Symbol	Parameter	Min	Max	Units
ON CHARACTERISTICS*				
$V_{CE(sat)}$	Collector-Emitter Saturation Voltage* ($I_C=150mA$, $I_B=15mA$) ($I_C=500mA$, $I_B=50mA$)	---	400 1.6	mVdc Vdc
$V_{BE(sat)}$	Base-Emitter Saturation Voltage * ($I_C=150mA$, $I_B=15mA$) ($I_C=500mA$, $I_B=50mA$)	---	1.3 2.6	Vdc Vdc
SMALL-SIGNAL CHARACTERISTICS				
C_{OB}	Output Capacitance ($V_{CB}=10Vdc$, $I_E=0$, $f=1.0MHz$)	---	8.0	pF
f_T	Transistor Frequency* ($I_C=50mA$, $V_{CE}=20Vdc$, $f=100MHz$)	200	---	MHz
SWITCHING CHARACTERISTICS				
T_d	Delay Time	---	15	ns
t_r	Rise Time	---	35	ns
t_s	Storage Time	---	250	ns
t_f	Fall Time	---	50	ns

* Pulse Test: $t_p \leq 300\mu s$, Duty Cycle $\leq 2.0\%$

Ordering Information :

Device	Packing
Part Number-BP	Bulk; 100pcs/Box

IMPORTANT NOTICE

Micro Commercial Components Corp. reserves the right to make changes without further notice to any product herein to make corrections, modifications , enhancements , improvements , or other changes . **Micro Commercial Components Corp .** does not assume any liability arising out of the application or use of any product described herein; neither does it convey any license under its patent rights ,nor the rights of others . The user of products in such applications shall assume all risks of such use and will agree to hold **Micro Commercial Components Corp .** and all the companies whose products are represented on our website, harmless against all damages.

LIFE SUPPORT

MCC's products are not authorized for use as critical components in life support devices or systems without the express written approval of Micro Commercial Components Corporation.

CUSTOMER AWARENESS

Counterfeiting of semiconductor parts is a growing problem in the industry. Micro Commercial Components (MCC) is taking strong measures to protect ourselves and our customers from the proliferation of counterfeit parts. MCC strongly encourages customers to purchase MCC parts either directly from MCC or from Authorized MCC Distributors who are listed by country on our web page cited below. Products customers buy either from MCC directly or from Authorized MCC Distributors are genuine parts, have full traceability, meet MCC's quality standards for handling and storage. **MCC will not provide any warranty coverage or other assistance for parts bought from Unauthorized Sources.** MCC is committed to combat this global problem and encourage our customers to do their part in stopping this practice by buying direct or from authorized distributors.

Mouser Electronics

Authorized Distributor

Click to View Pricing, Inventory, Delivery & Lifecycle Information:

[Micro Commercial Components \(MCC\):](#)

[2N2907-BP](#) [2N2907A-BP](#)