

**Mallory Sonalert Products, Inc.**

Part #:

MSE14LWH1**Sales Outline Drawing**

Revision:

B**Specifications:**

| | |
|-----------------------|--|
| Sound Level Category | Loud |
| Mode of Operation | Whooping Sweep 2.1 - 5.8 kHz @ 5 Sweeps per Sec. |
| Voltage Rating | 7 to 14 VDC |
| Frequency | 2100-5800 Hz Typical |
| Loudness @ 1 FT | 85 to 95 dB(A) Typ. |
| Current Draw | 50mA MAX |
| Housing Material | Valox (UL94V-0), Color: Black |
| Storage Temperature | -40° to +80° C |
| Operating Temperature | -40° to +65° C |
| Weight (Typical) | 4.0g |
| Options | Please contact factory. |

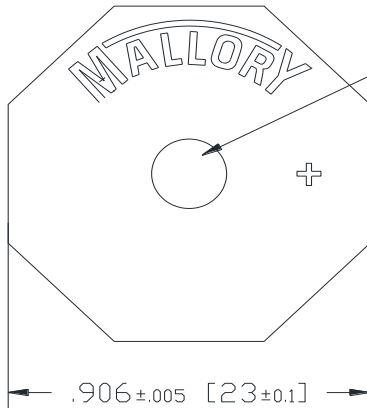
Dimensions: Inches (mm)**ROHS Compliant**

EMISSION HOLE

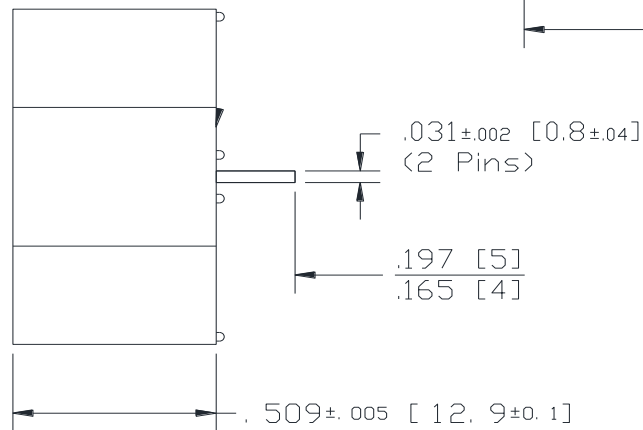
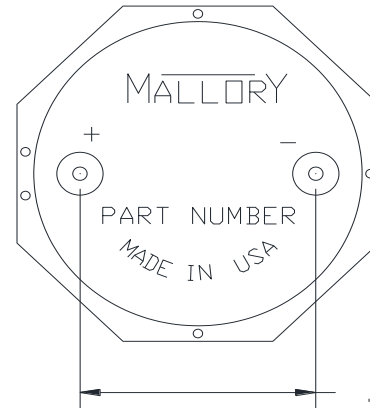

NOTE A:
TERMINALS - .031" DIA. NICKEL/TIN COATED BRASS.

NOTE B:
MOUNTING- INSERT INTO PRINTED CIRCUIT BOARD AND HAND OR MACHINE SOLDER.
UNITS ARE SUITABLE FOR WAVE SOLDERING. RECOMMENDED MAXIMUM TEMPERATURE
AND TIME DURATION FOR WAVE SOLDERING IS +270°C AND 3 SECONDS RESPECTIVELY.

Mouser Electronics

Authorized Distributor

Click to View Pricing, Inventory, Delivery & Lifecycle Information:

[Mallory Sonalert:](#)

[MSE14LWH1](#)