

UNCONTROLLED DOCUMENT

PART NUMBER
SML-LX2723SIC-TRREV.
A

| REV. | E.C.N. NUMBER AND REVISION COMMENTS | DATE |
|------|-------------------------------------|----------|
| A | E.C.N. #11459. | 12.07.07 |

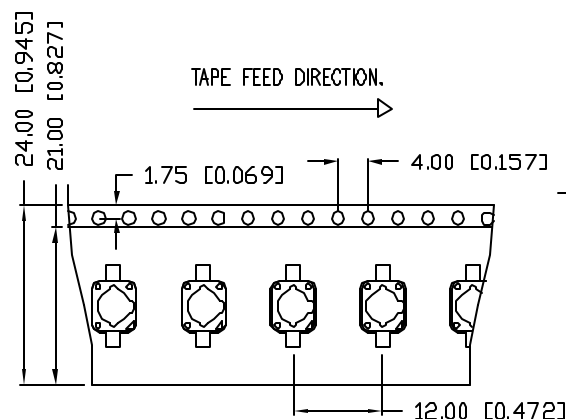
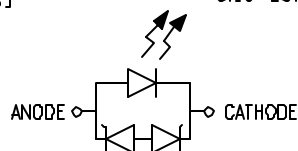
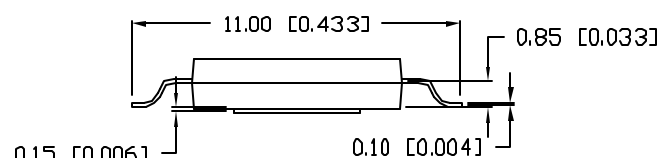
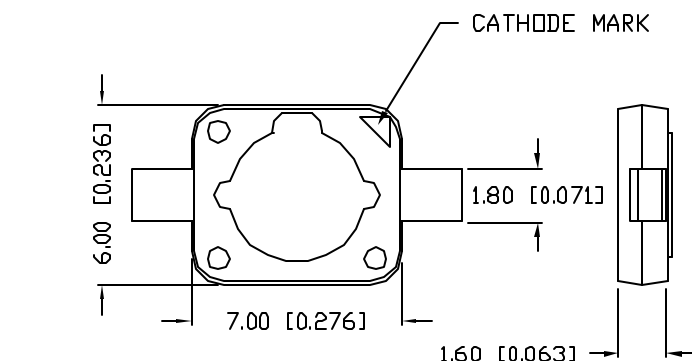

TAPE FEED DIRECTION.

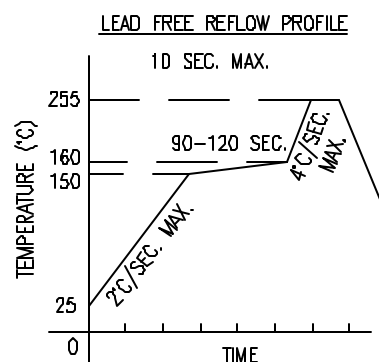

TOTAL TIME ABOVE 220°C IS 60 SECONDS MAX.

NOTE:

250 PECES PER REEL

ELECTRO-OPTICAL CHARACTERISTICS $T_A=25^\circ\text{C}$

| PARAMETER | SYMBOL | MIN | TYP | MAX | UNITS | TEST COND |
|--------------------|--------|-----|-------|-----|----------|---------------------|
| PEAK WAVELENGTH | | | 630 | | nm | |
| FORWARD VOLTAGE | V_f | | 2.0 | 2.9 | V | $I_f=350\text{mA}$ |
| REVERSE VOLTAGE | V_r | 5 | | | V | $I_r=10\mu\text{A}$ |
| AXIAL INTENSITY | I_v | 23 | | 39 | lm | $I_f=350\text{mA}$ |
| VIEWING ANGLE | | | 120 | | 2x theta | |
| EMITTED COLOR: | | | RED | | | |
| EPOXY LENS FINISH: | | | CLEAR | | | |

LIMITS OF SAFE OPERATION AT 25°C

| PARAMETER | MAX | UNITS |
|--------------------------|------------|-------|
| PEAK FORWARD CURRENT* | 500 | mA |
| STEADY CURRENT | 350 | mA |
| POWER DISSIPATION | 1.5 | W |
| DERATE FROM 25°C | -1.2 | mW/°C |
| OPERATING, STORAGE TEMP. | -40 TO +85 | °C |

* $T < 10\mu\text{s}$

RECOMMENDED SOLDER PAD

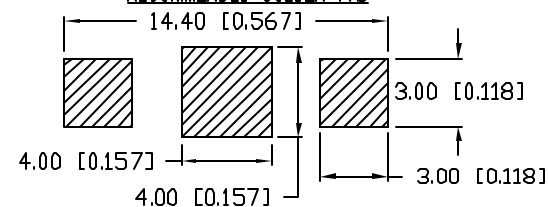

*UNLESS OTHERWISE SPECIFIED TOLERANCES PER DECIMAL PRECISION ARE: X=±1 (±0.039), XX=±0.5 (±0.020), XXX=±0.25 (±0.010), XXXX=±0.127 (±0.005). LEAD SIZE=±0.05 (±0.002), LEAD LENGTH=±0.75 (±0.030). MIN.=+DECIMAL PRECISION -0.00 MAX.=+0.00 -DECIMAL PRECISION

REV.
APART NUMBER
SML-LX2723SIC-TR7mm X 6mm SURFACE MOUNT HIGH POWER LED,
630nm SUPER RED, TAPE AND REEL.

CONFIDENTIAL INFORMATION

THE INFORMATION CONTAINED IN THIS DOCUMENT IS THE PROPERTY OF LUMEX INC. EXCEPT AS SPECIFICALLY AUTHORIZED IN WRITING BY LUMEX INC., THE HOLDER OF THIS DOCUMENT SHALL KEEP ALL INFORMATION CONTAINED HEREIN CONFIDENTIAL AND SHALL PROTECT SAME IN WHOLE OR IN PART FROM DISCLOSURE AND DISSEMINATION TO ALL THIRD PARTIES.

RELIABILITY NOTE

OUR MANY YEARS OF EXPERIENCE DATA ACCUMULATION INDICATE THAT SOLDER HEAT IS A MAJOR CAUSE OF EARLY AND FUTURE FAILURE. PLEASE PAY ATTENTION TO YOUR SOLDERING PROCESS.



290 E. HELEN ROAD
PALATINE, IL 60067-6976
PHONE: +1.847.359.2790
US WEB: www.lumex.com
TW WEB: www.lumex.com.tw

DRAWN BY:

CHECKED BY:

APPROVED BY:

DATE: 9.04.07

PAGE: 1 OF 1

SCALE: N/A

JN

Mouser Electronics

Authorized Distributor

Click to View Pricing, Inventory, Delivery & Lifecycle Information:

Lumex:

[SML-LX2723SIC-TR](#)