

UNCONTROLLED DOCUMENT

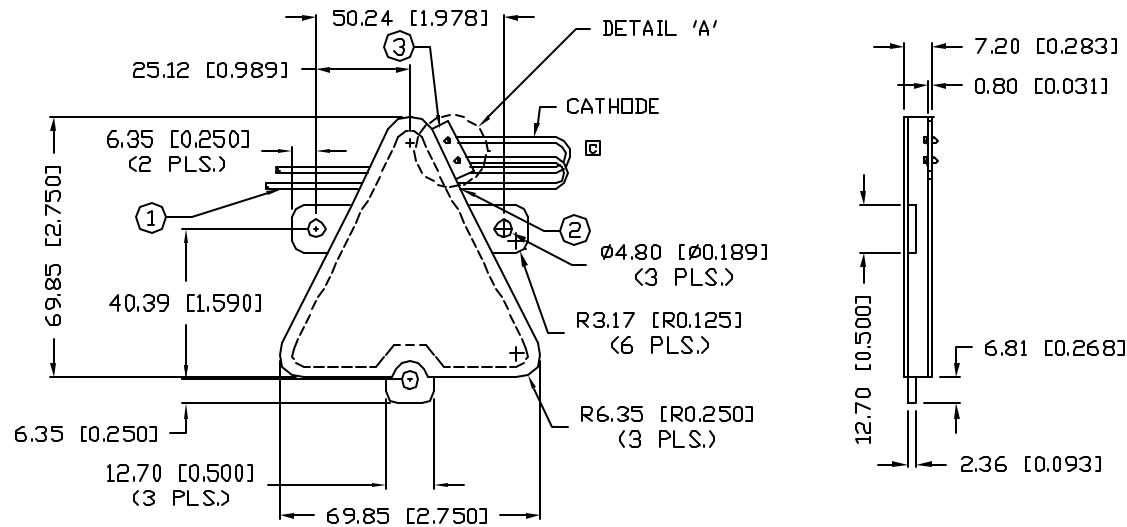

6 IN PARALLEL,
8 IN SERIES,
WITH 51 OHM RESISTOR.

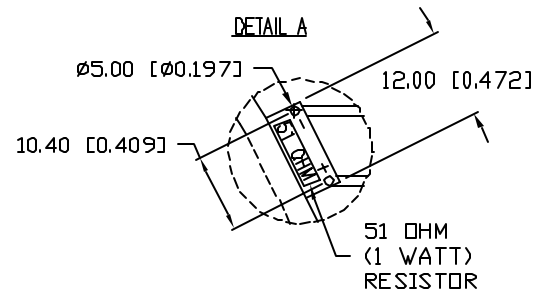
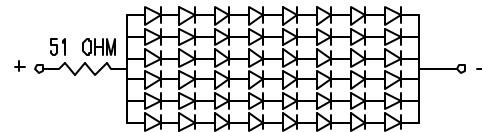

PART NUMBER
SSB-COB6370GW-T-6

REV.
C

REV.	E.C.N. NUMBER AND REVISION COMMENTS	DATE
A	E.C.N. #10408.	1.12.98
B	E.C.N. #10BRDR. & REDRAWN.	1.27.99
C	E.C.N. #10BRDR. & 10842.	3.15.02

ELECTRO-OPTICAL CHARACTERISTICS $T_A=25^\circ\text{C}$ PER MODULE

PARAMETER	MIN	TYP	MAX	UNITS	TEST COND
PEAK WAVELENGTH		565 (GREEN)		nm	
FORWARD VOLTAGE		24		V_f	
REVERSE VOLTAGE	48			V_r	$V_r=200\mu\text{A}$
LUMINOUS INTENSITY		365		cd/m^2	$I_f=100\text{mA}$
EMITTED COLOR:		GREEN			
REFLECTOR FINISH:		MILKY WHITE			

LIMITS OF SAFE OPERATION AT 25°C PER MODULE

PARAMETER	MAX	UNITS
PEAK FORWARD CURRENT*	150	mA
STEADY CURRENT	120	mA
POWER DISSIPATION	3.6	W
DERATE FROM 25°C	67.4	mW/ $^\circ\text{C}$
OPERATING TEMP.	-40 TO +85	$^\circ\text{C}$
STORAGE TEMP.	-40 TO +85	$^\circ\text{C}$
SOLDERING TEMP.	+260	$^\circ\text{C}$
2.0mm FROM BODY		3 SEC. MAX

* $t < 10\mu\text{s}$

NOTES:

- BUNDLE WIRE.
- GLUE WIRES TO BACK OF PART
- COLOR MARK.

UNCONTROLLED DOCUMENT

*UNLESS OTHERWISE SPECIFIED TOLERANCES PER DECIMAL PRECISION ARE: $X=\pm 1$ (± 0.038), $XX=\pm 0.5$ (± 0.020), $XXX=\pm 0.25$ (± 0.010), $XXXX=\pm 0.127$ (± 0.005). LEAD SIZE= ± 0.05 (± 0.002), LEAD LENGTH= ± 0.75 (± 0.030). MIN= +DECIMAL PRECISION MAX= +0.00 -DECIMAL PRECISION

REV.
C

PART NUMBER
SSB-COB6370GW-T-6

TRIANGULAR BACKLIGHT DISPLAY, 48 CHIPS ON BOARD,
565nm GREEN, 24 VOLT.

CONFIDENTIAL INFORMATION
THE INFORMATION CONTAINED IN THIS DOCUMENT IS THE PROPERTY OF LUMEX INC. EXCEPT AS SPECIFICALLY AUTHORIZED IN WRITING BY LUMEX INC., THE HOLDER OF THIS DOCUMENT SHALL KEEP ALL INFORMATION CONTAINED HEREIN CONFIDENTIAL AND SHALL PROTECT SAME IN WHOLE OR IN PART FROM DISCLOSURE AND DISSEMINATION TO ALL THIRD PARTIES.

RELIABILITY NOTE
OUR MANY YEARS OF EXPERIENCE DATA ACCUMULATION INDICATE THAT SOLDER HEAT IS A MAJOR CAUSE OF EARLY AND FUTURE FAILURE. PLEASE PAY ATTENTION TO YOUR SOLDERING PROCESS.



290 E. HELEN ROAD
PALATINE, IL 60067-6976
PHONE: +1.847.359.2790
US WEB: www.lumex.com
TW WEB: www.lumex.com.tw

DRAWN BY: SS/CT	CHECKED BY:	APPROVED BY:	DATE: 6.8.97 PAGE: 1 OF 1 SCALE: N/A
--------------------	-------------	--------------	--

Mouser Electronics

Authorized Distributor

Click to View Pricing, Inventory, Delivery & Lifecycle Information:

Lumex:

[SSB-COB6370GW-T-6](#)