

SSF-H1350XX-L Series

ESD Safe, 3mm, Single Level

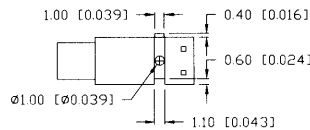
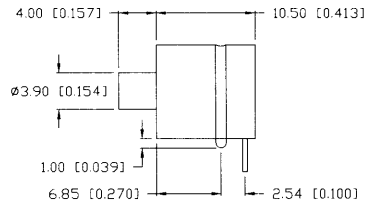
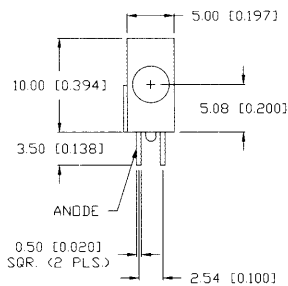

FEATURES / OPTIONS

- State-of-the-Art, High Brightness Chip Technology
- Easy Drop-In Board Installation
- Right Angle to the Board Position
- Choice of Colors and Lens Finishes
- Low Current Versions Available
- Color or Intensity Sorting Available
- ESD Safety by using External Lens
- Blinking LED
- With Internal Resistor for 5V and 12V Operation

APPLICATIONS / USES

- Board Level Status Indicators
- Board Level Fault Indicators
- Circuit Troubleshooting Indicators
- Warning/Alarm Lights
- Backlighting of Overlays
- Post Lighting Switches and Keypads

| Lumex Part Number | Dice Material | Emitted Color | Peak (nm) | Epoxy Lens | Operating Current (mA) | Operating TYP. Vf (V) | Brightness | | View Angle° 2x THETA | Component LED Used |
|-------------------|---------------|--------------------------|-----------|-----------------|------------------------|-----------------------|------------|------|----------------------|--------------------|
| | | | | | | | TYP. mcd | @ mA | | |
| HIGH BRIGHTNESS | | | | | | | | | | |
| SSF-H1350SID-L | AlInGaP | Super High Intensity Red | 636 | Red Diffused | 5-25 | 2.0 | 100 | 20 | 60 | SSL-LX3054SID |
| SSF-H1350SOD-L | AlInGaP | Super Orange | 610 | Orange Diffused | 5-25 | 2.0 | 100 | 20 | 60 | SSL-LX3054SOD |
| SSF-H1350SPGD-L | AlInGaP | Super Pure Green | 562 | Green Diffused | 5-25 | 2.2 | 60 | 20 | 60 | SSL-LX3054SPGD |
| SSF-H1350SYD-L | AlInGaP | Super Yellow | 590 | Yellow Diffused | 5-25 | 2.0 | 100 | 20 | 60 | SSL-LX3054SYD |
| SSF-H1350USB-L | InGaN/SiC | Ultra Super Blue | 470 | Blue Diffused | 5-25 | 3.5 | 80 | 20 | 60 | SSL-LX3054USB |

SSF-H2330XX-L Series

ESD Safe, 3mm, Dual Level

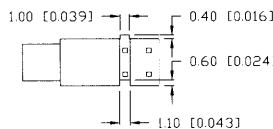
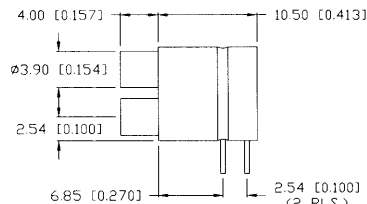
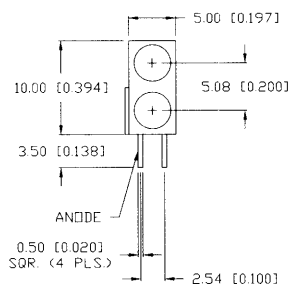

FEATURES / OPTIONS

- State-of-the-Art, High Brightness Chip Technology
- Easy Drop-In Board Installation
- Right Angle to the Board Position
- Choice of Colors and Lens Finishes
- Low Current Versions Available
- Color or Intensity Sorting Available
- ESD Safety by using External Lens
- Blinking LED
- With Internal Resistor for 5V and 12V Operation
- Color Combinations

APPLICATIONS / USES

- Board Level Status Indicators
- Board Level Fault Indicators
- Circuit Troubleshooting Indicators
- Warning/Alarm Lights
- Backlighting of Overlays
- Post Lighting Switches and Keypads

| Lumex Part Number | Dice Material | Emitted Color | Peak (nm) | Epoxy Lens | Operating Current (mA) | Operating TYP. VI (V) | Brightness | | View Angle° 2x THETA | Component LED Used |
|-------------------|---------------|--------------------------|-----------|-----------------|------------------------|-----------------------|------------|------|-------------------------|--------------------|
| | | | | | | | TYP. mcd | @ mA | | |
| HIGH BRIGHTNESS | | | | | | | | | | |
| SSF-H2330SID-L | AlInGaP | Super High Intensity Red | 636 | Red Diffused | 5-25 | 2.0 | 100 | 20 | 60 | SSL-LX3054SID |
| SSF-H2330SOD-L | AlInGaP | Super Orange | 610 | Orange Diffused | 5-25 | 2.0 | 100 | 20 | 60 | SSL-LX3054SOD |
| SSF-H2330SPGD-L | AlInGaP | Super Pure Green | 562 | Green Diffused | 5-25 | 2.2 | 60 | 20 | 60 | SSL-LX3054SPGD |
| SSF-H2330SYD-L | AlInGaP | Super Yellow | 590 | Yellow Diffused | 5-25 | 2.0 | 100 | 20 | 60 | SSL-LX3054SYD |
| SSF-H2330USB-L | InGaN/SiC | Ultra Super Blue | 470 | Blue Diffused | 5-25 | 3.5 | 80 | 20 | 60 | SSL-LX3054USB |



1-800-278-5666 USA
+886-3-5821124 Asian Pacific



www.lumex.com
www.lumex.com.tw



1-800-944-2790 USA
+886-3-5821154 Asian Pacific

Mouser Electronics

Authorized Distributor

Click to View Pricing, Inventory, Delivery & Lifecycle Information:

Lumex:

[SSF-H1350USB-D-L](#)