

PART NUMBER
OED-ST-392T-TL

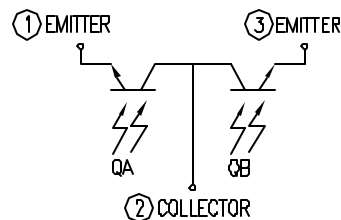
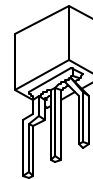
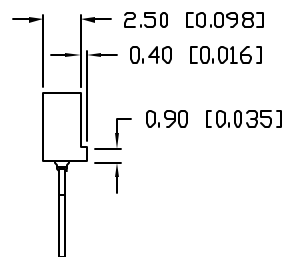

PARAMETER	SYMBOL	TEST CONDITION	MIN	TYP	MAX	UNIT
COLLECTOR DARK CURRENT	I_{CEO}	$V_{CE} = 10V$ $E_e = 0.5mW/cm^2$			100	nA
COLLECTOR LIGHT CURRENT	I_C	$V_{CE} = 10V$ $E_e = 0.5mW/cm^2$	0.5			mA
COLLECTOR-EMITTER SATURATION VOLTAGE	$V_{CE(sat)}$	$I_C = 0.4mA$ $E_e = 0.5mW/cm^2$		0.3	0.4	V
SWITCHING SPEEDS:		$V_{CC} = 5V$				
RISING TIME	T_r	$I_C = 1mA$		15		μS
FALLING TIME	T_f	$R_L = 1000\Omega$		15		μS
PEAK WAVELENGTH	λ_p			800		nm
ANGULAR RESPONSE	$\Delta\theta$			± 60		DEG
LENS COLOR:	BLACK					

PARAMETER	MAX	UNITS
COLLECTOR-EMITTER VOLTAGE	30	V
EMITTER-COLLECTOR VOLTAGE	5	V
POWER DISSIPATION	75	mW
OPERATING TEMP.	-20 TO +70	°C
STORAGE TEMP.	-25 TO +80	°C
SOLDERING TEMP.	+260	°C
2.0mm FROM BODY		3 SEC. MAX

*UNLESS OTHERWISE SPECIFIED TOLERANCES PER DECIMAL PRECISION ARE: X=±1 (±0.039), X.X=±0.5 (±0.020), X.XX=±0.25 (±0.010), X.XXX=±0.127 (±0.005). LEAD SIZE=±0.05 (±0.002), LEAD LENGTH=±0.75 (±0.030). MIN=+DECIMAL PRECISION
-0.00 MAX.=+ODD
-DECIMAL PRECISION

PART NUMBER
OED-ST-392T-TL

CONFIDENTIAL INFORMATION

THE INFORMATION CONTAINED IN THIS DOCUMENT IS THE PROPERTY OF LUMEX INC. EXCEPT AS SPECIFICALLY AUTHORIZED IN WRITING BY LUMEX INC. THE HOLDER OF THIS DOCUMENT SHALL KEEP ALL INFORMATION CONTAINED HEREIN CONFIDENTIAL AND SHALL PROTECT SAME IN WHOLE OR IN PART FROM DISCLOSURE AND DISSEMINATION TO ALL THIRD PARTIES.

DATE: _____
PAGE: 1 OF 1
SCALE: N/A

GB

Mouser Electronics

Authorized Distributor

Click to View Pricing, Inventory, Delivery & Lifecycle Information:

Lumex:

[OED-ST-392T-TL](#)