

UNCONTROLLED DOCUMENT

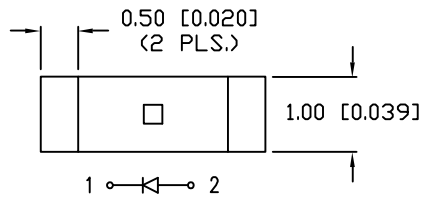

CAUTION: STATIC SENSITIVE DEVICE  
FOLLOW PROPER E.S.D. HANDLING PROCEDURES  
WHEN WORKING WITH THIS PART.

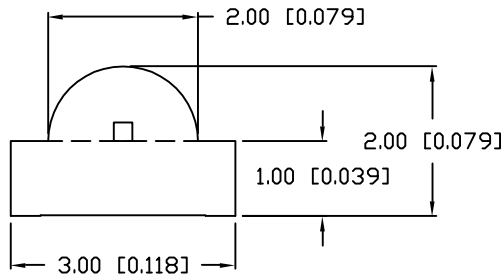
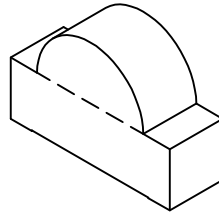

**LEAD FREE REFLOW PROFILE**

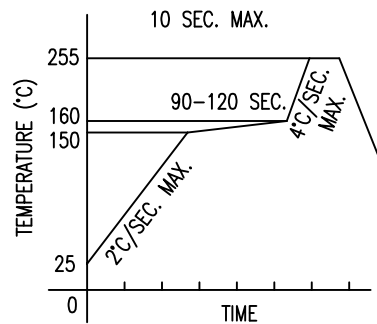

TOTAL TIME ABOVE 220°C IS 60 SECONDS MAX.

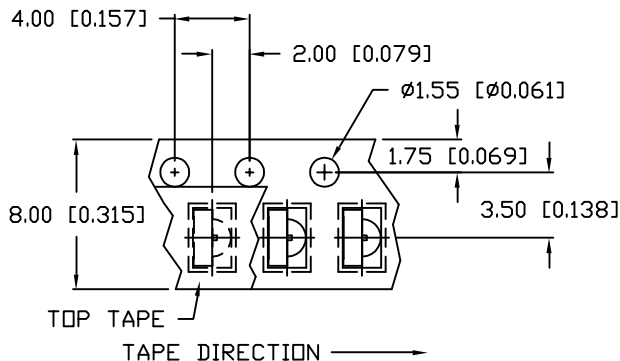
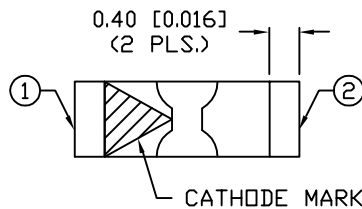

**RECOMMENDED PAD LAYOUT**

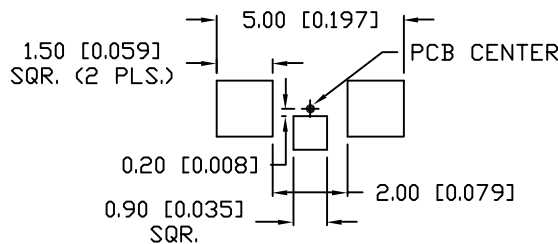

**ELECTRO-OPTICAL CHARACTERISTICS**  $T_A=25^\circ\text{C}$   $I_f=20\text{mA}$

| PARAMETER          | MIN              | TYP | MAX | UNITS    | TEST COND            |
|--------------------|------------------|-----|-----|----------|----------------------|
| PEAK WAVELENGTH    |                  | 470 |     | nm       |                      |
| FORWARD VOLTAGE    |                  | 3.5 | 4.0 | $V_f$    |                      |
| REVERSE VOLTAGE    | 5.0              |     |     | $V_r$    | $I_f=100\mu\text{A}$ |
| AXIAL INTENSITY    |                  | 30  |     | mcd      | $I_f=20\text{mA}$    |
| VIEWING ANGLE      |                  | 160 |     | 2x theta |                      |
| EMITTED COLOR:     | ULTRA SUPER BLUE |     |     |          |                      |
| EPOXY LENS FINISH: | WATER CLEAR      |     |     |          |                      |

\*  $t < 10\mu\text{s}$

CAUTION: MOISTURE SENSITIVE DEVICE  
PER JEDEC LEVEL 4 STANDARDS

**NOTES:**

- 2,000 PER REEL.
- THE CATHODE IS ORIENTED TOWARDS THE TAPE SPROCKET HOLE.

UNCONTROLLED DOCUMENT

\*UNLESS OTHERWISE SPECIFIED TOLERANCES PER DECIMAL PRECISION ARE: X=±1 (±0.039), X.X=±0.5 (±0.020), X.XX=±0.25 (±0.010), X.XXX=±0.127 (±0.005). LEAD SIZE=±0.05 (0.002), LEAD LENGTH=±0.75 (±0.030). MIN= +DECIMAL PRECISION -0.00 MAX= +0.00 -DECIMAL PRECISION

REV. B PART NUMBER SML-LXR851USBC-TR

1.0mm x 3.0mm PCB RIGHT ANGLE SURFACE MOUNT LED,  
470nm SUPER BLUE, WATER CLEAR LENS, 2K PER REEL.

**CONFIDENTIAL INFORMATION**  
THE INFORMATION CONTAINED IN THIS DOCUMENT IS THE PROPERTY OF LUMEX INC. EXCEPT AS SPECIFICALLY AUTHORIZED IN WRITING BY LUMEX INC., THE HOLDER OF THIS DOCUMENT SHALL KEEP ALL INFORMATION CONTAINED HEREIN CONFIDENTIAL AND SHALL PROTECT SAME IN WHOLE OR IN PART FROM DISCLOSURE AND DISSEMINATION TO ALL THIRD PARTIES.

**RELIABILITY NOTE**  
OUR MANY YEARS OF EXPERIENCE DATA ACCUMULATION INDICATE THAT SOLDER HEAT IS A MAJOR CAUSE OF EARLY AND FUTURE FAILURE. PLEASE PAY ATTENTION TO YOUR SOLDERING PROCESS.



290 E. HELEN ROAD  
PALATINE, IL 60067-6976  
PHONE: +1.847.359.2790  
US WEB: www.lumex.com  
TW WEB: www.lumex.com.tw

DRAWN BY: BC CHECKED BY: APPROVED BY: DATE: 1.9.01  
PAGE: 1 OF 1  
SCALE: N/A

# Mouser Electronics

Authorized Distributor

Click to View Pricing, Inventory, Delivery & Lifecycle Information:

Lumex:

[SML-LXR851USBC-TR](#)