

UNCONTROLLED DOCUMENT

PART NUMBER
OED-ST-44FREV.
D

| REV. | E.C.N. NUMBER AND REVISION COMMENTS | DATE |
|------|-------------------------------------|----------|
| A | E.C.N. #10BRDR. & REDRAWN. | 1.5.95 |
| B | E.C.N. #10434. | 6.3.98 |
| C | E.C.N. #10936. & #10BRDR | 12.11.02 |
| D | E.C.N. #E11062 | 12.3.03 |

ELECTRO-OPTICAL CHARACTERISTICS $T_A=25^\circ\text{C}$ $I_f=20\text{mA}$

| PARAMETER | MIN | TYP | MAX | UNITS | TEST COND |
|--------------------------------------|-----|-----|-----|---------------|---|
| □ COLLECTOR DARK CURRENT | | | 400 | nA | $V_{ce} = 10\text{V}$ $E_e = 0 \text{ mw/cm}^2$ |
| COLLECTOR LIGHT CURRENT | | 3.0 | | mA | $V_{ce} = 5\text{V}$ $E_v=1000\text{LUX}$ |
| COLLECTOR-EMITTER SATURATION VOLTAGE | | | 0.3 | V | $I_c=1\text{mA}$ $E_v=1000\text{LUX}$ |
| □ □ SWITCHING SPEEDS: | | | | | $V_{ce}=5\text{V}$ $I_c=1\text{mA}$ $R_I = 1000 \Omega$ |
| RISING TIME | | 10 | | μS | |
| FALLING TIME | | 10 | | μS | |
| PEAK WAVELENGTH SENSITIVITY | | 850 | | nm | |
| LENS COLOR: WATER CLEAR | | | | | |

LIMITS OF SAFE OPERATION AT 25°C

| PARAMETER | MAX | UNITS |
|---|-------------|------------------|
| COLLECTOR-EMITTER VOLTAGE (V_{ce0}) | 70 | V |
| EMITTER-COLLECTOR VOLTAGE (V_{ce0}) | 5 | mA |
| COLLECTOR CURRENT | 100 | mA |
| POWER DISSIPATION | 200 | mW |
| OPERATING TEMP. | -25 TO +85 | $^\circ\text{C}$ |
| STORAGE TEMP. | -25 TO +120 | $^\circ\text{C}$ |

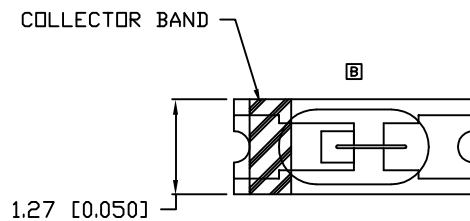
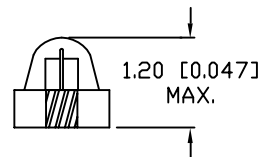
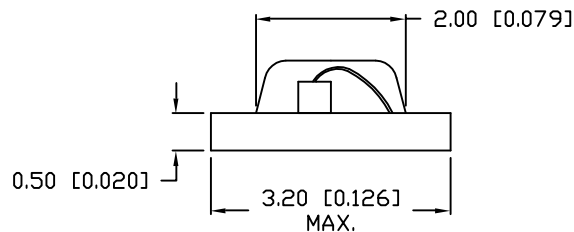

RECOMMENDED SOLDER PAD LAYOUT

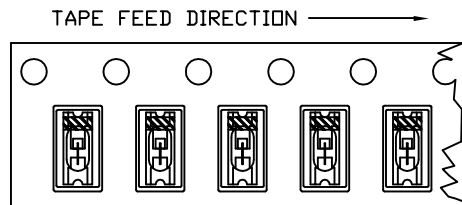
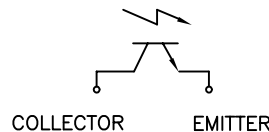
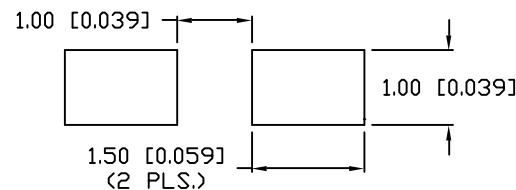

*UNLESS OTHERWISE SPECIFIED TOLERANCES PER DECIMAL PRECISION ARE: X=±1 (±0.039), X.X=±0.5 (±0.020), X.XX=±0.25 (±0.010), X.XXX=±0.127 (±0.005). LEAD SIZE=±0.05 (0.002), LEAD LENGTH=±0.75 (±0.030). MIN= +DECIMAL PRECISION -0.00 MAX= +0.00 -DECIMAL PRECISION

REV.
DPART NUMBER
OED-ST-44FCERAMIC CHIP, SURFACE MOUNT PHOTOTRANSISTOR,
WATER CLEAR LENS, TAPE AND REEL.

CONFIDENTIAL INFORMATION
THE INFORMATION CONTAINED IN THIS DOCUMENT IS THE PROPERTY OF LUMEX INC. EXCEPT AS SPECIFICALLY AUTHORIZED IN WRITING BY LUMEX INC., THE HOLDER OF THIS DOCUMENT SHALL KEEP ALL INFORMATION CONTAINED HEREIN CONFIDENTIAL AND SHALL PROTECT SAME IN WHOLE OR IN PART FROM DISCLOSURE AND DISSEMINATION TO ALL THIRD PARTIES.

RELIABILITY NOTE
OUR MANY YEARS OF EXPERIENCE DATA ACCUMULATION INDICATE THAT SOLDER HEAT IS A MAJOR CAUSE OF EARLY AND FUTURE FAILURE. PLEASE PAY ATTENTION TO YOUR SOLDERING PROCESS.



290 E. HELEN ROAD
PALATINE, IL 60067-6976
PHONE: +1.847.359.2790
US WEB: www.lumex.com
TW WEB: www.lumex.com.tw

□ □

| | | | |
|-----------------|-------------|--------------|--|
| DRAWN BY: CT | CHECKED BY: | APPROVED BY: | DATE: 12.11.02 PAGE: 1 OF 1 SCALE: N/A |
|-----------------|-------------|--------------|--|

UNCONTROLLED DOCUMENT

Mouser Electronics

Authorized Distributor

Click to View Pricing, Inventory, Delivery & Lifecycle Information:

Lumex:

OED-ST-44F