

SSL-LX3044xD Series

T-3mm Short Lens, Diffused

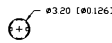
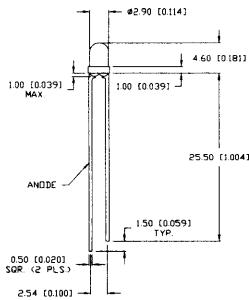

FEATURES / OPTIONS

- State-of-the-Art, High Brightness Chip Technology
- Choice of Colors and Lens Finishes
- Lead Frame / Epoxy Lens Casting Reliability
- Easy-to-Solder Leads, Tin Finish
- Available Bulk or on Tape and Reel
- Lead Trimming and Forming Available
- Custom Shapes/Easily Tooled/Low Minimum
- Blinking LED
- With Internal Resistor for 5V and 12V Operation

APPLICATIONS / USES

- Board or Panel Indication or Illumination
- Backlighting of Overlays and Graphics
- Annunciator and Control Panels
- Keyboards and Switches
- Telecom Switches and Central Station Equipment
- Signs, Warning Lights, Displays

Lumex Part Number	Dice Material	Emitted Color	Peak (nm)	Epoxy Lens	Operating Current (mA)	Operating TYP. Vf (V)	Brightness		View Angle° 2x THETA
			TYP. mcd				@ mA		
HIGH BRIGHTNESS									
SSL-LX3044SID	AlInGaP	Super High Intensity Red	636	Red Diffused	5-25	2.0	100	20	60
SSL-LX3044SOD	AlInGaP	Super Orange	610	Orange Diffused	5-25	2.0	100	20	60
SSL-LX3044SPGD	AlInGaP	Super Pure Green	562	Green Diffused	5-25	2.2	60	20	60
SSL-LX3044SYD	AlInGaP	Super Yellow	590	Yellow Diffused	5-25	2.0	100	20	60
SSL-LX3044USBD	InGaN/SiC	Ultra Super Blue	470	Blue Diffused	5-25	3.5	80	20	60
STANDARD BRIGHTNESS									
SSL-LX3044AD	GaAsP	Amber	605	Amber Diffused	5-25	2.1	15	20	60
SSL-LX3044GD	GaP	Green	565	Green Diffused	5-25	2.1	40	20	60
SSL-LX3044HD	GaP	High Efficiency Red	700	Red Diffused	5-25	2.0	6	20	60
SSL-LX3044ID	GaAsP	High Intensity Red	635	Red Diffused	5-25	2.0	50	20	60
SSL-LX3044OD	GaP	Orange	630	Orange Diffused	5-25	2.0	30	20	60
SSL-LX3044PGD	GaP	Pure Green	555	Green Diffused	5-25	2.1	20	20	60
SSL-LX3044SGD	GaP	Super Green	565	Green Diffused	5-25	2.1	50	20	60
SSL-LX3044SRD	GaAlAs	Super Red	660	Red Diffused	5-25	1.8	80	20	60
SSL-LX3044YD	GaAsP	Yellow	585	Yellow Diffused	5-25	2.1	40	20	60

SSL-LX3044xC Series

T-3mm Short Lens, Clear

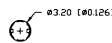
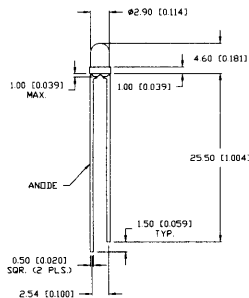

FEATURES / OPTIONS

- State-of-the-Art, High Brightness Chip Technology
- Choice of Colors and Lens Finishes
- Lead Frame / Epoxy Lens Casting Reliability
- Easy-to-Solder Leads, Tin Finish
- Available Bulk or on Tape and Reel
- Lead Trimming and Forming Available
- Custom Shapes/Easily Tooled/Low Minimum
- Blinking LED
- With Internal Resistor for 5V and 12V Operation

APPLICATIONS / USES

- Board or Panel Indication or Illumination
- Backlighting of Overlays and Graphics
- Annunciator and Control Panels
- Keyboards and Switches
- Telecom Switches and Central Station Equipment
- Signs, Warning Lights, Displays

Lumex Part Number	Dice Material	Emitted Color	Peak (nm)	Epoxy Lens	Operating Current (mA)	Operating TYP. Vf (V)	Brightness		View Angle° 2x THETA
							TYP. mcd	@ mA	
HIGH BRIGHTNESS									
SSL-LX3044SIC	AlInGaP	Super High Intensity Red	636	Water Clear	5-25	2.0	1800	20	30
SSL-LX3044SOC	AlInGaP	Super Orange	610	Water Clear	5-25	2.0	2500	20	30
SSL-LX3044SPGC	AlInGaP	Super Pure Green	562	Water Clear	5-25	2.2	1000	20	30
SSL-LX3044SYC	AlInGaP	Super Yellow	590	Water Clear	5-25	2.0	1000	20	30
SSL-LX3044USBC	InGaN/SiC	Ultra Super Blue	470	Water Clear	5-25	3.5	1000	20	30
SSL-LX3044UWC	GaN	Ultra White	-	Water Clear	5-25	3.5	800	20	30
STANDARD BRIGHTNESS									
SSL-LX3044AC	GaAsP	Amber	605	Water Clear	5-25	2.1	80	20	30
SSL-LX3044GC	GaP	Green	565	Water Clear	5-25	2.1	100	20	30
SSL-LX3044HC	GaP	High Efficiency Red	700	Water Clear	5-25	2.0	25	20	30
SSL-LX3044IC	GaAsP	High Intensity Red	635	Water Clear	5-25	2.0	130	20	30
SSL-LX3044OC	GaP	Orange	630	Water Clear	5-25	2.0	80	20	30
SSL-LX3044PGC	GaP	Pure Green	555	Water Clear	5-25	2.1	50	20	30
SSL-LX3044SGC	GaP	Super Green	565	Water Clear	5-25	2.1	300	20	30
SSL-LX3044SRC	GaAlAs	Super Red	660	Water Clear	5-25	1.8	500	20	30
SSL-LX3044YC	GaAsP	Yellow	585	Water Clear	5-25	2.1	140	20	30



1-800-278-5666 USA
+886-3-5821124 Asian Pacific



www.lumex.com
www.lumex.com.tw



1-800-944-2790 USA
+886-3-5821154 Asian Pacific

Mouser Electronics

Authorized Distributor

Click to View Pricing, Inventory, Delivery & Lifecycle Information:

Lumex:

[SSL-LX3044OD](#) [SSL-LX3044SRD](#)