

UNCONTROLLED DOCUMENT

PART NUMBER

LCM-H128128GCFN-15

REV.

A

REV. E.C.N. NUMBER AND REVISION COMMENTS

DATE

A E.C.N. #11148.

4.20.07

## NOTES:

1. CN1: FPC PITCH 0.50mm.  
RECOMMEND MOLEX CONNECTOR 54550-1890 OR EQUIVALENT.

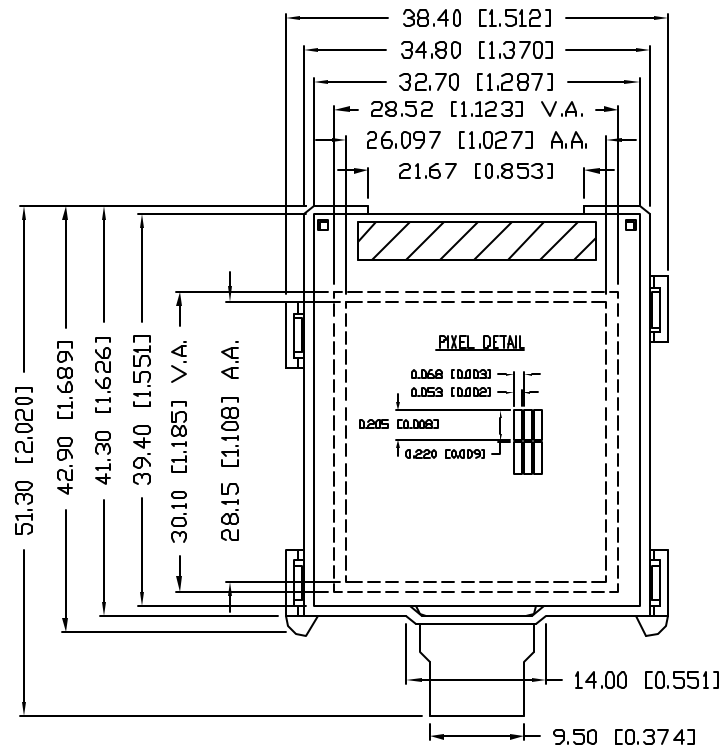
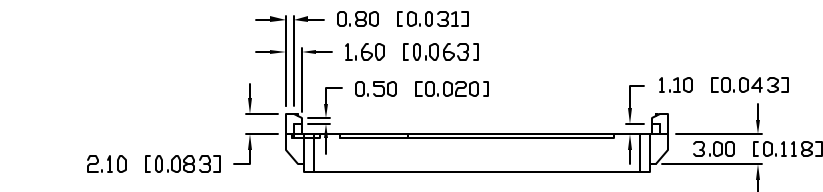
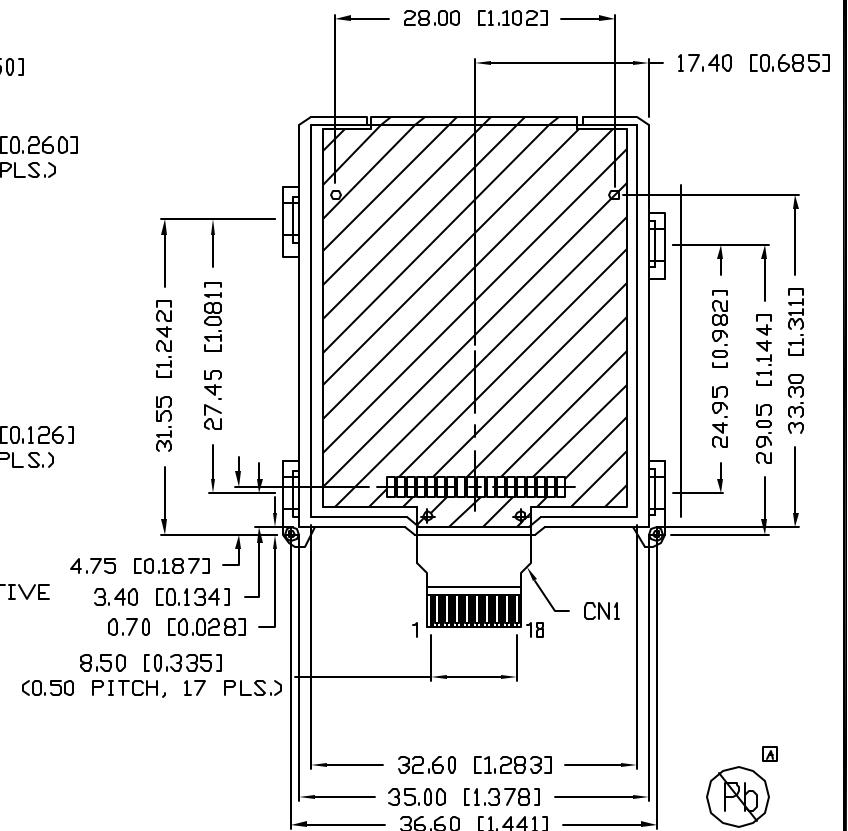
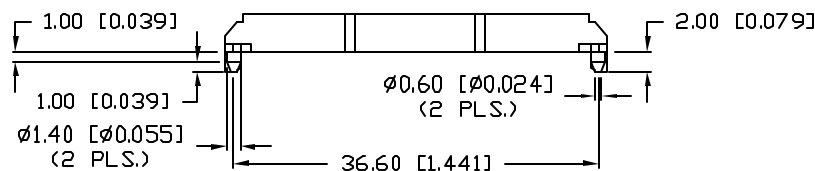
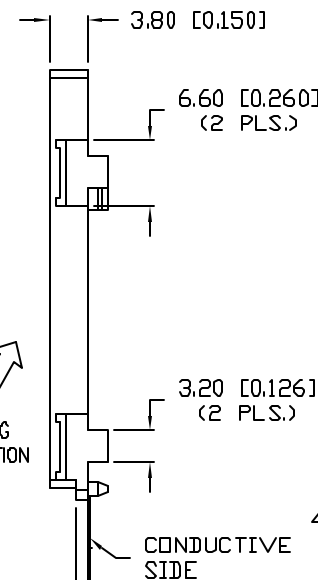
VIEWING  
DIRECTION

UNCONTROLLED DOCUMENT

\*UNLESS OTHERWISE SPECIFIED TOLERANCES PER DECIMAL PRECISION ARE: X=±1 (±0.039), X.X=±0.5 (±0.020), X.XX=±0.25 (±0.010), X.XXX=±0.127 (±0.005). LEAD SIZE=±0.05 (±0.002), LEAD LENGTH=±0.75 (±0.030). MIN.=<sup>+DECIMAL PRECISION</sup><sub>-0.00</sub> MAX.=<sup>+0.00</sup><sub>-DECIMAL PRECISION</sub>

REV.

A

PART NUMBER

LCM-H128128GCFN-15

1.5" 128 x 128 CSTN MODULE, TRANSFLECTIVE (NEGATIVE),  
WHITE LED BACKLIGHT, GLARE UPPER POLARIZER,  
1/132 DUTY, 6 O'CLOCK VIEW, WEIGHT: 7.6g.

## CONFIDENTIAL INFORMATION

THE INFORMATION CONTAINED IN THIS DOCUMENT IS THE PROPERTY OF LUMEX INC. EXCEPT AS SPECIFICALLY AUTHORIZED IN WRITING BY LUMEX INC, THE HOLDER OF THIS DOCUMENT SHALL KEEP ALL INFORMATION CONTAINED HEREIN CONFIDENTIAL AND SHALL PROTECT SAME IN WHOLE OR IN PART FROM DISCLOSURE AND DISSEMINATION TO ALL THIRD PARTIES.

## RELIABILITY NOTE

OUR MANY YEARS OF EXPERIENCE DATA ACCUMULATION INDICATE THAT SOLDER HEAT IS A MAJOR CAUSE OF EARLY AND FUTURE FAILURE. PLEASE PAY ATTENTION TO YOUR SOLDERING PROCESS.



290 E. HELEN ROAD  
PALATINE, IL 60067-6976  
PHONE: +1.847.359.2790  
US WEB: www.lumex.com  
TW WEB: www.lumex.com.tw

DRAWN BY:

JC

CHECKED BY:

APPROVED BY:

DATE: 1.26.04

PAGE: 1 OF 3

SCALE: N/A

## PIN CONFIGURATION

PIN NO.	SYMBOL	LEVEL	FUNCTION
1	RES	L	RESET INPUT PIN
2	CS	H	CHIP SELECT
3	RS	H/L	(L) CONTROL, (H) DISPLAY
4	WR	L	WRITE SIGNAL INPUT LEAD
5~12	DB0~DB7	H/L	BIDIRECTIONAL PARALLEL DATA BUS
13	VDD	-	POWER SUPPLY FOR LOGIC AND BOOSTER
14	VSS	-	GROUND
15	VLED1-	-	CATHODE LEAD FOR LED 1
16	VLED2-	-	CATHODE LEAD FOR LED 2
17	VLED+	-	ANODE LEAD FOR WHITE LED
18	VLCD	-	LCD VOLTAGE OUTPUT

## ELECTRICAL CHARACTERISTICS

ITEM	SYMBOL	CONDITION	STANDARD VALUE			UNIT
			MIN.	TYP.	MAX.	
SUPPLY VOLTAGE FOR LOGIC	V <sub>DD</sub>	-	2.4	3.0	3.3	V
SUPPLY CURRENT FOR LOGIC	I <sub>DD</sub>	V <sub>DD</sub> =3.0V	-	3.0	3.3	mA
INPUT VOLTAGE	HIGH	V <sub>IH</sub>	-	0.8*V <sub>DD</sub>	-	V <sub>DD</sub>
	LOW	V <sub>IL</sub>	-	0	-	0.2*V <sub>DD</sub>
LED BACKLIGHT	VOLTAGE	V <sub>LED</sub>	-	-	3.2	3.7
	CURRENT	I <sub>LED1</sub>	-	-	20	22
		I <sub>LED2</sub>	-	-	20	22
	COLOR	-	-	-	WHITE	-
	BRIGHTNESS	-	-	-	40	-

## ABSOLUTE MAXIMUM RATINGS

ITEM	SYMBOL	TEST CONDITION	STANDARD VALUE		UNIT
			MIN	MAX	
SUPPLY VOLTAGE FOR LOGIC	V <sub>DD</sub> -V <sub>SS</sub>	T <sub>a</sub> =25°C	-0.3	4.0	V
SUPPLY VOLTAGE FOR LCD DRIVE	V <sub>LCD</sub> -V <sub>SS</sub>	T <sub>a</sub> =25°C	-0.3	18.0	V
INPUT VOLTAGE	V <sub>I</sub>	T <sub>a</sub> =25°C	-0.4	V <sub>DD</sub> +0.5	V
CURRENT OF LED 1	I <sub>LED1</sub>	T <sub>a</sub> =25°C	0	25	mA
CURRENT OF LED 2	I <sub>LED2</sub>	T <sub>a</sub> =25°C	0	25	mA
OPERATING TEMPERATURE	T <sub>opr</sub>	-	-20	70	°C
STORAGE TEMPERATURE	T <sub>stg</sub>	-	-30	80	°C

\*UNLESS OTHERWISE SPECIFIED TOLERANCES PER DECIMAL PRECISION ARE: X=±1 (±0.039), X.X=±0.5 (±0.020), X.XX=±0.25 (±0.010), X.XXX=±0.127 (±0.005). LEAD SIZE=±0.05 (±0.002), LEAD LENGTH=±0.75 (±0.030), MIN=+DECIMAL PRECISION MAX.=+0.00  
-0.00 -DECIMAL PRECISION

## BLOCK DIAGRAM

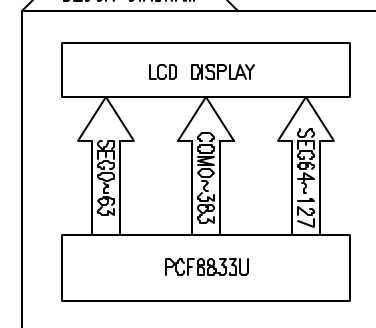

1.5" 128 x 128 CSTN MODULE, TRANSFLECTIVE (NEGATIVE),  
WHITE LED BACKLIGHT, GLARE UPPER POLARIZER,  
1/132 DUTY, 6 O'CLOCK VIEW, WEIGHT: 7.6g.

## CONFIDENTIAL INFORMATION

THE INFORMATION CONTAINED IN THIS DOCUMENT IS THE PROPERTY OF LUMEX INC. EXCEPT AS SPECIFICALLY AUTHORIZED IN WRITING BY LUMEX INC., THE HOLDER OF THIS DOCUMENT SHALL KEEP ALL INFORMATION CONTAINED HEREIN CONFIDENTIAL AND SHALL PROTECT SAME IN WHOLE OR IN PART FROM DISCLOSURE AND DISSEMINATION TO ALL THIRD PARTIES.

## RELIABILITY NOTE

OUR MANY YEARS OF EXPERIENCE DATA ACCUMULATION INDICATE THAT SOLDER HEAT IS A MAJOR CAUSE OF EARLY AND FUTURE FAILURE. PLEASE PAY ATTENTION TO YOUR SOLDERING PROCESS.



290 E. HELEN ROAD  
PALATINE, IL 60067-6976  
PHONE: +1.847.359.2790  
US WEB: www.lumex.com  
TW WEB: www.lumex.com.tw

DRAWN BY:

JC

CHECKED BY:

APPROVED BY:

DATE: 1.26.04

PAGE: 2 OF 3

SCALE: N/A

OPTICAL CHARACTERISTICS		T <sub>a</sub> =25°C (BACKLIGHT ON)						
ITEM		SYMBOL	CONDITION		STANDARD VALUE			UNIT
					MIN.	TYP.	MAX.	
VIEWING ANGLE RANGE (TRANSMISSIVE MODE)		φ1, φ2	θ=0° K≥3	X-AXIS Y-AXIS	-35 -35	- -	35 35	DEG.
CONTRAST RATIO	REFLECTIVE	CR	θ=0°, φ=0°		5.0	7.0	-	-
	TRANSMISSIVE				12.0	15.0	-	
COLOR GAMUT		CG	θ=0°, φ=0°		9.0	-	-	%
REFLECTION		RF	θ=0°, φ=0°		7.0	-	-	%
CHROMATICITY COORDINATES		R	X	θ=0°, φ=0°	0.37	0.42	0.47	-
			Y		0.23	0.28	0.33	-
		G	X		0.26	0.31	0.36	-
			Y		0.34	0.39	0.44	-
		B	X		0.15	0.20	0.25	-
			Y		0.15	0.20	0.25	-
		W	X		0.26	0.31	0.36	-
			Y		0.26	0.31	0.36	-
RESPONSE TIME	NOTE 1,2	T <sub>r</sub> +T <sub>f</sub>			-	300	350	ms

## NOTES:

1. THE TIME THAT THE LUMINANCE LEVEL REACHES 90% OF FULL BRIGHTNESS LEVEL FROM 0% WHEN "ON" SIGNAL IS APPLIED.
2. THE TIME THAT THE LUMINANCE LEVEL REACHES 10% OF FULL BRIGHTNESS LEVEL FROM 100% WHEN "OFF" SIGNAL IS APPLIED.

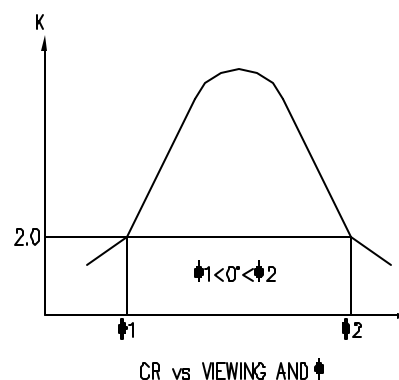
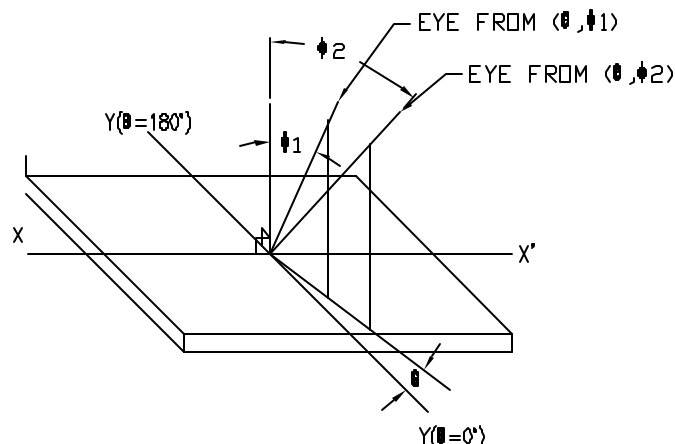

\*UNLESS OTHERWISE SPECIFIED TOLERANCES PER DECIMAL PRECISION ARE: X=±1 (±0.039), XX=±0.5 (±0.020), XXX=±0.25 (±0.010), XXXX=±0.127 (±0.005). LEAD SIZE=±0.05 (±0.002), LEAD LENGTH=±0.75 (±0.030). MIN.=+DECIMAL PRECISION MAX.=+0.00 -DECIMAL PRECISION

1.5" 128 x 128 CSTN MODULE, TRANSMISSIVE (NEGATIVE),  
WHITE LED BACKLIGHT, GLARE UPPER POLARIZER,  
1/132 DUTY, 6 O'CLOCK VIEW, WEIGHT: 7.6g.

## CONFIDENTIAL INFORMATION

THE INFORMATION CONTAINED IN THIS DOCUMENT IS THE PROPERTY OF LUMEX INC. EXCEPT AS SPECIFICALLY AUTHORIZED IN WRITING BY LUMEX INC., THE HOLDER OF THIS DOCUMENT SHALL KEEP ALL INFORMATION CONTAINED HEREIN CONFIDENTIAL AND SHALL PROTECT SAME IN WHOLE OR IN PART FROM DISCLOSURE AND DISSEMINATION TO ALL THIRD PARTIES.

## RELIABILITY NOTE

OUR MANY YEARS OF EXPERIENCE DATA ACCUMULATION INDICATE THAT SOLDER HEAT IS A MAJOR CAUSE OF EARLY AND FUTURE FAILURE. PLEASE PAY ATTENTION TO YOUR SOLDERING PROCESS.



290 E. HELEN ROAD  
PALATINE, IL 60067-6976  
PHONE: +1.847.359.2790  
US WEB: www.lumex.com  
TW WEB: www.lumex.com.tw

DRAWN BY:

JC

CHECKED BY:

APPROVED BY:

DATE: 1.26.04

PAGE: 3 OF 3

SCALE: N/A

# Mouser Electronics

Authorized Distributor

Click to View Pricing, Inventory, Delivery & Lifecycle Information:

Lumex:

[LCM-H128128GCFN-15](#)