

PART NUMBER	GT—CM3230L	REV.	E
DATE	E.C.N. NUMBER AND REVISION COMMENTS		REV.
10.18.96	E.C.N. #10261.		A
03.28.00	E.C.N. #10BRDR. & REDRAWN.		B
09.23.02	E.C.N. #10912.		C
12.11.06	E.C.N. #11148.		D
12.27.11	E.C.N. #10BRDR.		E

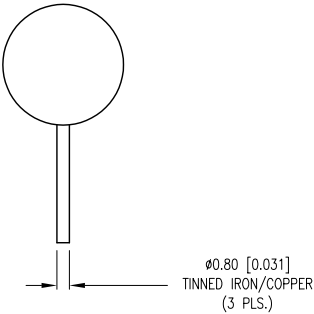
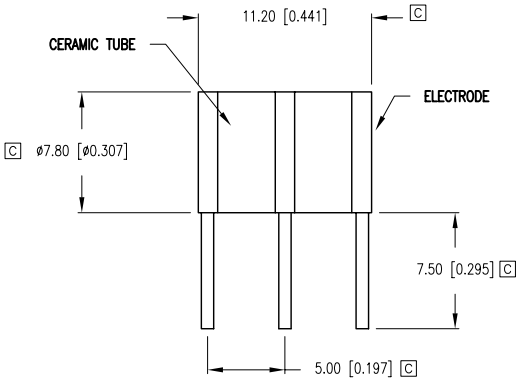

ELECTRICAL SPECIFICATIONS		
PARAMETER	VALUE	TEST CONDITION
D.C. FIRING VOLTAGE:	230V $\pm$ 20% D.C.	(dv/dt 100V/S)
IMPULSE FIRING VOLTAGE:	550V D.C. MAX.	(dv/dt 100V/ $\mu$ S)
IMPULSE CURRENT:	10KA MAX.	(8/20 $\mu$ S)
D.C. HOLDOVER VOLTAGE:	110V D.C. MAX.	(10/1000uS 500A)
A.C. DISCHARGE CURRENT:	65A	(50Hz, 9 CYCLES)
INSULATION RESISTANCE:	10 <sup>4</sup> M $\Omega$ MIN.	(50 OR 100VDC)
INTER-ELECTRODE CAPACITANCE:	2.0 PF MAX.	1.0kHz

ENVIRONMENTAL SPECIFICATIONS PER MIL-STD 202			
TEST	METHODE	CONDITION	RATING
VIBRATION TESTING:	204B	C	10–55Hz, .06DA
SHOCK	213A	C	100 g
HUMIDITY:	103B	B	95% Re. HUMIDITY
TEMPERATURE CYCLING:	102A	C	–65 TO +125 °C
BAROMETRIC PRESSURE:	105C	B	50,000 ft.
THERMAL SHOCK:	107	B	–65 TO +125 °C
SOLDERABILITY:	208	B	

RESPONSE TIME	
SURGE TYPE	(Rt MAX.)
1Kv/mS	1 x 10 <sup>–5</sup> sec.
1Kv/ $\mu$ S	1 x 10 <sup>–8</sup> sec.
5Kv/ $\mu$ S	1 x 10 <sup>–9</sup> sec.

# Mouser Electronics

Authorized Distributor

Click to View Pricing, Inventory, Delivery & Lifecycle Information:

Lumex:

GT-CM3230L