

# CM Series

## Single Pole Power Rocker Switches

### Features/Benefits

- **Illuminated versions available**
- **Easy to install snap-in design**
- **Multiple actuator and termination styles to choose from**

### Typical Applications

- **Computers and peripherals**
- **Power supplies**
- **Industrial equipment**
- **Small appliances**
- **RoHS compliant**

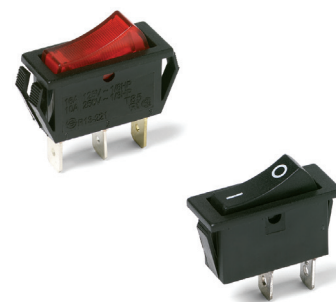

### Specifications

#### CONTACT RATING:

16 AMPS @ 125 VAC, 1/8 HP;

10 AMPS @ 250 VAC, 1/3 HP.

ELECTRICAL LIFE: 10,000 make and break cycles at full load.

INSULATION RESISTANCE:  $10^8 \Omega$  min.

DIELECTRIC STRENGTH: 1,500 VRMS @ sea level.

OPERATING TEMPERATURE: -20°C to +80°C

### Materials

HOUSING AND ACTUATOR: 6/6 nylon (UL94V-2), black, gloss or matte finish.

ILLUMINATED ACTUATOR: Polycarbonate, gloss or matte finish.

CENTER CONTACTS: Silver plated, copper alloy.

END CONTACTS: Silver plated.

ALL TERMINALS: Silver plated, copper alloy.

**NOTE:** Specifications and materials listed above are for switches with standard options. For information on specific and custom switches, consult Customer Service Center.

### Build-A-Switch

To order, simply select desired option from each category and place in the appropriate box. Available options are shown and described on pages G-95 through G-97. For additional options not shown in catalog, consult Customer Service Center.

<div>Switch Function</div> <div><b>CM101</b> SPDT On-None-On</div> <div><b>CM102</b> SPST On-None-Off</div> <div><b>CM103</b> SPDT On-Off-On</div> <div><b>CM107</b> SPDT On-Off-Mom.</div> <div><b>CM12</b> * SPST On-None-Off</div>	<div>Actuator</div> <div><b>J1</b> Rocker</div> <div><b>J3</b> Illuminated rocker</div>	<div>Actuator Color</div> <div><b>2</b> Black</div> <div><b>1</b> White</div> <div><b>3</b> Red</div> <div><b>R</b> Red, illuminated</div> <div><b>A</b> Amber, illuminated</div> <div><b>G</b> Green, illuminated</div>	<div>Mounting Style/Color</div> <div><b>S2</b> Snap-in, black</div> <div><b>S4</b> Snap-in, black</div> <div><b>S1</b> Snap-in, white</div> <div><b>S3</b> Snap-in, white</div>	<div>Termination</div> <div><b>05</b> .250" quick connect</div> <div><b>07</b> Solder lug</div>	<div>Actuator Marking</div> <div><b>(NONE)</b> No marking</div> <div><b>D</b> ON-OFF</div> <div><b>H</b> "O I" - international ON-OFF</div> <div><b>P</b> "O -" international ON-OFF</div>	<div>Contact Rating</div> <div><b>QA</b> Silver</div>	<div>Lamp Rating</div> <div><b>(NONE)</b> No lamp</div> <div><b>7</b> 125 VAC neon</div> <div><b>8</b> 250 VAC neon</div>
---	---	--	---	---	--	---	---

\* CM12 - for switches with both marking and illumination



16 May 18



# CM Series Single Pole Power Rocker Switches

## SWITCH FUNCTION



NO. POLES	MODEL NO.	SWITCH FUNCTION			CONNECTED TERMINALS			SCHEMATIC
		Pos. 1	Pos. 2	Pos. 3	Pos. 1	Pos. 2	Pos. 3	
		C&K marking on opposite side			C&K marking on opposite side			
SP	CM101	ON	NONE	ON	2-1	N/A	2-3	
	CM102	ON	NONE	OFF			OPEN	OR
	CM103	ON	OFF	ON		OPEN	2-3	
	CM107	ON	OFF	MOM.				
	CM12 *	ON	NONE	OFF		N/A	OPEN	

\* CM12 - for switches with both marking and illumination

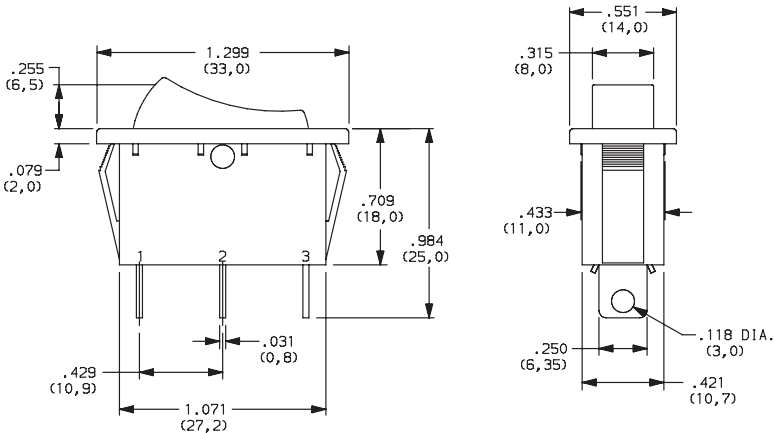

Shown in Pos. 1

## ACTUATOR



- J1 ROCKER
- J3 ILLUMINATED ROCKER

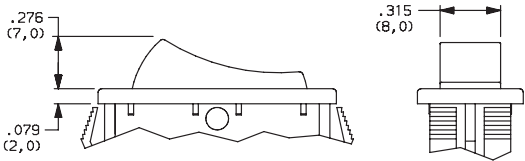

NOTE: J3 actuator available with CM102 & CM12 switch function only.

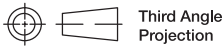

Third Angle  
Projection

Dimensions are shown: Inches (mm)  
Specifications and dimensions subject to change



# CM Series Single Pole Power Rocker Switches

## ACTUATOR COLOR



OPTION CODE	ACTUATOR COLOR
<b>2</b>	BLACK
<b>1</b>	WHITE
<b>3</b>	RED
<b>R</b>	RED, ILLUMINATED
<b>A</b>	AMBER, ILLUMINATED
<b>G</b>	GREEN, ILLUMINATED

## MOUNTING STYLE/COLOR



**S2** SNAP-IN, BLACK

**S1** SNAP-IN, WHITE

**S4** SNAP-IN, BLACK (SHORT FRAME)

**S3** SNAP-IN, WHITE

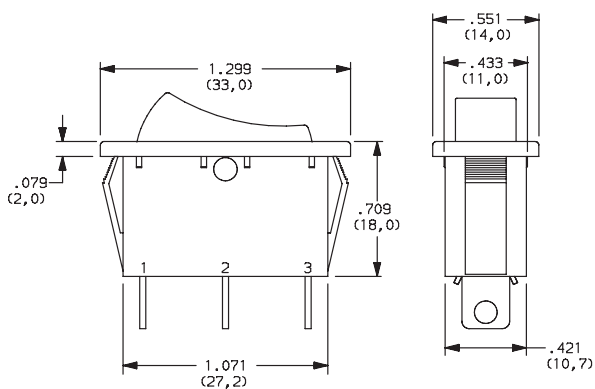

Shown in Pos. 1

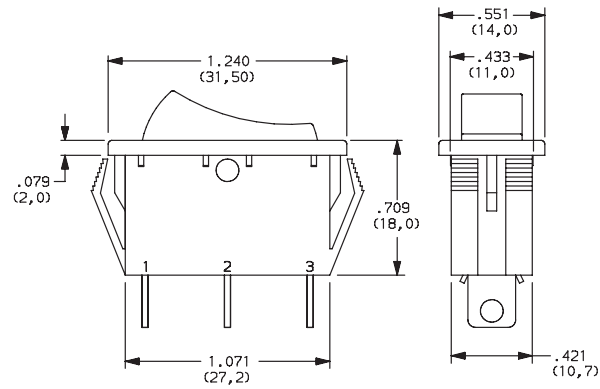

Shown in Pos. 1

### PANEL MOUNTING

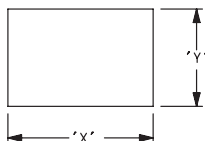

PANEL THICKNESS	"X"	"Y"
0.030-0.049 (0,75-1,25)	1.189-.004 (30,2-0,1)	0.441+.004 (11,2+0,1)
0.049-0.079 (1,25-2,0)	1.197-.004 (30,4-0,1)	0.441+.004 (11,2+0,1)
0.079-0.118 (2,0-3,0)	1.212-.004 (30,8-0,1)	0.441+.004 (11,2+0,1)

## TERMINATION



**05** .250 QUICK CONNECT

**07** SOLDER LUG

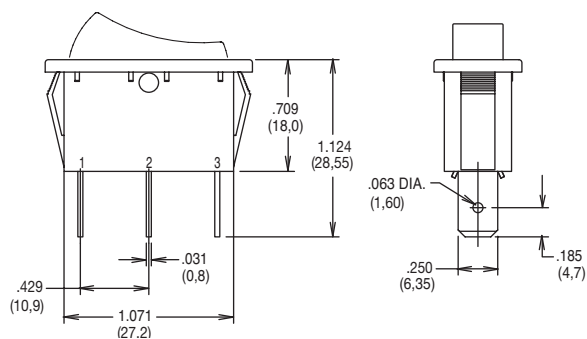

Shown in Pos. 1

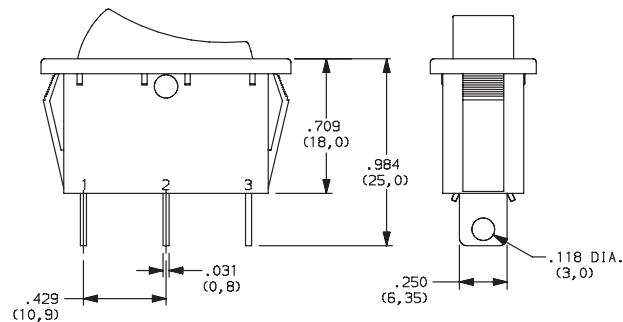

**NOTE:** Available with CM101 & CM102 switch functions only.

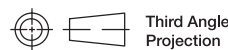

Dimensions are shown: Inches (mm)  
Specifications and dimensions subject to change



16 May 18



# CM Series Single Pole Power Rocker Switches

## ACTUATOR MARKING



**NONE** NO MARKING



**D** ON-OFF



**H** O I

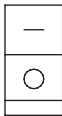

**P** O -

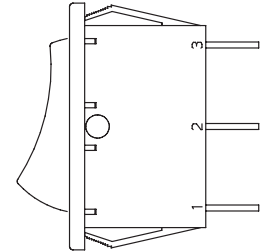

**NOTE:** Orientation of actuator marking and terminals.

Shown in Pos. 1

## CONTACT MATERIAL



OPTION CODE	CONTACT AND TERMINAL MATERIAL	RATINGS	
		POWER	
<b>QA</b>	SILVER		16 AMPS @ 125 VAC; 1/8 HP 10 AMPS @ 250 VAC, 1/3 HP

\* Note: See Technical Data section of this catalog for RoHS compliant and compatible definitions and specifications.



## LAMP RATING



**(NONE)** NO LAMP

**7** 125 VAC 33kΩ NEON

**8** 250 VAC 150kΩ NEON

**NOTE:** Lamp rating for J3 & J8 actuator option.

Rocker



G

**C&K**

16 May 18

G-94



Dimensions are shown: Inches (mm)  
Specifications and dimensions subject to change

[www.ckswitches.com](http://www.ckswitches.com)

# Mouser Electronics

Authorized Distributor

Click to View Pricing, Inventory, Delivery & Lifecycle Information:

## C&K Switches:

[CM101J12S207QA](#) [CM101J11S205QA](#) [CM101J12S205QA](#) [CM101J12S405QA](#) [CM101J11S105QA](#)  
[CM107J12S205QA](#) [CM103J12S205QA](#) [CM102J12S207QA](#) [CM102J12S205HQA](#) [CM102J12S205QA](#)  
[CM102J12S205DQA](#) [CM102J3RS205QA7](#) [CM102J11S205QA](#) [CM102J12S205PQA](#) [CM102J3AS205QA7](#)  
[CM102J3AS205QA8](#) [CM102J3RS205QA8](#) [CM102J11S205PQA](#) [CM102J12S405QA](#) [CM102J3GS205QA7](#)  
[CM102J3GS205QA8](#) [CM102J11S305HQA](#) [CM102J12S105PQA](#) [CM102J12S405PQA](#) [CM102J13S205QA](#)  
[CM103J12S405PQA](#)