

877 Series Fuse, Lead-free 3.6 × 10 mm, Time-Lag Fuse



| Agency | Agency File Number | Ampere Range |
|--------|--------------------|--------------|
| | 40023242 | 2A – 6.3A |
| | E10480 | 2A – 6.3A |
| | 2020970207000014 | 2A – 6.3A |
| | SU05024-10002 | 2A |
| | SU05024-10001 | 3.15A - 6.3A |
| | NBK240212-JP1021 | 2A – 4A |

Additional Information



Datasheet



Resources



Samples

Description

The 877 Series is a single pigtail, axial leaded, 3.6 × 10mm, time-lag fuse.

Features

- Designed to meet IEC 60127-3 Standard Sheet 4
- Single Pigtail Axial Lead format
- Pb-free, RoHS compliant
- Time-Lag, ceramic body fuse in a compact package
- Available in ratings of 2 to 6.3 Amperes

Applications

This space saving fuse is ideally suited for lighting, power supply, and adapter applications.

Electrical Characteristics

| % of Ampere Rating | Opening Time |
|--------------------|-----------------------------|
| 150% | 60 minutes, Minimum |
| 210% | 2 minutes, Maximum |
| 275% | 400 ms., Min.; 10 sec. Max. |
| 400% | 150 ms., Min.; 3 sec. Max. |
| 1000% | 20 ms. Min.; 150 ms. Max. |

Electrical Characteristics

| Amp Code | Ampere Rating (A) | Voltage Rating (V) | Interrupting Rating** | Nominal Cold Resistance (Ω)* | Nominal Melting I ² t (A ² sec) | Nominal Voltage Drop (mV) | Nominal Power Dissipation (mW) | Agency Approvals | | | | |
|----------|-------------------|--------------------|-----------------------|------------------------------|---|---------------------------|--------------------------------|------------------|---|---|---|---|
| | | | | | | | | | | | | |
| 002. | 2.0 | 250 | 35A @ 250 V AC | 0.035 | 24.6 | 82 | 450 | x | x | x | x | x |
| 3.15 | 3.15 | 250 | 35A @ 250 V AC | 0.020 | 67.6 | 76 | 690 | x | x | x | x | x |
| 004. | 4.0 | 250 | 40A @ 250 V AC | 0.0167 | 143.4 | 74 | 926 | x | x | x | x | x |
| 06.3 | 6.3 | 250 | 63A @ 250 V AC | 0.0087 | 190 | 60 | 1130 | x | x | | x | x |

Notes:

*Cold resistance measured at less than 10% of rated current at 23°C.

** Interrupting Rating may differ based on Agency Approval. See Agency Approval certificate for more details.

Temperature Re-rating Curve

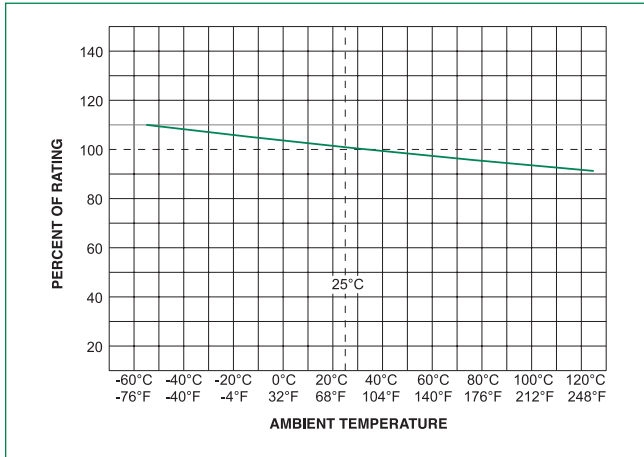

Note:

1. Rerating depicted in this curve is in addition to the standard derating of 25% for continuous operation.

Average Time Current Curves

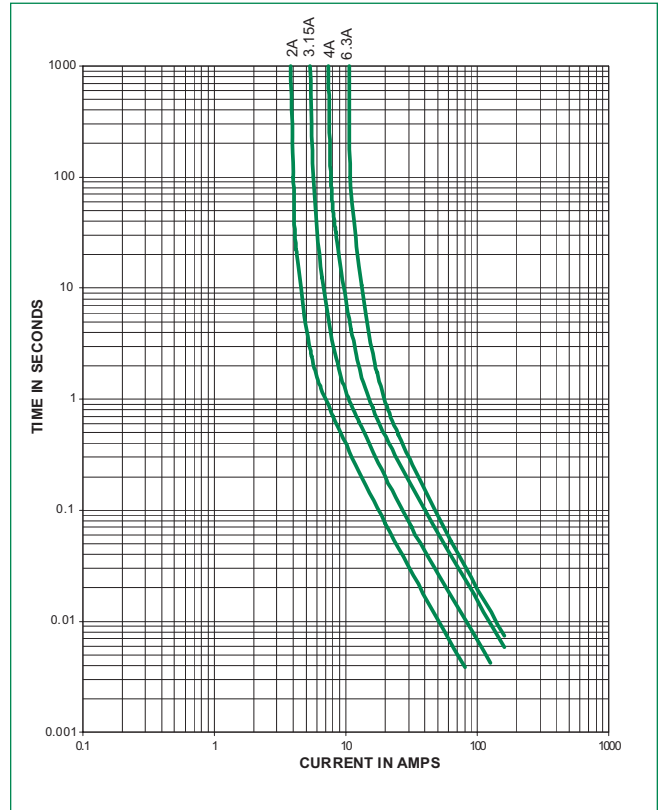

Soldering Parameters - Wave Soldering

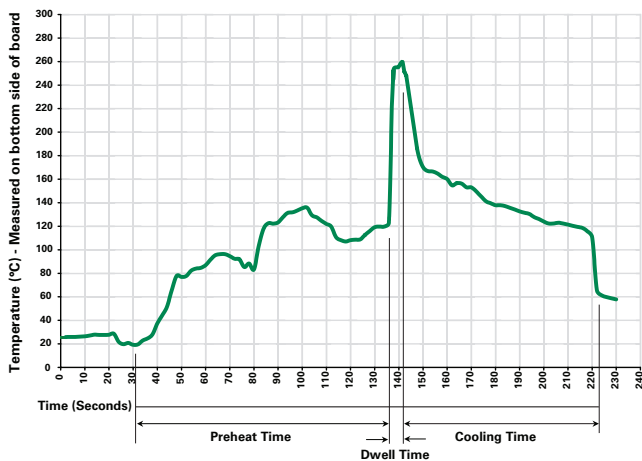

Recommended Process Parameters:

| Wave Parameter | Lead-Free Recommendation |
|--|-----------------------------------|
| Preheat: (Depends on Flux Activation Temperature) | (Typical Industry Recommendation) |
| Temperature Minimum: | 100°C |
| Temperature Maximum: | 150°C |
| Preheat Time: | 60-180 seconds |
| Solder Pot Temperature: | 260°C Maximum |
| Solder Dwell Time: | 2-5 seconds |

Recommended Hand-Solder Parameters:

Solder Iron Temperature: 350°C +/- 5°C
Heating Time: 5 seconds max.

Note: These devices are not recommended for IR or Convection Reflow process.

Product Characteristics

| | |
|--------------------------|---|
| Materials | Body: Ceramic Cap: Nickel Plated Brass Tin Plated Copper |
| Terminal Strength | MIL-STD-202, Method 211, Test Condition A |
| Solderability | MIL-STD-202, Method 208 |
| Product Marketing | Body: Brand Logo, Current Rating Characteristic "T", Agency approval marks |
| Packaging | Bulk (1000 pcs/pkg) Tape and Reel (1000 pcs/reel) |

| | |
|------------------------------|---|
| Operating Temperature | -55°C to 125°C |
| Thermal Shock | MIL-STD-202, Method 107 Test Condition B3 (5 cycles -65°C to +125°C) |
| Vibration | MIL-STD-202, Method 201 (10-55 Hz) |
| Humidity | MIL-STD-202, Method 106, High Humidity (90-98%RH), Heat (65°C) |
| Salt Spray | MIL-STD-202, Method 101, Test Condition B |

Dimensions

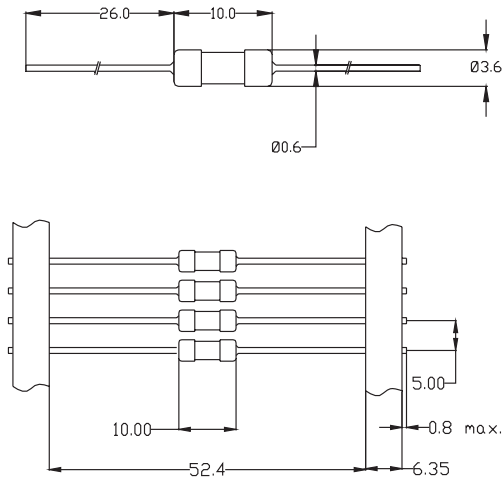

All dimensions in mm

Part Numbering System

| | 0877 | xxxx | M | X | E | P |
|-----------------------|--|------|---|---|---|---|
| Series | | | | | | |
| Amp Code | Refer to Amp Code column of Electrical Characteristics Table | | | | | |
| Quantity Code | M = 1000 | | | | | |
| Packaging Code | X = Filler | | | | | |
| Option Code | E = Axial Leaded | | | | | |
| Lead-free | P = Lead-Free Others = Special Options Please call Littelfuse for detail | | | | | |

Packaging

| Packaging Option | Packaging Specification | Quantity | Quantity & Packaging Code | Taping Width |
|-------------------|-------------------------|----------|---------------------------|--------------------|
| 877 Series | | | | |
| Bulk | Bulk | 1000 | MXE | N/A |
| Tape and Reel | EIA 296 | 1000 | MRET1 | T1 = 52mm (2.062") |

Mouser Electronics

Authorized Distributor

Click to View Pricing, Inventory, Delivery & Lifecycle Information:

Littelfuse:

[0877002.MRET1P](#) [0877002.MXEP](#) [0877004.MRET1P](#) [0877004.MXEP](#) [087706.3MRET1P](#) [087706.3MXEP](#)
[08773.15MRET1P](#) [08773.15MXEP](#)