

# 3S-Series

Miniature Pushbutton Switches

**PRODUCT WEBPAGE**

*request sample, configure part*

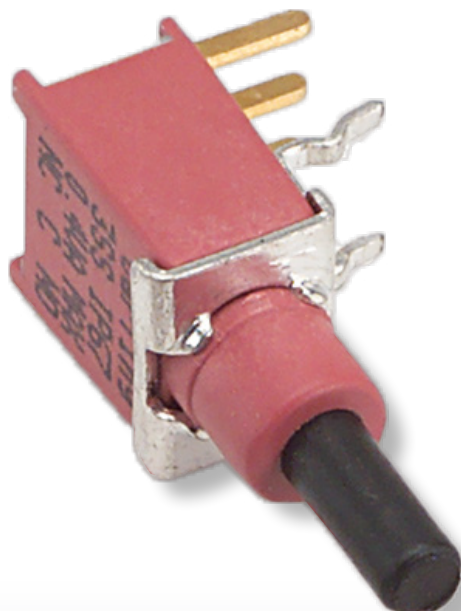

The 3S family of sub-miniature pushbutton switches is composed of three switch series; the 3SI-Series sub-miniature pushbutton switch, the 3SS-Series sealed sub-miniature pushbutton switch, and the 3SM-Series surface mount sealed sub-miniature pushbutton switch. All switches are available with a variety of rating, termination and actuator choices, and will withstand temperatures from -30°C to +85°C.

**1-2**  
Poles

**.4-6**  
Amps

**125, 250**  
VAC

**28**  
VDC

## Typical Applications

- Instrumentation
- Networking
- Computers
- Telecommunications
- Performance Audio
- Low Power On/Off Designs

# Tech Specs

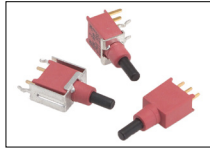

**3SS-Series**  
Sealed  
Sub-Miniature  
Pushbutton Switch



**3S1-Series**  
Sub-Miniature  
Pushbutton Switch



**3SM-Series**  
Sealed Surface Mount  
Sub-Miniature  
Pushbutton Switch

## Electrical

Contact Rating	refer to ordering scheme
Electrical Life	50,000 make & break cycles @ full load
Contact Resistance	20 mΩ max. initial @ 2-4 VDC 100mA for both silver & gold plated contacts
Insulation Resistance	1000 MΩ min.
Dielectric Strength	1500 Volts RMS @ sea level

## Physical

Operating Temperature	-30°C to +85°C
Index of Protection	3SS & 3SM-Series: IP67
Solder Heat Resistance	MIL-STD-202, Method 210

## Material

Case	all UL94 V-0 3S1-Series: Dially phthalate (DAP) 3SS-Series: Glass filled nylon 6/6, flame retardant, heat stabilized 3SM-Series: Glass filled nylon 4/6, flame retardant, heat stabilized
Plunger	3S1-Series: Thermoplastic polyester, black 3SS-Series: Thermoplastic polyester (UL 94V-0), with internal o-ring 3SM-Series: Glass filled nylon 4/6, flame retardant, heat stabilized
Bushing	3S1-Series: Brass, nickel plated 3SS-Series: Glass filled nylon 6/6, flame retardant, heat stabilized (UL 94V-0) 3SM-Series: Glass filled nylon 4/6, flame retardant, heat stabilized (UL 94V-0)
Housing	Stainless Steel
Switch Support	Brass, tin plated
Terminal Seal	Epoxy

# Ordering Scheme

Sample Part Number	3SS	-	WSP	9	-	M6	R	E
Selection	1		2	3		4	5	6

### 1. SERIES

**3SS** Sealed Sub-Miniature Pushbutton Switch

### 2. POLES

**WSP** Single pole - uses terminals 1, 2 & 3  
**WDP** Double pole - uses terminals 1, 2, 3, 4, 5 & 6

### 3. CIRCUIT

( ) - momentary  
**Switching Position:** 1 2  
2-3, 5-6 2-1, 5-4  
**8** ON (ON)  
**9** OFF (ON)

Note: Plunger at rest in Position 1. Plunger depressed in Position 2.

### 4. ACTUATOR STYLE 4

**M2** PCB  
**M6** PC Mount, 90° horizontal  
**M61** Snap-In, 90° horizontal  
**M7** PC Mount, 90° vertical  
**M71** Snap-In, 90° vertical  
**VS2** PC Mount, U bracket  
**VS21** Snap-In, U bracket

### 5. CONTACTS / TERMINALS

Contact Material	Terminal Plating	Rating	Approvals
G silver <sup>1</sup>	gold over silver	1A 125VAC or 28VDC	IP67
K gold <sup>2</sup>	tin <sup>3,4</sup>	0.4VA max 20V max (AC/DC)	IP67
P silver <sup>1</sup>	tin <sup>3,4</sup>	1A 125VAC or 28VDC	IP67
R gold <sup>2</sup>	gold <sup>2</sup>	0.4VA max 20V max (AC/DC)	IP67

### 8. EPOXY SEAL

**E** Epoxy Seal **0** without Epoxy Seal

#### Notes:

- Movable contact & terminal platings: silver over copper alloy
- Movable contact & terminal platings: gold over nickel over copper alloy
- Terminal platings: tin over nickel over copper alloy
- Tin option available with PC terminations only.

[Configure Complete Part Number >](#)

[Browse Standard Parts >](#)

# Ordering Schemes

Sample Part Number **3S1 - SP 9 - B6 - M7 - R E**

Selection 1 2 3 4 5 6 7

## 1. SERIES

**3S1** Sub-Miniature Pushbutton Switch

## 2. POLES

**SP** Single pole - uses terminals 1, 2 & 3

## 3. CIRCUIT

( ) - momentary  
**Switching Position:** 1 2  
2-3, 5-6 2-1, 5-4  
8 ON (ON)  
9 OFF (ON)

Note: Plunger at rest in Position 1. Plunger depressed in Position 2.

## 4. ACTUATOR STYLE

**B5** 1 10-48 Threaded  
**B6** 1/4" Unthreaded "D"  
**B7** Unthreaded  
**B8** 2 1/4-40 Threaded "D"  
**B9** Flush Bushing  
**B0** 1/4" Unthreaded "D"  
**OP1** Snap-In with bezel  
**P0** Flush Plunger

[Configure Complete Part Number >](#)

[Browse Standard Parts >](#)

## 5. TERMINATION

**M1** Solder Lug  
**M7** PC Mount, 90° vertical  
**M2** PCB M71  
Snap-In, 90° vertical  
**M6** PC Mount, 90° horizontal  
**VS2** PC Mount, U bracket  
**M61** Snap-In, 90° horizontal  
**VS21** Snap-In, U bracket

## 6. CONTACTS / TERMINALS

Contact Material	Terminal Plating	Rating
<b>G</b> silver <sup>3</sup>	gold over silver	1A@125VAC or 28VDC
<b>K</b> gold <sup>4,7</sup>	tin <sup>6</sup>	0.4VA max @ 20V max (AC/DC)
<b>P</b> silver <sup>3,8</sup>	tin <sup>6</sup>	1A@125VAC or 28VDC
<b>Q</b> silver <sup>3</sup>	silver <sup>3</sup>	1A@125VAC or 28VDC
<b>R</b> gold <sup>4</sup>	gold <sup>5</sup>	0.4VA max @ 20V max (AC/DC)

## 7. EPOXY SEAL

**E** Epoxy Seal **0** without Epoxy Seal

### Notes:

- Hardware includes (2) 2M1-HDW21 nuts, and (1) 2M1-HDW22 washer
- Hardware includes (2) 2M1-HDW2 nuts, (1) 2M1-HDW11 washer, and (1) 2M1-HDW16 locking ring
- Movable contact and terminal platings: silver over copper alloy
- Movable contact and terminal platings: gold over nickel over copper alloy
- Terminal platings: gold over nickel over copper alloy
- Terminal platings: tin over copper alloy
- Terminal contact platings: Gold over nickel alloy
- Terminal contact platings: silver over nickel alloy

Sample Part Number **3S1 - SP 9 - B6 - M7 - R E**

Selection 1 2 3 4 5 6 7

## 1. SERIES

**3MS** Sealed Snap-Action Miniature Pushbutton Switch

## 2. POLES

**SP** Single pole - uses terminals 1, 2 & 3

## 3. CIRCUIT

( ) - momentary  
**Switching Position:** 1 2  
2-3, 5-6 2-1, 5-4  
7 ON (ON)

Note: Plunger at rest in Position 1. Plunger depressed in Position 2.

## 4. TERMINATION

**K6** Surface Mount, horizontal .433 [11.00 mm]  
**M6** Surface Mount, 90° flat .286 [7.26 mm]  
**M7** Surface Mount, 90° right angle  
**S6** Surface Mount, 90° horizontal .353 [8.97 mm]

## 5. CONTACTS/TERMINALS

Contact Material	Terminal Plating	Rating	Approvals
<b>G</b> silver <sup>1</sup>	gold over silver	1A 125VAC or 28VDC	IP67
<b>K</b> gold <sup>2,5</sup>	tin <sup>4</sup>	0.4VA max 20V max (AC/DC)	IP67
<b>P</b> silver <sup>1,6</sup>	tin <sup>4</sup>	1A 125VAC or 28VDC	IP67
<b>Q</b> silver <sup>1</sup>	silver <sup>1</sup>	1A 125VAC or 28VDC	IP67
<b>R</b> gold <sup>2</sup>	gold <sup>3</sup>	0.4VA max 20V max (AC/DC)	IP67

## 6. EPOXY SEAL

**E** Epoxy Seal **0** without Epoxy Seal

## 7. PACKAGING

**T/R** tape reel - 500 pieces per reel  
Switches are bulk packed, unless T/R is specified at the end of the part number.

### Notes:

- Movable contact and terminals platings: silver over copper alloy
- Movable contact platings: gold over nickel over copper alloy
- Terminal platings: gold over nickel over copper alloy
- Terminals platings: tin over copper alloy
- Terminal contact platings: gold over nickel alloy
- Terminal contact platings: silver over nickel alloy

[Configure Complete Part Number >](#)

[Browse Standard Parts >](#)

## 3S-Series Accessories

To order accessories assembled on a switch, specify the switch number followed by the accessory part number and the word "assembled". Ex: 3S1-SP9-B6-M7-RE-C23 ASSEMBLED. To order accessories in bulk, specify the Series, followed by the accessory. Ex: 3S1-C13.

## Optional Cap

Sample Part Number **3S1 - C1 3**

Selection 1 2 3

## 1. SERIES

**3S1** Fits 3SS, 3S1 or 3MS

## 2. TOGGLE CAP SIZE

**C1** .158" [4.01 mm] height **C2** .138" [35.05 mm] height

## 3. CAP COLOR

<b>1</b> White	<b>5</b> Yellow
<b>2</b> Black	<b>6</b> Green
<b>3</b> Red	<b>7</b> Blue
<b>4</b> Orange	

# Dimensional Specs

inches [millimeters]

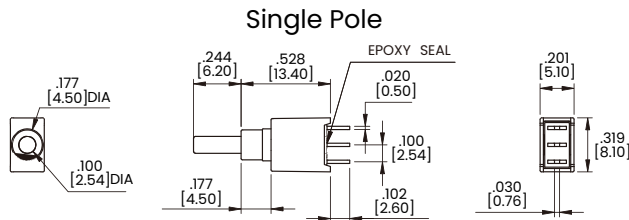

\* Double Thrown Shown. Single Throw uses two outer terminals only.

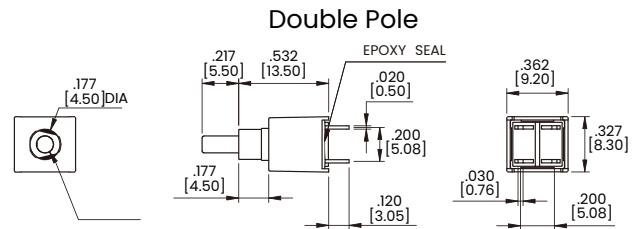

## Termination Options

### M6 Single Pole

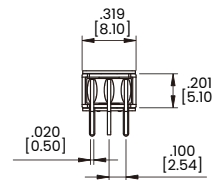
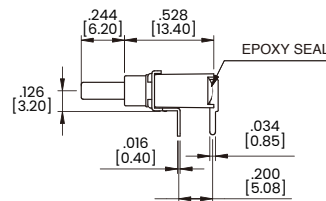
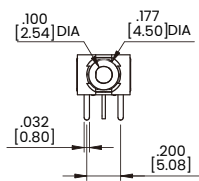

### P.C.MOUNTING

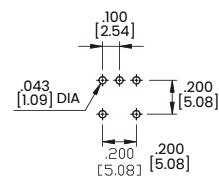

\* Double Thrown Shown. Single Throw uses two outer terminals only.

### M6 Double Pole

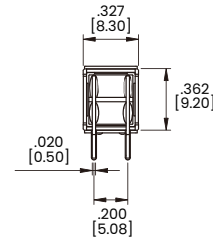
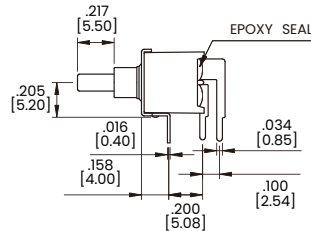
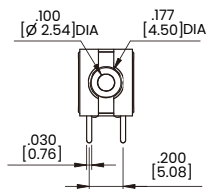

### P.C.MOUNTING

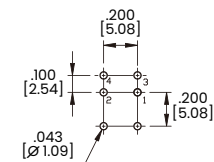

### M7 Single Pole

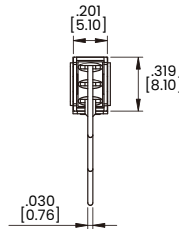
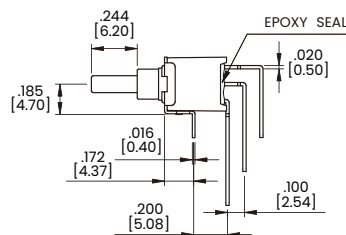
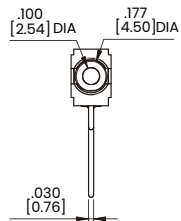

### P.C.MOUNTING

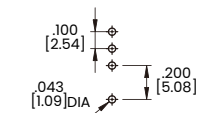

\* Double Thrown Shown. Single Throw uses two outer terminals only.

### M7 Double Pole

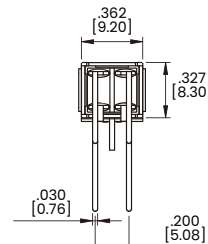
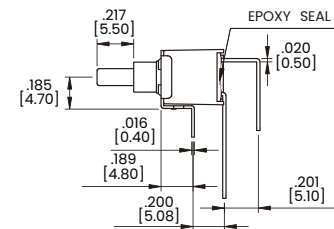
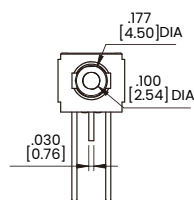

### P.C.MOUNTING

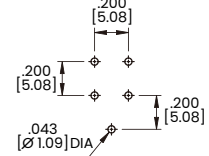

# Dimensional Specs

inches [millimeters]

## Termination Options

### VS2 Single Pole

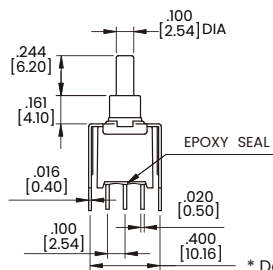
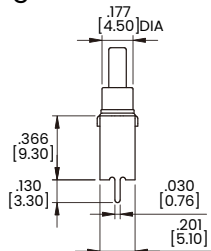

### P.C.MOUNTING

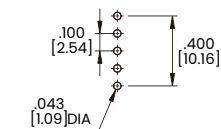

\* Double Throw Shown. Single Throw uses outer terminals only.

### VS2 Double Pole

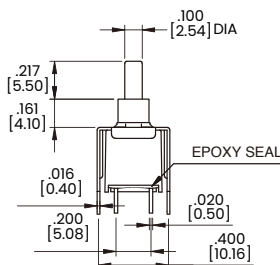
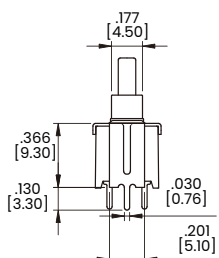

### P.C.MOUNTING

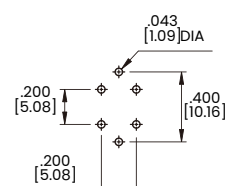

## Snap-In Termination Options

### M61

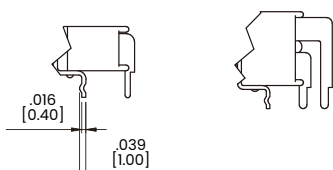

### M71

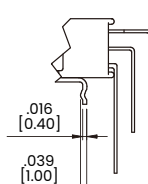

### VS21

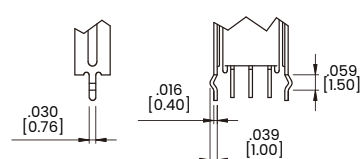

\* PC Mounting for M61, M71, VS21 refer to M6, M7, VS2 respectively.

# Dimensional Specs

inches [millimeters]

## Single Pole

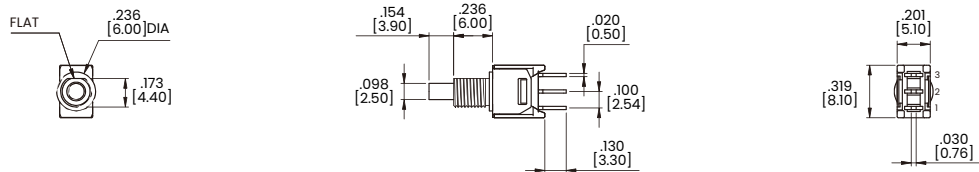

\* Double Throw shown. Single Throw uses two outer terminals only.

## Actuator Options for Snap-In Front Mount

### OP1

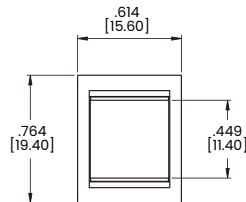
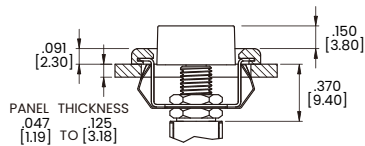

### PANEL MOUNTING

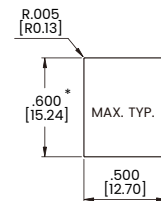

\*Increase this dimension to .620/.625 [15.75/15.88] for .091/.125 [2.31/3.18] thk. panels.

### OP1 Without Frame

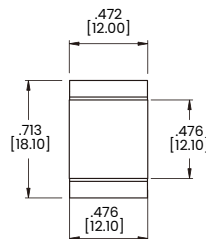
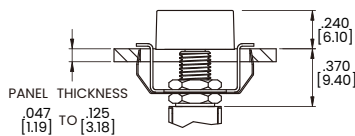

### PANEL MOUNTING

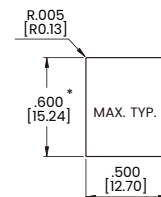

\*Increase this dimension to .620/.625 [15.75/15.88] for .091/.125 [2.31/3.18] thk. panels.

## Bushing Options

### B5

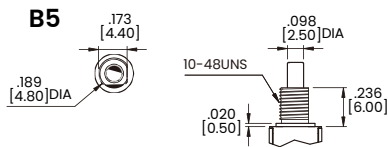

### B6

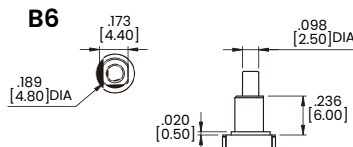

### B7

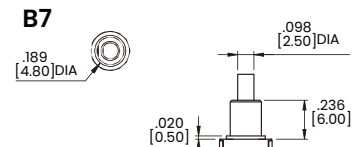

### B8

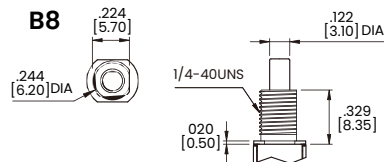

### B9

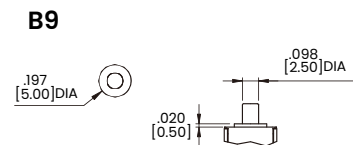

### B0

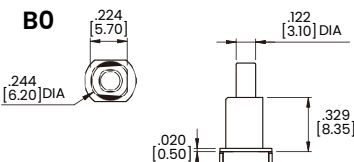

## Termination Options

### M1

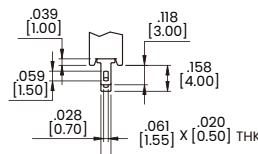

### M2

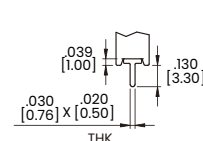

# Dimensional Specs

inches [millimeters]

## Termination Options

### M6 Single Pole

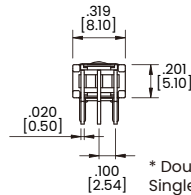
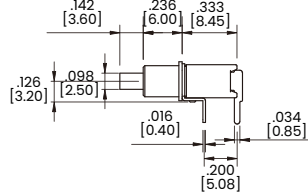
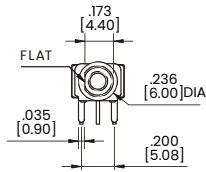

\* Double Thrown Shown.  
Single Throw uses two outer terminals only.

### P.C.MOUNTING

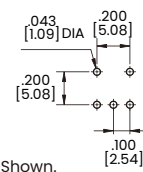

### M7 Single Pole

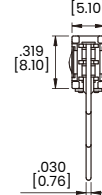
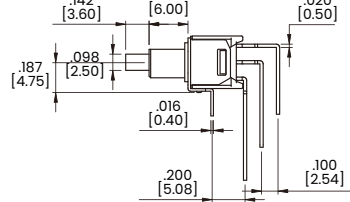
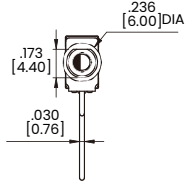

\* Double Thrown Shown.  
Single Throw uses two outer terminals only.

### P.C.MOUNTING

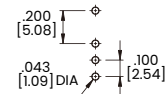

### VS2 Single Pole

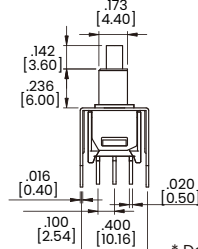
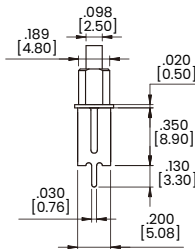

\* Double Thrown Shown. Single Throw uses outer terminals only.

### P.C.MOUNTING

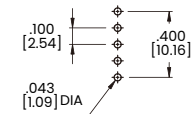

## Snap-In Termination Options

### M61

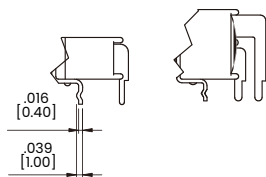

### M71

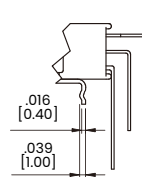

### VS21

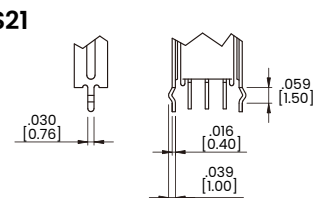

\* PC Mounting for M61, M71, VS21 refer to M6, M7, VS2 respectively.

# Dimensional Specs

inches [millimeters]

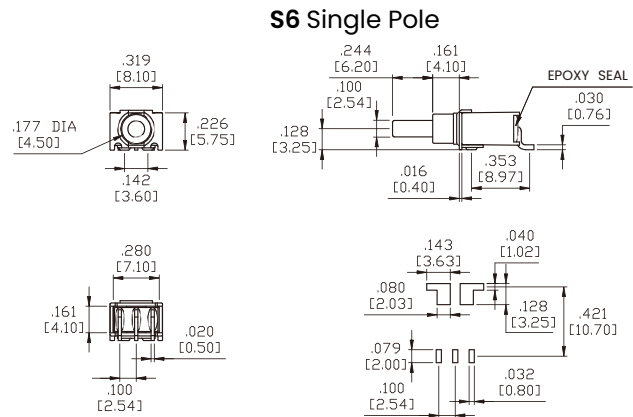
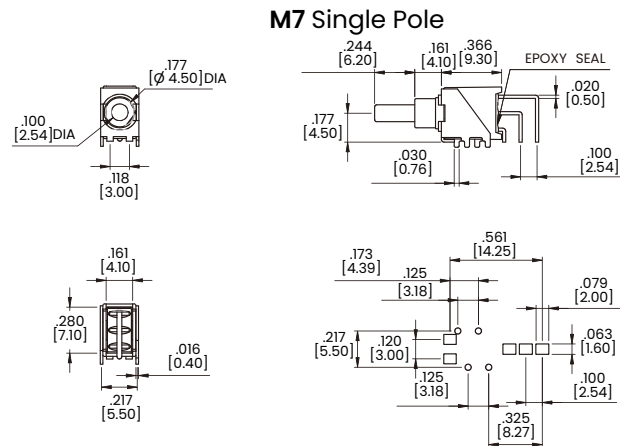
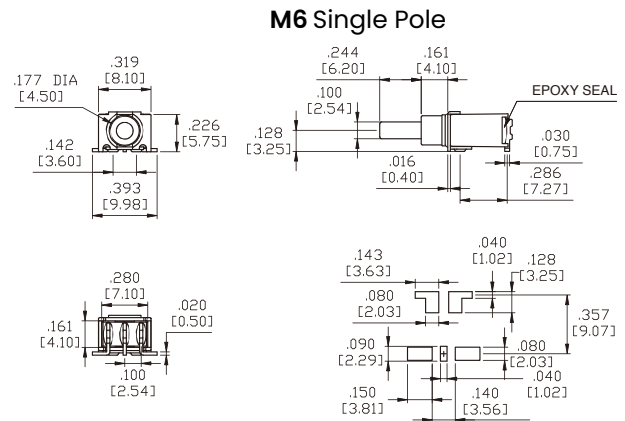
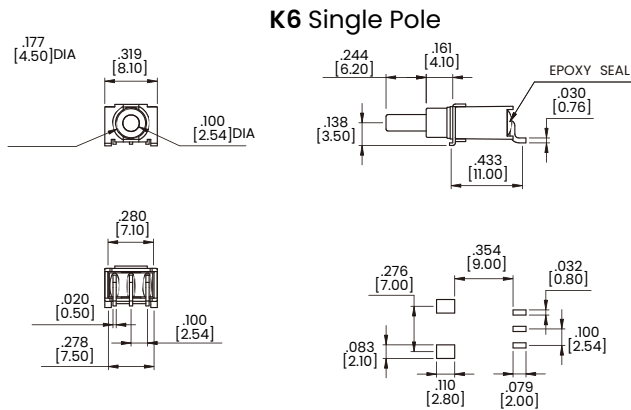

\* Double Throw Shown. Single Throw uses two outer terminals only.

**C1**

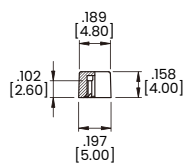

\* MATERIAL: ABS.

**C2**

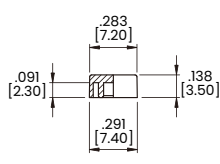

\* MATERIAL: ABS.

## Plunger Caps

CAP COLORS			
1	White	6	Green
2	Black	7	Blue
3	Red	8	Brown
4	Orange	9	Gray
5	Yellow		

## Authorized Sales Representatives and Distributors

Click on a region of the map below to find your local representatives and distributors or visit [www.carlingtech.com/findarep](http://www.carlingtech.com/findarep).



## About Carling

Founded in 1920, Carling Technologies is a leading manufacturer of electrical and electronic switches and assemblies, circuit breakers, electronic controls, power distribution units, and multiplexed power distribution systems. With six ISO9001 and IATF16949 registered manufacturing facilities and technical sales offices worldwide, Carling Technologies Sales, Service and Engineering teams do much more than manufacture electrical components, they engineer powerful solutions! To learn more about Carling please visit [www.carlingtech.com/company-profile](http://www.carlingtech.com/company-profile).

To view all of Carling's environmental, quality, health & safety certifications please visit [www.carlingtech.com/environmental-certifications](http://www.carlingtech.com/environmental-certifications).

# Mouser Electronics

Authorized Distributor

Click to View Pricing, Inventory, Delivery & Lifecycle Information:

## Carling Technologies:

[3SS-WDP9-M7-RE](#) [3S1-SP9-B5-M1-QE](#) [3S1-SP9-B8-M2-QE](#) [3S1-SP8-B6-M6-RE](#) [3SS-WSP8-M6-RE](#) [3SS-WSP9-M2-RE](#) [3S1-SP8-B5-M1-QE](#) [3S1-SP9-B6-M2QE](#) [4M1-SDP1-S1/2-M1QE](#) [3SS-WSP9-M7-KE](#) [3S1-SP9-B6-M6-PE](#) [3SM-SP8-S6-GET/R](#) [3S1-SP9-B5-M1-RE](#) [3S1-SP9-B6-VS2-KE](#) [3S1-SP9-B7-M6-RE](#) [3SS-WSP8-M6-KE](#) [3SS-WSP9-M6-RE](#) [3SS-WSP9-M6-KE](#) [3S1-00000018](#) [3S1-00000022](#) [3S1-00000023](#) [3S1-00000024](#) [3S1-00000025](#) [3S1-00000026](#) [3S1-00000027](#) [3SM-00000001](#) [3SM-00000003](#) [3SS-00000012](#) [3S1-SP9-B8-M1-RE](#) [3S1-SP8-B8-M1-RE](#) [3SS-WSP8-M6-GE](#) [3SM-SP8-S6-G-E](#) [3S1-SP8-B8-M2-KE](#) [3SM-SP8-M6-GE](#) [3S1-SP8-B8-M1QE-C22](#) [3S1-SP8-B5-M61-QE](#) [3S1-SP9-B5-M6-GE](#) [3S1-SP9-B7-M6-GE](#)