

MID POWER SPEC Pak®

Sealed Power For Environmental Connections



Marine | Wind Power | Lighting | Transportation | Pumps | Ground Support
Machine Tool | Industrial Automation | Motor | Solar Power | Harsh Environments



ANDERSON
POWER™

Rugged and Sealed (IP68) Plugs and Receptacles

The SPEC Pak® Mid Power is rugged and environmentally sealed (IP68). It leverages APP's core Powerpole® flat wiping contact technology, offering power handling capabilities up to 80 amps at 600 volts with signal.

The SPEC Pak® Mid Power shells are highly configurable. They accept up to four Powerpole® 75 (PP75) contacts and housings. They also accept up to 8 pin and socket auxiliary contacts providing the user signal and/or sequencing options. Assembly is made easy through the use of colored Powerpole® housings which can be matched to wire colors. They will accept wire sizes ranging from 12 to 6 AWG [3.3 to 13.3 mm²]. SPEC Pak® Mid Power is highly configurable providing users with a multitude of flexible design solutions in a single interconnect.

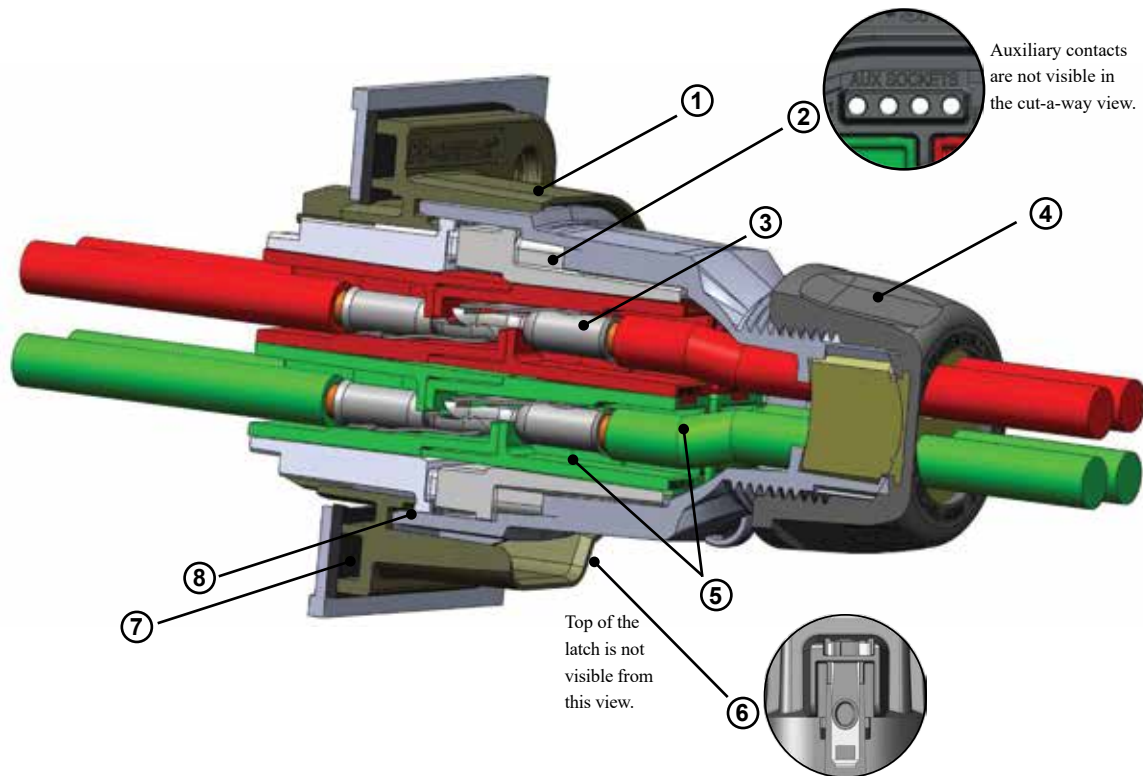

1 - Chemical & UV Resistant Ruggedized Shells

- Wire to Wire Configurations
- Wire to Panel Configurations

2 - Auxiliary Contacts for Signal and/or Sequencing (up to 8)

3 - Power Contacts (up to 4)

4 - Sealing Gland to Ensures (IP68) Environmental Seal

5 - Color Coded Powerpole® Housings to Match Wire Colors

6 - Stainless Steel Latches to Prevent Accidental Unmating

7 - IP68 Panel Mount Receptacle Gasket

8 - Sealing O-Ring Ensures (IP68) Environmental Seal

Specifications

..... SPEC Pak® Shells Used With

SPEC Pak® Shell	Powerpole® Power Contacts & Housings	Auxiliary Contacts ^[1] (PowerMod® Series)
-----------------	--------------------------------------	--

Electrical

Current Rating (Amperes)

UL 1977	-	80 ^[2]	5
CSA (30° C Rise)	-	50 ^[2]	5

Voltage Rating

UL 1977 (AC/DC)	-	600	600
-----------------	---	-----	-----

Dielectric Withstanding (AC)	-	3,000	-
------------------------------	---	-------	---

Contact Resistance Milliohms (average)	-	0.200 ^[3]	2.000 ^[4]
--	---	----------------------	----------------------

Hot Plug Amp Rating (UL 1977)

250 Cycles at 120V	-	50 ^[5]	
--------------------	---	-------------------	--

Mechanical

Environmental Seal

IP rating	IP68	-	-
Submersion (UL 50E)	Pass	-	-

Wire Size	-	12 to 6 AWG	24 to 12 AWG
	-	3.3 to 13.3 mm ²	0.50 to 2.5 mm ²

Operating Temperature	-40° to 105° C	-20° to 105° C	-40° to 105° C
	-40° to 221° F	-4° to 221° F	-40° to 221° F

Mating Cycles (no load)

Silver Plated Contacts	-	1,500	-
Gold Plated Contacts	-	-	1,500

Contact Retention Force	-	> 50 lbf / 222 N	-
-------------------------	---	------------------	---

Insertion Force	-	28 lbf	
-----------------	---	--------	--

Touch Safe (IEC 60529)	-	IP10	-
------------------------	---	------	---

Drop Test (UL50E)	Pass	-	-
-------------------	------	---	---

Panel Break Off (EIA 394-97)	Pass	-	-
------------------------------	------	---	---

Crush Test (EIA 364-40B)	Pass	-	-
--------------------------	------	---	---

Materials

Shell / Housing	PC/PBT	PC	PC/PBT
-----------------	--------	----	--------

Powerpole® Holder	PC/PBT	-	-
-------------------	--------	---	---

Latch	Stainless Steel	-	-
-------	-----------------	---	---

Flammability (UL 94)	V0	V0	V0
----------------------	----	----	----

Weatherability (UL 764C)	F1	F1	F1
--------------------------	----	----	----

Contacts

Base	-	Copper Alloy	Copper Alloy
Plating	-	Silver	Gold over Nickel

NOTES:

1. Integral signal holders that holds up to 8 pins and 8 sockets.
2. Based on 6 AWG.
3. Based on 6 AWG 1-1/4" distance between probes.
4. Based on 20 AWG.
5. Hot Plug testing completed using individual Powerpole® housings and contacts, not installed in SPEC Pak® shells.

Product Selection Guide

SPEC Pak® is a highly configurable environmentally sealed connector, that can be purchased as components in bulk for volume production, or pre-packaged as a kit. For convenience, follow the steps below to determine component or kit part numbers.

| COMPONENT PART NUMBER GUIDE (FOR COMPONENT BULK PURCHASE) |

Step 1: Select Shell

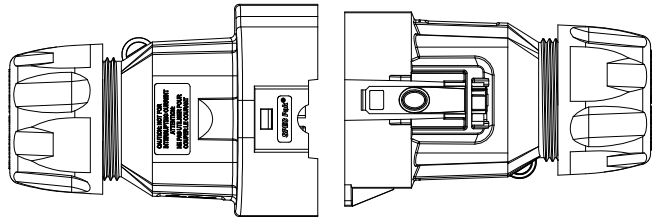

SK6-076C04
Plug

SK1-076C04
Inline Receptacle

* Select Shell Style,
from page 6.

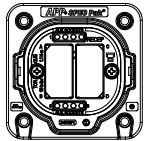

SK2-076C04
Panel Mount Receptacle

Step 2: Select Wire Protection



- * Define:

	<u>Number of Wires</u>	<u>Wire OD</u>
Wires		
- Discrete	_____	_____
- Bundled	_____	_____
- * Select wire protection that will accommodate the number of wires and outer diameter (OD) of the wire used in your application, from page 6.
- * Wire protection is required for use with inline receptacles and plugs to obtain IP68 seal.

List Component Part Numbers Here:

| KIT PART NUMBER GUIDE (FOR KITTED CONNECTOR PURCHASE) |

Step 1 - (see page 6)

..... Shell					
SPEC Pak® Series	Shell Color	Shell Style (Select One)	Dash	Shell Size	Insert Arrangement
<div></div>	<div></div>	<div>1 = Inline Receptacle 2 = Panel Mount Receptacle 6 = Straight Plug 9 = Receptacle Cover 9P = Plug Cover</div>	<div></div>	<div></div>	<div></div>

List Kit Part Number Here:

Receptacle Kit Part Number:

S K _____ - 076 C04

Plug Kit Part Number:

S K _____ - 076 C04

Step 3: Select Housing Arrangement

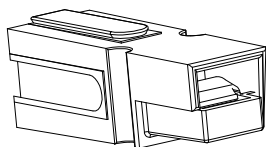

* Define:

	Number of Wires	Number of Auxiliaries
Housing Arrangement		
- AC Single Phase		
- AC 3 Phase		
- DC		
- Other		

* Select housing arrangement colors appropriate for your AC or DC application, from page 7.

List Component Part Numbers Here:

Step 4: Select Contacts

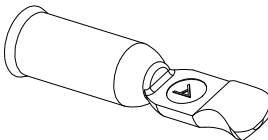

Power Contact



Pin Auxiliary Contact



Socket Auxiliary Contact

* Define:

	Number of Circuits	Wire Gauge
Contacts		
- Power		
- Auxiliary		
- Other		

Amps (continuous): ____ Max amps at ____ volts

* Select power and/or auxiliary contacts appropriate for your wire size (AWG or mm²), from page 7.

Step 2 - (see page 6)

..... Wire Protection
Number of Holes Cable Sealing Range
(Select Two) Dash

00 = None
PS = Plastic Single-hole
PM = Plastic Multi-hole

00 = None
01 - 99 = Various Gland Types
(See Page 6)

NOTE: Panel Mount Receptacle is always "00 00".

Step 3 - (see page 7)

.. Housing Arrangement ..
(Select One)

0 = Custom Configuration
A = AC Single Phase
B = AC 3 Phase, 3 Wire
C = DC Circuit, 4 Wire
Z = All Black

Step 4 - (see page 7)

..... Contacts
(Select One) Dash

0 = Custom Configuration
70 = 1307 Contact for #6 AWG (13.3 mm²)
71 = Please inquire for #8 AWG (8.4 mm²)
72 = 5953 Contact for #10/12 AWG (3.3 to 5.3 mm²)

Custom

.... APP Content

Contact the factory
Custom Configuration

Ordering Information

PLUG SHELL KIT

Part Number & Description

SK6-076C04

- Plug shell
- Powerpole® holder - plug
- Powerpole® holder retaining screws M3.5 x 15mm
- Sealing Gland Nut
(Sealing grommet sold separately)

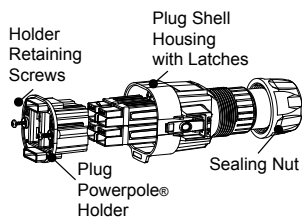

PANEL MOUNT RECEPTACLE KIT

Part Number & Description

SK2-076C04

- Panel mount receptacle shell
- Powerpole® holder - receptacle
- Panel mount receptacle gasket
- Powerpole® holder retaining screws M3.5 x 15mm

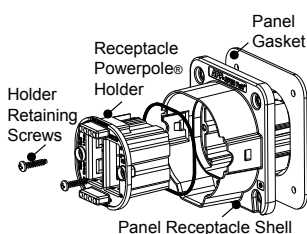

INLINE RECEPTACLE KIT

Part Number & Description

SK1-076C04

- Inline receptacle shell
- Powerpole® holder - receptacle
- Powerpole® holder retaining screws M3.5 x 15mm
- Sealing Gland Nut
(Sealing grommet sold separately)

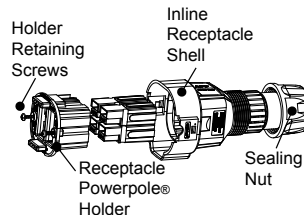

COVER KIT

Part Number & Description

SK9-076

- Receptacle Cover Kit
- Cover (IP68) with lanyard

SK9P-076

- Plug Cover Kit
- Cover (IP68) with lanyard

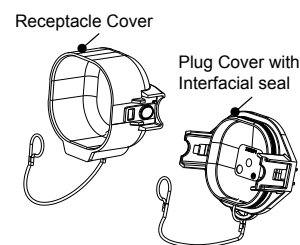

Component Replacement Parts

Part Number	Description
115129P1	Panel Mount Receptacle Gasket
H1120P53	Powerpole holder retaining screws M3.5 x 15mm

NOTE:

Mounting Hardware (4 each M4 or #8 screws) not included.
Recommended torque for mounting hardware is 7-10 in-lbs.

WIRE PROTECTION - CABLE GLAND

Material	
Shell	PBT/PC
Sealing Grommet	EPDM
Flammability (UL 94)	V0
Weatherability (UL 764C)	F1
Color	Black

Mechanical	
IP Rating	IP68
Operating Temperature (UL 1977)	-40° to 105° C -40° to 221° F
Thread Type	Integrated into inline receptacle & plug shells

Torque Requirements
Hand tighten. Using a 44 mm wrench or strap wrench, tighten an additional 3/4 - 1 turn.

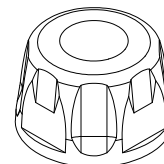

Wire Protection

Straight Plastic Single & Multi Hole Cable Gland

Number of Holes	Cable Range Wire Outer Diameter mm (in)	Wrench Size Sealing Nut	Protection Designation	Sealing Glands	
				Sealing Grommet Only	(includes sealing grommet & wire protection nut)
Minimum Quantity				10	10
1	18.0 - 24.0 mm (0.79" - 0.85")	44	PS	01	For use with SK1-076C04 & SK6-076C04
2	3.8 - 5.0mm (0.15" - 0.20")	44	PM	21	PS1T40-24X
2	6.0 - 7.2mm (0.24" - 0.28")	44	PM	22	PS2T40-5X
2	7.0 - 9.0mm (0.28" - 0.35")	44	PM	23	PS2T40-7X
					PS2T40-9X
3	6.0 - 7.2mm (0.24" - 0.28")	44	PM	32	PS3T40-7X
3	7.0 - 9.0mm (0.28" - 0.35")	44	PM	33	PS3T40-9X
4	3.8 - 5.0mm (0.15" - 0.20")	44	PM	41	PS4T40-5X
4	6.0 - 7.2mm (0.24" - 0.28")	44	PM	42	PS4T40-7X
4	7.0 - 9.0mm (0.28" - 0.35")	44	PM	43	PS4T40-9X

For use with shell kit components purchased in bulk.

C04 Housing Arrangement

Configured with up to 4 PP75 Contacts - Up to 80 Amps

| Standard Housing Arrangements |

E = Empty

0	Custom Configuration	
A	AC Single Phase	
	5916G4	5916G5
B	AC 3 Phase, 3 Wire	
	5916G4	5916G5
C	DC 2 Circuit, 4 Wire	
	5916G4	5916G4
Z	All Black	
	5916G4	5916G4

| TEMPERATURE CHART |

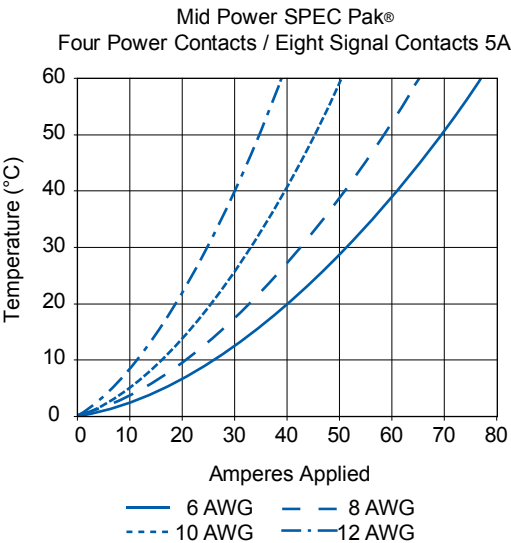

Ordering Information

PP75 Standard Power Contacts, Signal Contacts & Housings

Description	----- Part Number -----	
Minimum Quantity ..	1000	100
Red	5916G7-BK	5916G7
Green	5916G6-BK	5916G6
Black	5916G4-BK	5916G4
White	5916G5-BK	5916G5
Blue	5916-BK	5916
Yellow	5916G15-BK	5916G15
Orange	5916G14-BK	5916G14
Gray	5916G16-BK	5916G16

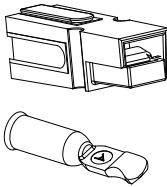

Spacer & Keying Accessory

Description	----- Part Number -----	
Minimum Quantity	1000	100
Red, Short	1399G23-BK	1399G23
Red, Long	1399G21-BK	1399G21

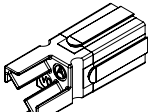
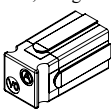

PP75 Silver Plated Wire Contacts

Type	AWG	mm ²	Mating Force	-- Part Numbers --		Contact Code Designation	Hand Tool	Pneumatic		
							Tool	Tool	Die	Locator
Minimum Quantity				1000	100	For use with 6 AWG			
Individual 6		13.3	Low	1307-BK	1307	70.....	1309G4	1387G1	1388G6	1389G6
Individual 8		8.4	Low	Please inquire		71.....			
Individual 12 to 10		3.3 to 5.3	Low	5953-BK	5953	72.....	For use with 12/10 AWG			
							1309G4	1387G1	1388G7	1389G6

Auxiliary Contacts (PowerMod® series)

Type	AWG	mm²	---- Part Number ---		
Minimum Quantity.....			500	50
Standard Length 7.7mm					
Pin	24 to 20	0.50 to 0.75	PM16P2024S30	PM16P2024S30-50	
Pin	20 to 18	0.75 to 1.00	PM16P1620S30	PM16P1620S30-50	
Pin	16 to 14	1.00 to 1.5	PM16P1416S30	PM16P1416S30-50	
Pin	12	2.50	PM16P12S30	PM16P12S30-50	
Pre-Mate 9.3mm					
Pin	24 to 20	0.50 to 0.75	PM16P2024A30	PM16P2024A30-50	
Pin	20 to 18	0.75 to 1.00	PM16P1620A30	PM16P1620A30-50	
Pin	16 to 14	1.00 to 1.5	PM16P1416A30	PM16P1416A30-50	
Pin	12	2.50	PM16P12A30	PM16P12A30-50	
Post-Mate 6.4mm					
Pin	24 to 20	0.50 to 0.75	PM16P2024C30	PM16P2024C30-50	
Pin	20 to 18	0.75 to 1.00	PM16P1620C30	PM16P1620C30-50	
Pin	16 to 14	1.00 to 1.5	PM16P1416C30	PM16P1416C30-50	
Pin	12	2.50	PM16P12C30	PM16P12C30-50	

Socket	24 to 20	0.25 to 0.50	PM16S2024S32	PM16S2024S32-50	
Socket	20 to 16	0.50 to 1.30	PM16S1620S32	PM16S1620S32-50	
Socket	16 to 14	1.30 to 2.10	PM16S1416S32	PM16S1416S32-50	
Socket	12	2.5	PM16S12S32	PM16S12S32-50	

Hand Tool	Hand		Pneumatic	
	Tool	Locator	Tool	Locator
For use with pins				
PM1000G1	TM0001	TL0001	TP0001	TL0001
For use with sockets				
PM1000G1	TM0001	TL0002	TP0002	TL0002

Dimensions

| PLUG MID POWER FOR PP75 HOUSINGS |

Top View

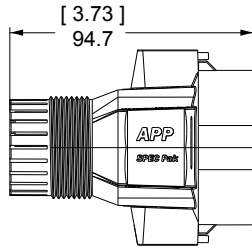

Front View

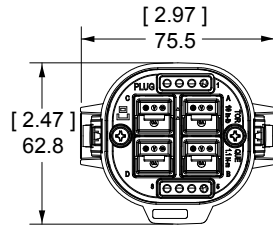

Side View

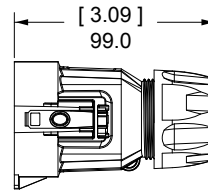

Mated View

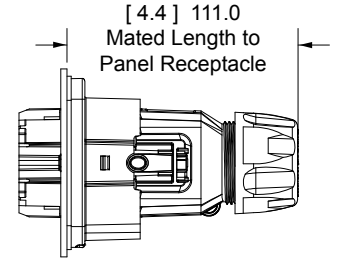

| PANEL MOUNT RECEPTACLE MID-POWER FOR PP75 |

Panel Cut Out

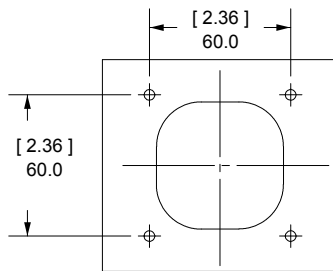

Front View

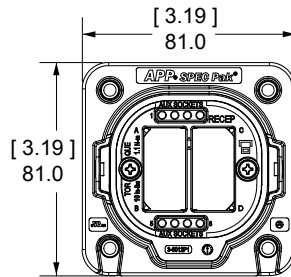

Side View

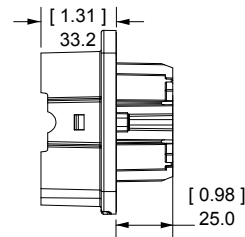

Mated View

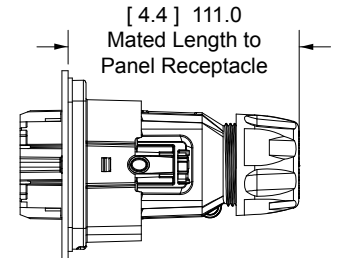

| INLINE RECEPTACLE MID-POWER FOR PP75 |

Top View

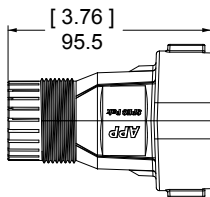

Front View

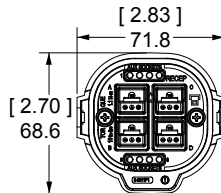

Side View

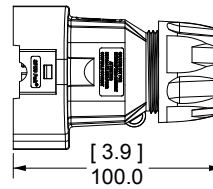

Mated View

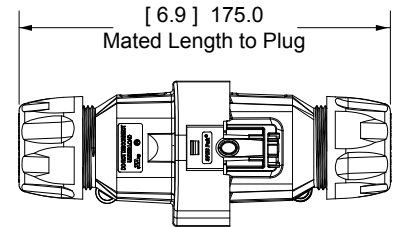

| PLUG COVER KIT |

Front View

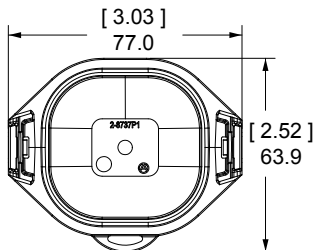

Side View



| RECEPTACLE COVER KIT |

Front View

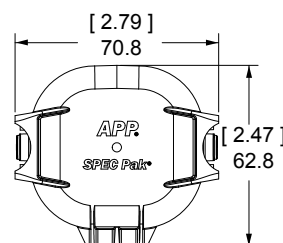

Side View

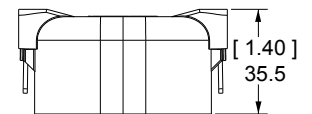

Mouser Electronics

Authorized Distributor

Click to View Pricing, Inventory, Delivery & Lifecycle Information:

[Anderson Power Products:](#)

[SK1-076C04](#) [SK6-076C04](#) [PS2T40-5X](#) [PS4T40-9X](#) [PS2T40-7X](#) [PS2T40-9X](#) [P5916G15-BK](#)