

## 6GHz 2-way Wilkinson Power Divider

**PDW06398**

### DESCRIPTION

DLI's 6GHz 2-way power divider / combiner offers unmatched size and performance in a surface mount configuration. This power divider utilizes DLI's low loss temperature stable materials which offer small size and minimal performance variation over temperature.

### FEATURES

- Small Size
- Frequency Stable over Temperature
- Solder Surface Mount Package
- Excellent Repeatability
- Moisture Sensitivity Level: MSL1
- Operating & Storage Temp: -55°C to +125°C
- Characteristic Impedance: 50Ω

### SPECIFICATIONS\*

Parameter	Frequency Range (GHz)	Min	Typ.	Max
Nominal Power Splitting (dB)	5-7		3.0	
Nominal Phase Shift (Deg)			0.0	
Amplitude Balance (dB)				± .25
Phase Balance (Deg)				± 5.0
Excess Insertion Loss (dB)				0.25
Return Loss (dB)		14	20	
Isolation (dB)		14		
Input Power (W)				TBD

\*Electrical specifications based on typical probed performance at room temperature. Insertion loss shall vary ±0.5dB over temperature.

### Typical Measured Performance

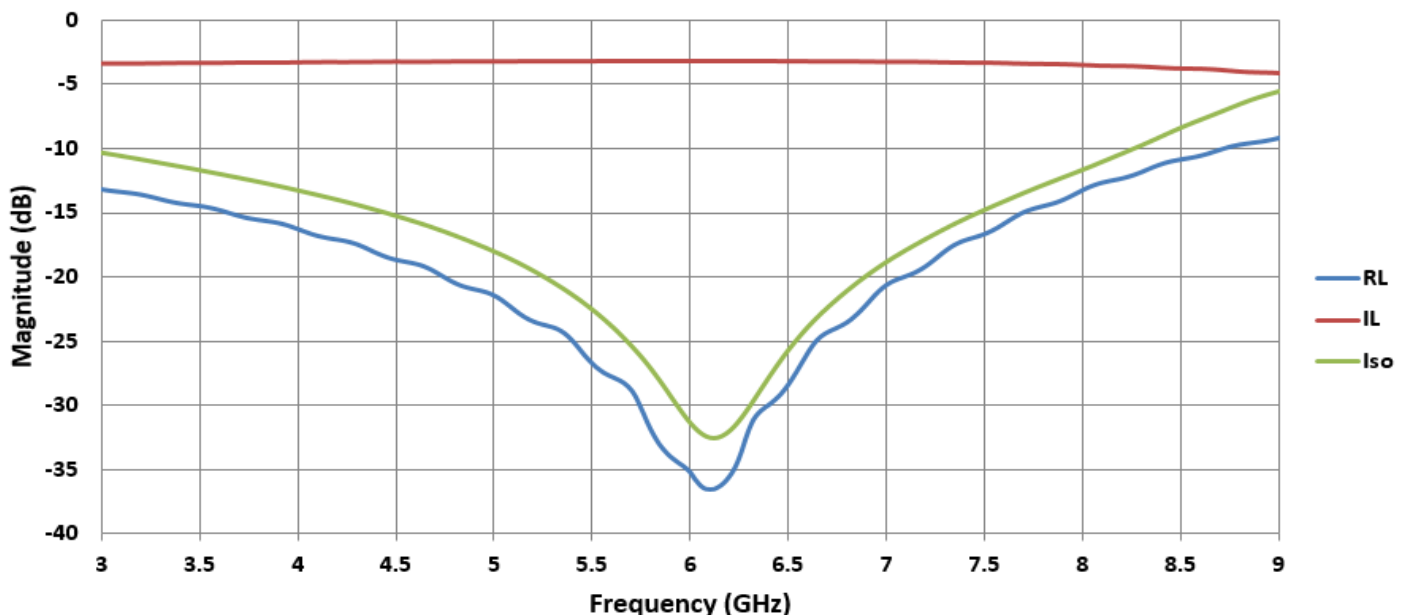

## 6GHz 2-way Wilkinson Power Divider

**PDW06398**

COMPLEX • DLI • JOHANSON MFG  
NOVACAP • SYFER • VOLTRONICS  
[www.knowlescapacitors.com](http://www.knowlescapacitors.com)

### Physical Dimensions

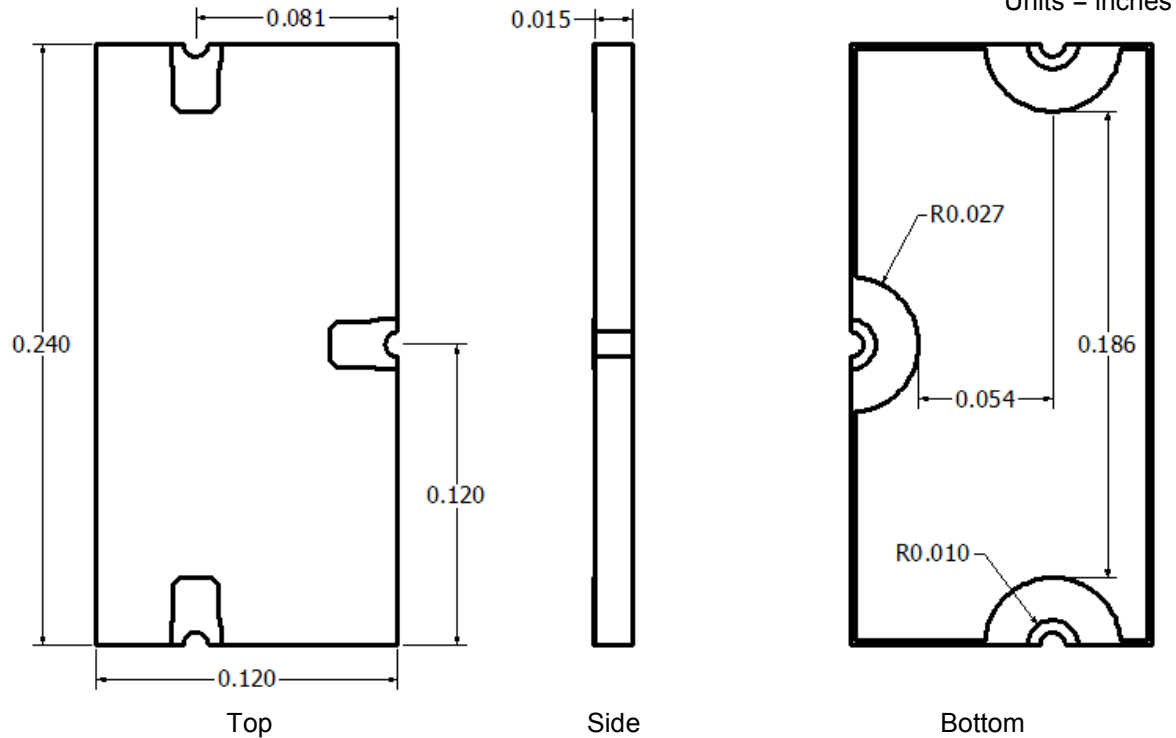

### Recommended PCB Layout

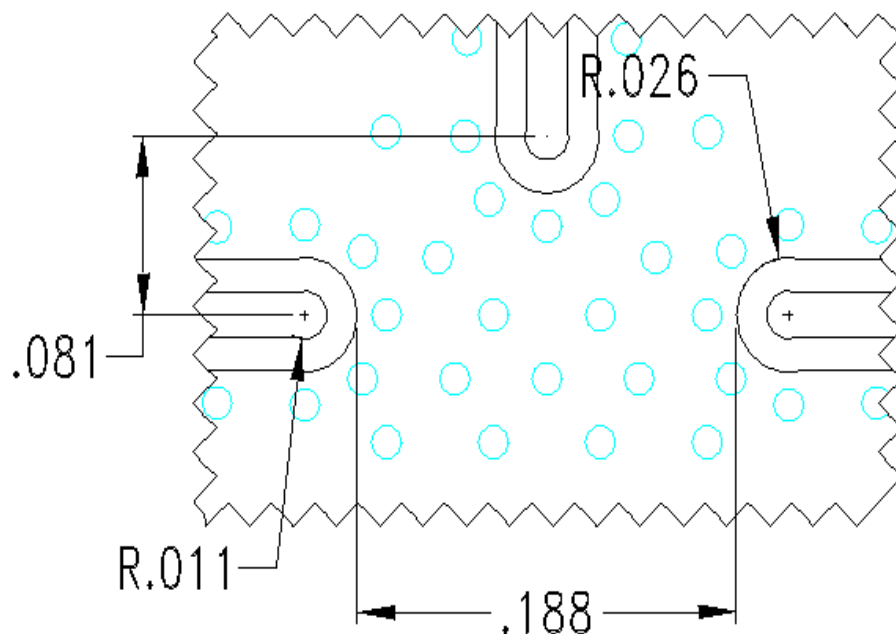

- 50Ω trace dimensions are application specific.
- Ensure adequate grounding beneath the part.



# Mouser Electronics

Authorized Distributor

Click to View Pricing, Inventory, Delivery & Lifecycle Information:

Knowles:

[PDW06398](#) [PDW06398-T](#)