

# MOUNTING DETAIL

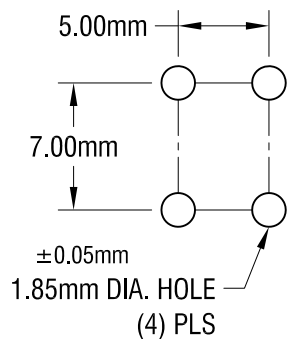

THIS DOCUMENT IS THE PROPERTY OF KEYSTONE ELECTRONICS CORP. AND SHALL NOT BE REPRODUCED, DISTRIBUTED OR USED AS A BASIS FOR MANUFACTURE WITHOUT PRIOR WRITTEN PERMISSION FROM KEYSTONE ELECTRONICS CORP.

# ACTUAL SIZE

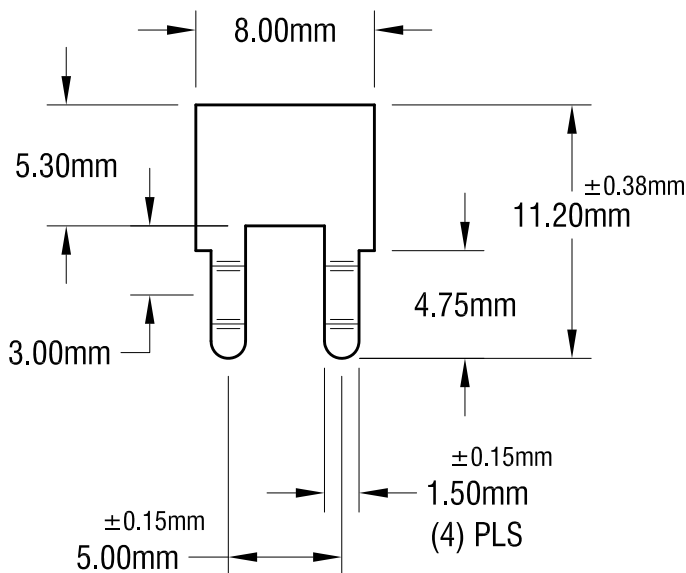
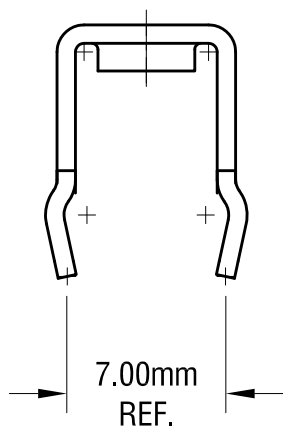
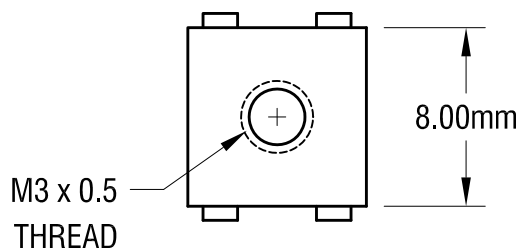
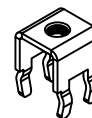

11.16.23	CHANGE AS PER ECN 23-216	G
12.15.17	CHANGE AS PER ECN 17-077	F
9.27.16	CHANGE AS PER ECN16-089	E
6.18.16	CHANGE AS PER ECN16-070	D
3.26.15	CHANGE AS PER ECN15-039	C
7.15.09	CHANGE AS PER ECN 09-104	B
1.31.08	CHANGE AS PER ECN 089-068	A
DATE	DESCRIPTION	REV.

## NOTE:

1. ALL DIMENSIONS ARE IN MILLIMETERS.

## KEYSTONE ELECTRONICS CORP.

www.keyelco.com • ASTORIA, N.Y. 11105-2017 • Tel (718) 956-8900

PART NAME

PC METRIC SCREW TERMINAL

MATERIAL

0.8mm TH'K BRASS

FINISH

MATTE TIN PLATE

DRN BY

BOONE

DATE

9.28.01

APP'D

RH

SCALE

3X

TOLERANCES

INCH

[MM]

DECIMAL

±

[± 0.25 ]

ANGULAR ± 1°

UNLESS OTHERWISE SPECIFIED

CODE

DWG NO.

C

7788

# Mouser Electronics

Authorized Distributor

Click to View Pricing, Inventory, Delivery & Lifecycle Information:

[Keystone Electronics:](#)

[7788](#)