

ACTUAL SIZE

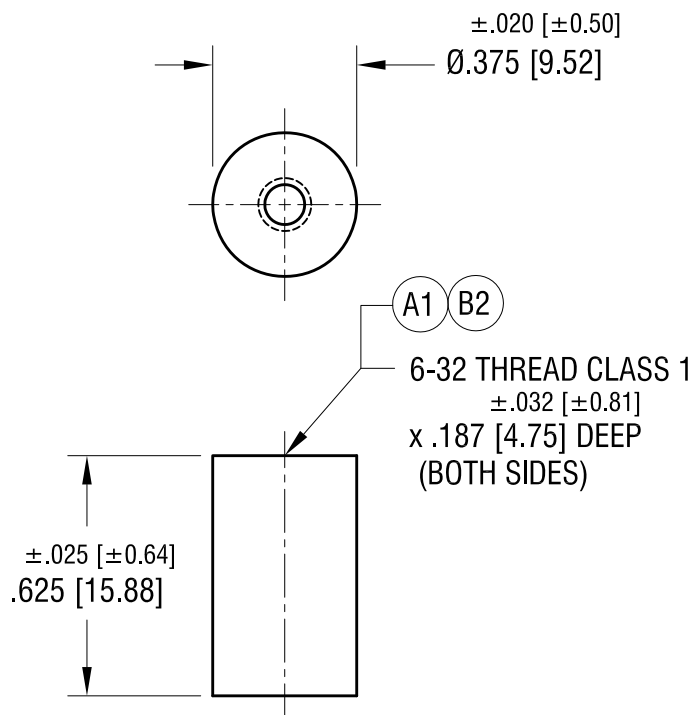

NOTE:

1. MARKED WITH NL #: NL523W01-005

3.30.22	(B1) WAS .187±.020 DEEP CHANGE AS PER ECN 22-064	B
3.11.22	HOLE DEPTH A1 WAS .250 CHANGE AS PER ECN 22-057	A
DATE	DESCRIPTION	REV.

KEYSTONE ELECTRONICS CORP.			
www.keyelco.com • NEW HYDE PARK NY 11040 • Tel (516)328-7500			
PART NAME			
CERAMIC STANDOFF			
MATERIAL			
GRADE L5 CERAMIC			
FINISH		DRN BY	DATE
GLAZED		BOONE	2.09.98
		APP'D	SCALE
		RH	2 X
TOLERANCES		INCH	[MM]
DECIMAL		± .005	[± 0.13]
ANGULAR		± 1°	
UNLESS OTHERWISE SPECIFIED		CODE	DWG NO.
		C	7662

Mouser Electronics

Authorized Distributor

Click to View Pricing, Inventory, Delivery & Lifecycle Information:

[Keystone Electronics:](#)

[7662](#)