

A technical drawing of a bolt and nut assembly. The bolt is shown in a perspective view, with its head on the left and its threaded shank extending to the right. A nut is threaded onto the end of the bolt. The nut has a hexagonal shape with a central opening. The drawing is a line drawing with no shading.

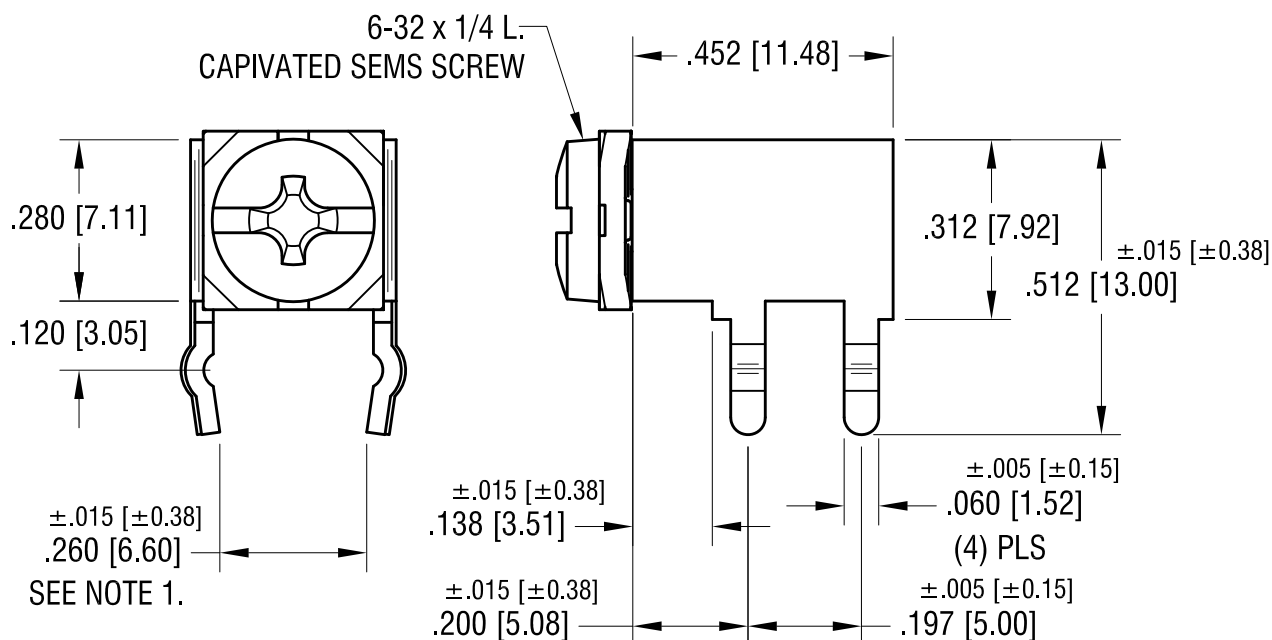
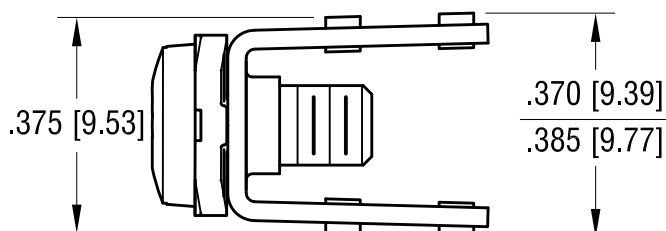

1. .260 [6.60] \pm .015 [\pm 0.38] DIMENSION
TO BE MEASURED AT END OF LEG,
NOT AT SEATING PLANE.

MAT'L - .032 [0.81] TH'K BRASS, MATTE TIN PLATE
COMBINATION SEMS SCREW:
MAT'L - STEEL, NICKEL PLATE

10.21.11	CHANGE AS PER ECN 11-136	A
DATE	DESCRIPTION	REV.

<h1>KEYSTONE ELECTRONICS CORP.</h1> <p>www.keyelco.com • ASTORIA, N.Y. 11105-2017 • Tel (718) 956-8900</p>			
PART NAME <h2>PC SCREW TERMINAL</h2>			
MATERIAL <h2>AS NOTED</h2>			
FINISH <h2>AS NOTED</h2>		DRN BY <h2>NT</h2>	DATE <h2>6.23.10</h2>
		APP'D <h2>LN</h2>	SCALE <h2>3X</h2>
TOLERANCES DECIMAL $\pm .010$ [± 0.25] ANGULAR $\pm 1^\circ$ UNLESS OTHERWISE SPECIFIED	INCH [MM] <h2>C</h2>	DWG NO. <h1>7692-SEMS</h1>	

Mouser Electronics

Authorized Distributor

Click to View Pricing, Inventory, Delivery & Lifecycle Information:

[Keystone Electronics:](#)

[7692-SEMS](#)