

# MOUNTING DETAIL

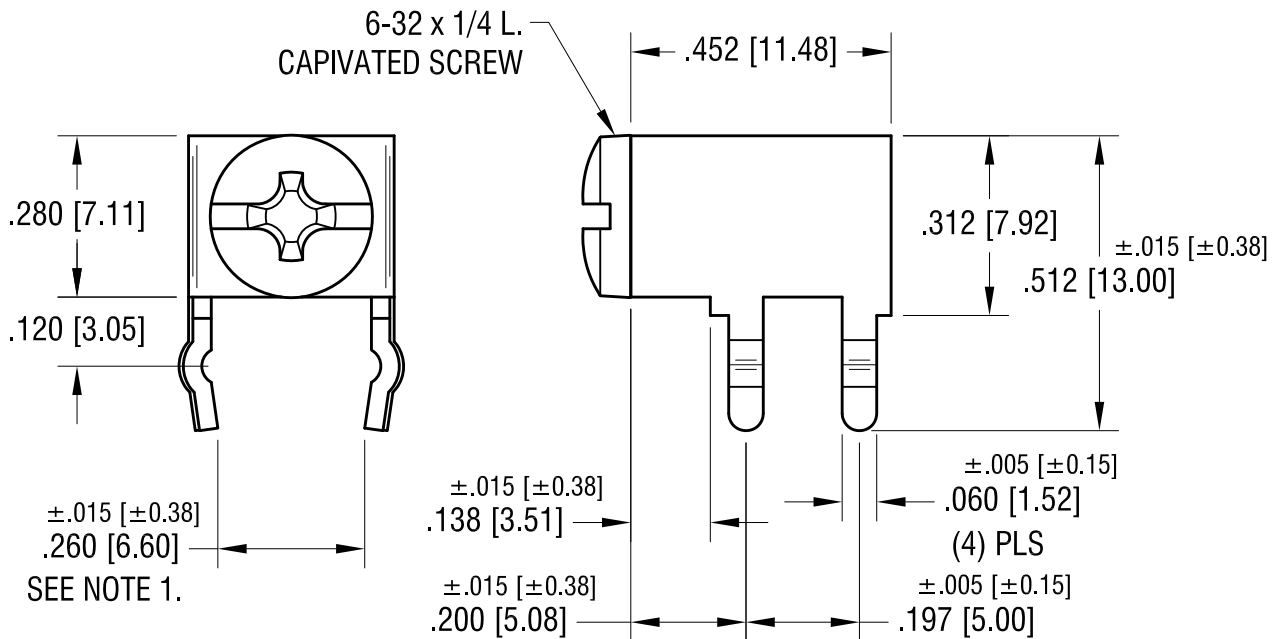
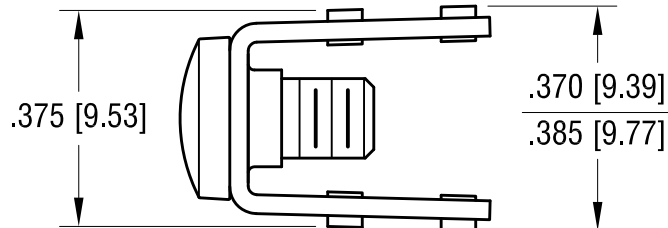
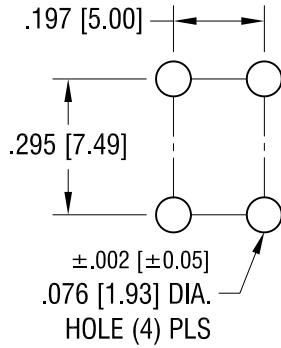

## NOTE:

1. .260 [6.60] ±.015 [±0.38] DIMENSION  
TO BE MEASURED AT END OF LEG,  
NOT AT SEATING PLANE.
2. TERMINAL:  
MAT'L - .032 [0.81] TH'K BRASS, MATTE TIN PLATE  
SCREW:  
MAT'L - BRASS, NICKEL PLATE

|          |                           |      |
|----------|---------------------------|------|
| 6.24.10  | CHANGED AS PER ECN 10-044 | L    |
| 12.27.07 | CHANGE AS PER ECN 07-090  | K    |
| DATE     | DESCRIPTION               | REV. |

| KEYSTONE ELECTRONICS CORP. |  |        |         |
|----------------------------|--|--------|---------|
| ASTORIA, N.Y. 11105-2017   |  |        |         |
| PART NAME                  |  |        |         |
| PC SCREW TERMINAL          |  |        |         |
| MATERIAL                   |  |        |         |
| AS NOTED                   |  |        |         |
| FINISH                     |  | DRN BY | DATE    |
| AS NOTED                   |  | BOONE  | 9.20.93 |
| TOLERANCES                 |  | APP'D  | SCALE   |
| DECIMAL                    |  |        | 3X      |
| ANGULAR                    |  |        |         |
| UNLESS OTHERWISE SPECIFIED |  | CODE   | DWG NO. |
| ±.010 [±0.25]              |  | C      | 7692    |

# Mouser Electronics

Authorized Distributor

Click to View Pricing, Inventory, Delivery & Lifecycle Information:

[Keystone Electronics:](#)

[7692](#)