

RATINGS:

CURRENT: 10 AMPS
BREAKDOWN VOLTAGE: 5700 V RMS
CONTACT RESISTANCE: 0.004 OHMS MAX.
CONTACT-TO-PANEL C: 2 pF NOMINAL

ACTUAL SIZE

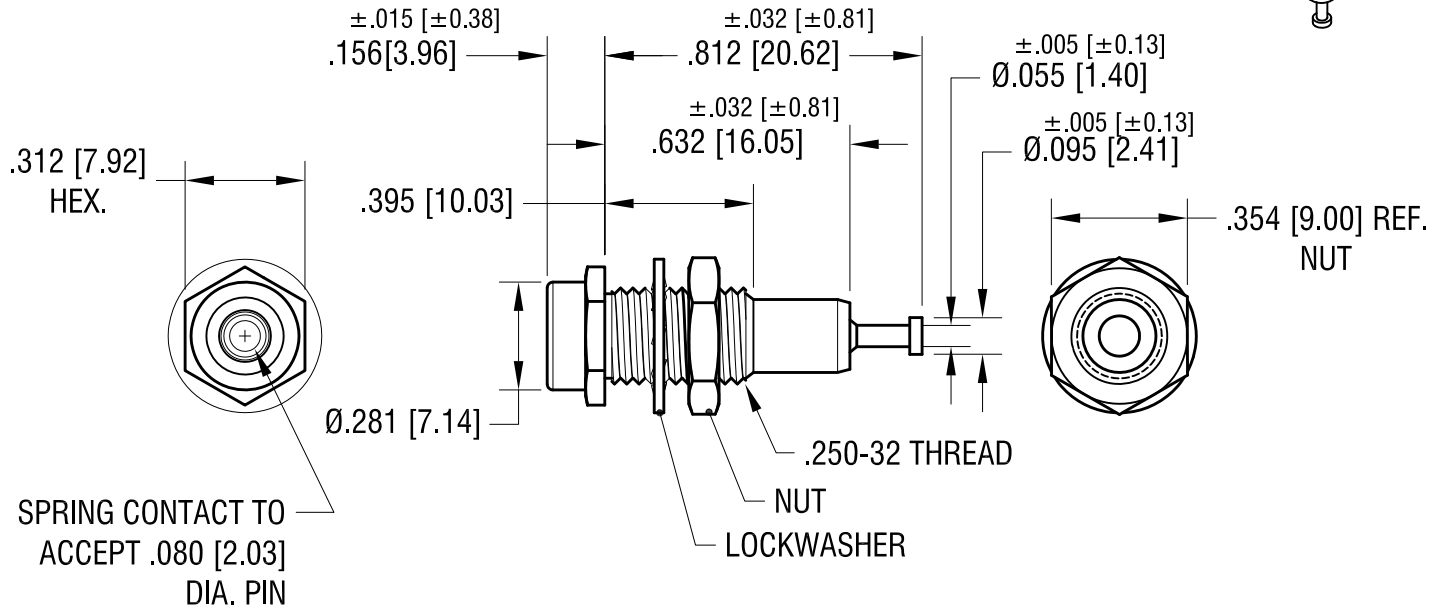
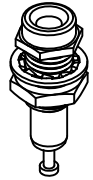

NOTES:

- CONTACT:
MAT'L - BRASS BODY WITH WRAP
AROUND BERYLLIUM COPPER
GOLD PLATE
- INSULATOR:
MAT'L - NYLON 6/6 PER ASTM D4066
- SHELL, NUT/WASHER:
BRASS, NICKEL PLATE.
HARDWARE SUPPLIED
UNASSEMBLED.

PART NO.	COLOR
6012	WHITE
6013	RED
6014	BLACK
6015	GREEN
6016	YELLOW
6017	BLUE

3.30.23	NUT WAS 8.71mm±0.15mm GENERAL TOLERANCE WAS ±.005 CHANGE AS PER ECN 23-041	B
2.05.03	CHANGE AS PER ECN 03-011	A
DATE	DESCRIPTION	REV.

KEYSTONE ELECTRONICS CORP.			
www.keyelco.com • NEW HYDE PARK NY 11040 • Tel (516)328-7500			
PART NAME			
INSULATED METAL-CLAD TIP JACK			
MATERIAL			
AS NOTED			
FINISH		DRN BY	DATE
AS NOTED		BOONE	12.07.82
		APP'D	SCALE
		RH	2X
TOLERANCES	INCH [MM]	CODE	DWG NO.
DECIMAL	±.010 [±0.25]	C	6012 - 6017
ANGULAR	± 1°		
UNLESS OTHERWISE SPECIFIED			

Mouser Electronics

Authorized Distributor

Click to View Pricing, Inventory, Delivery & Lifecycle Information:

[Keystone Electronics:](#)

[6013](#)