

ACTUAL SIZE

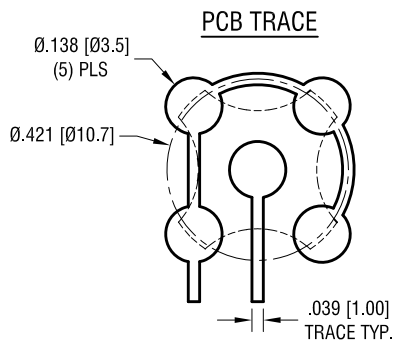

KEYPAD DOMES ARE DESIGNED
TO BE PLACED ON PCB, NOT SOLDERED

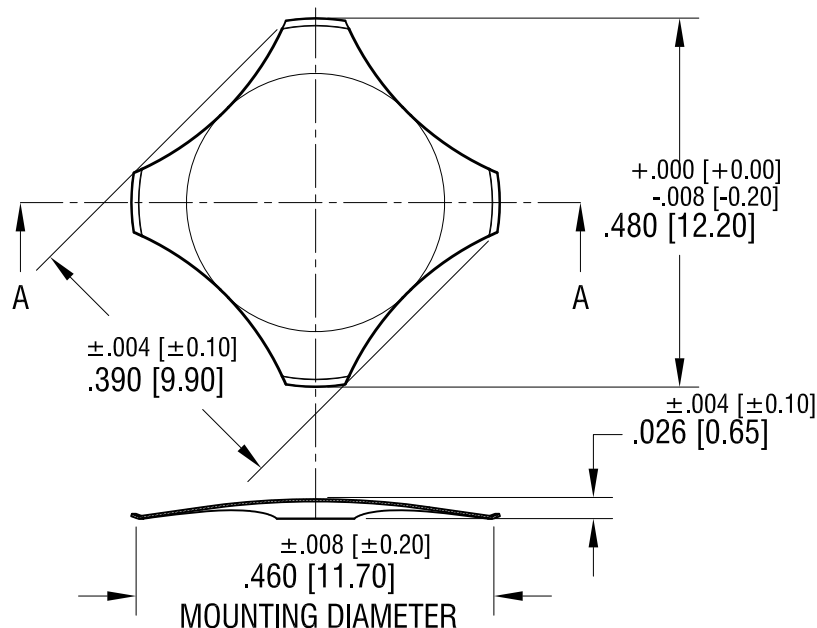

NOTE:

1. VOLTAGE/CURRENT MAXIMUM: 12mA@ 24 Volts DC
2. OPERATING TEMPERATURE: -40°F [-40°C] TO 220°F [105°C]
3. STORAGE TEMPERATURE: -65°F [-55°C] TO 250°F [125°C]
4. TRIP FORCE: 220g

KEYSTONE ELECTRONICS CORP.

www.keyelco.com • NEW HYDE PARK NY 11040 • Tel (516)328-7500

PART NAME

4 LEG DOME, 12.2 mm

MATERIAL

.003 [0.08] TH'K STAINLESS STEEL

FINISH

NICKEL PLATE

DRN BY

NT

DATE

3.30.17

APP'D

RH

SCALE

5X

TOLERANCES

INCH [MM]

DECIMAL

±.005 [±0.13]

ANGULAR

± 1°

UNLESS OTHERWISE SPECIFIED

CODE

C

DWG NO.

5173

7.01.22 SUPPLIED IN BULK WAS SUPPLIED
IN TUBE
CHANGE AS PER ECN 22-108

A

REV.

DATE

DESCRIPTION

Mouser Electronics

Authorized Distributor

Click to View Pricing, Inventory, Delivery & Lifecycle Information:

[Keystone Electronics:](#)

[5173](#)