

THIS DOCUMENT IS THE PROPERTY OF
KEYSTONE ELECTRONICS CORP. AND
SHALL NOT BE REPRODUCED, DISTRIBUTED
OR USED AS A BASIS FOR MANUFACTURE
WITHOUT PRIOR WRITTEN PERMISSION
FROM KEYSTONE ELECTRONICS CORP.

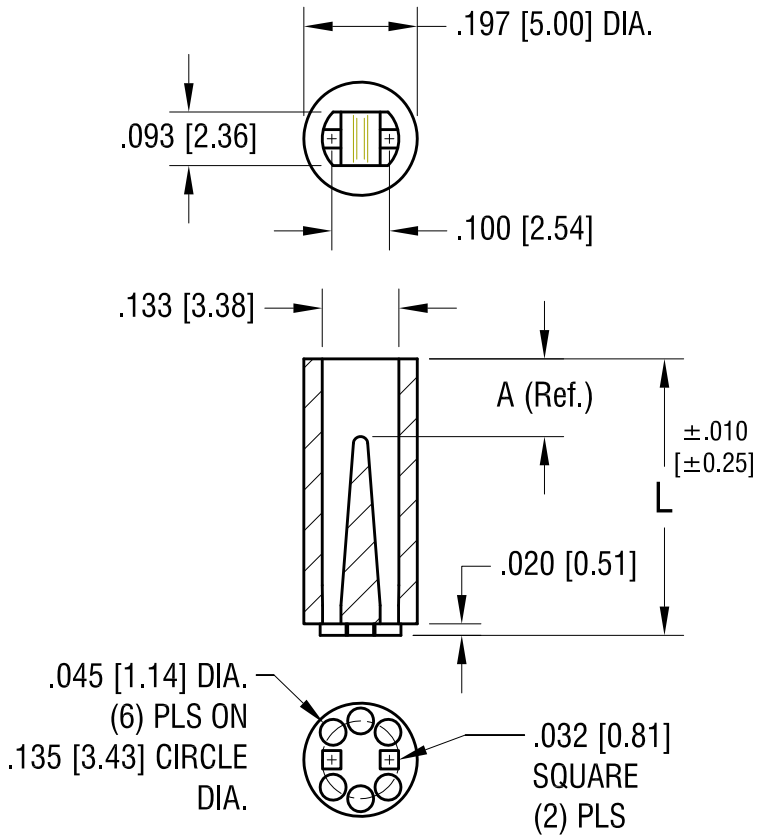

| PART NO. | 'L' DIM. | 'A' DIM. REF. |
|----------|-------------|---------------|
| 7351 | .120 [3.05] | .045 [1.14] |
| 7352 | .140 [3.56] | .065 [1.65] |
| 7353 | .160 [4.06] | .085 [2.16] |
| 7354 | .180 [4.57] | .105 [2.67] |
| 7355 | .200 [5.08] | .125 [3.18] |
| 7356 | .220 [5.59] | .145 [3.68] |
| 7357 | .240 [6.10] | .160 [4.06] |
| 7358 | .250 [6.35] | .060 [1.52] |
| 7359 | .260 [6.60] | .065 [1.65] |
| 7360 | .280 [7.11] | .090 [2.29] |
| 7361 | .300 [7.62] | .110 [2.79] |
| 7362 | .320 [8.13] | .120 [3.05] |
| 7363 | .340 [8.64] | .140 [3.56] |
| 7364 | .350 [8.89] | .150 [3.81] |
| 7365 | .360 [9.14] | .160 [4.06] |
| 7366 | .380 [9.65] | .060 [1.52] |

| DATE | DESCRIPTION | REV. |
|---------|--------------------------|------|
| 1.15.15 | CHANGE AS PER ECN 15-007 | C |
| 5.4.99 | CHANGE AS PER ECN 99-044 | B |
| 2.10.99 | CHANGE AS PER ECN 99-022 | A |

| KEYSTONE ELECTRONICS CORP. | | | |
|---|---|-----------------|----------------------|
| www.keyelco.com • ASTORIA, N.Y. 11105-2017 • Tel (718) 956-8900 | | | |
| PART NAME BI-LEAD LED SPACER, T-1 | | | |
| MATERIAL NYLON 6/6 | | | |
| FINISH - | | DRN BY BOONE | DATE 10.8.96 |
| | | APP'D LN | SCALE 3X |
| TOLERANCES DECIMAL ANGULAR | INCH [MM] $\pm .005$ [± 0.15] $\pm 1^\circ$ | CODE C | DWG NO. 7351-7366 |
| UNLESS OTHERWISE SPECIFIED | | | |

Mouser Electronics

Authorized Distributor

Click to View Pricing, Inventory, Delivery & Lifecycle Information:

[Keystone Electronics:](#)

[7361](#)