

BATTERY	'L'
CR123A	.144 [3.66] MAX.
18350	.197 [5.00] MAX.
18650 ★	1.58 [40.20] MAX.
17500	0.99 [25.20] MAX.

★ FOR BATTERIES WITH  
BUILT-IN CIRCUIT PROTECTION  
(67mm LONG)

THIS DOCUMENT IS THE PROPERTY OF  
KEYSTONE ELECTRONICS CORP. AND  
SHALL NOT BE REPRODUCED, DISTRIBUTED  
OR USED AS A BASIS FOR MANUFACTURE  
WITHOUT PRIOR WRITTEN PERMISSION  
FROM KEYSTONE ELECTRONICS CORP.

**ACTUAL SIZE**

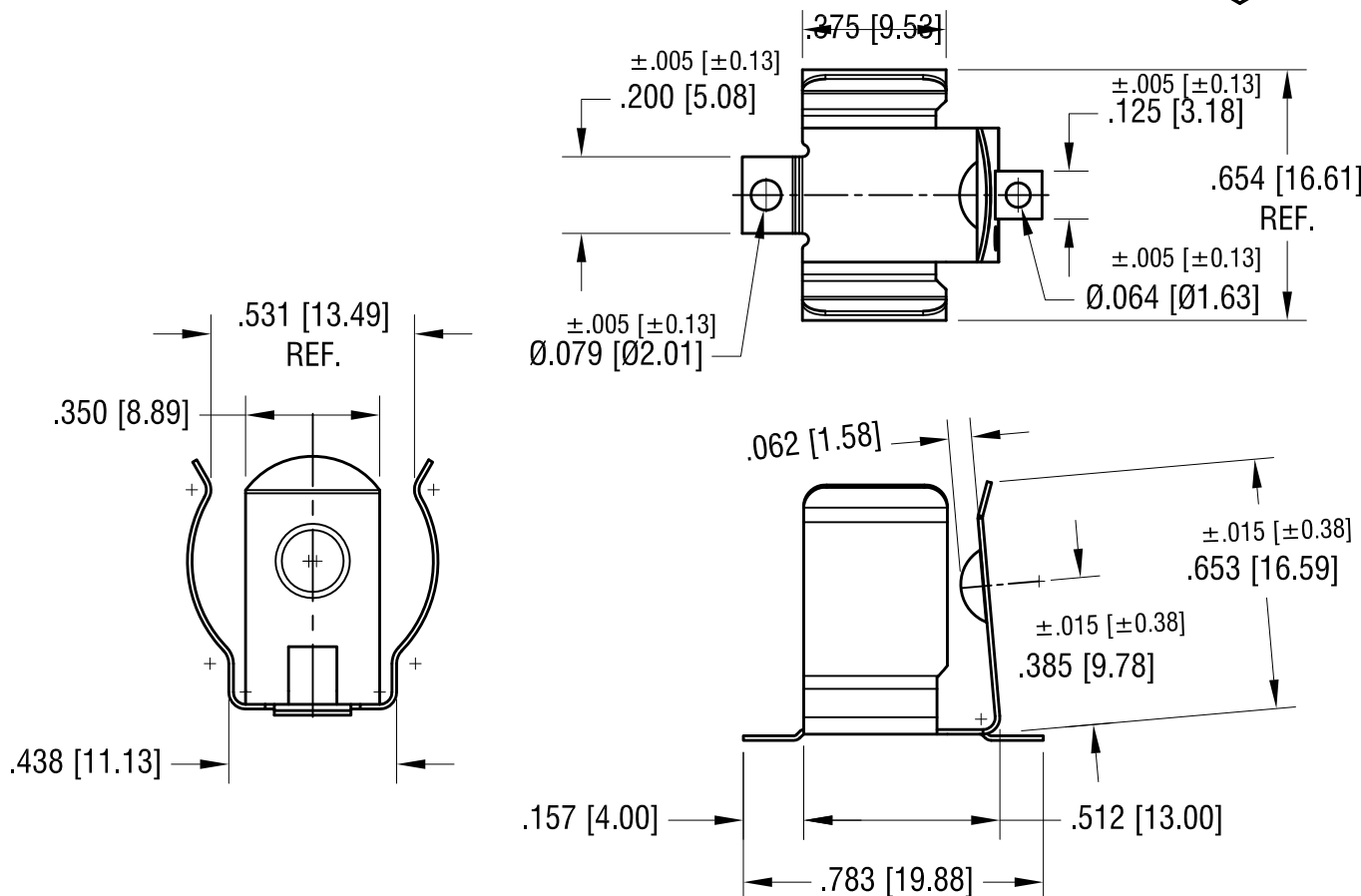
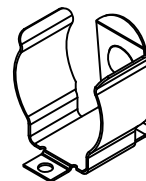

NOTE:

1. HEAT TREAT TO SPRING TEMPER

PCB PROTECTION CIRCUITS ARE REQUIRED  
WHEN USED WITH LITHIUM-ION BATTERIES

			<div>KEYSTONE ELECTRONICS CORP.</div> <div>www.keyelco.com • NEW HYDE PARK, NY 11040 • Tel (516) 328-7500</div>			
9.14.23	MTG. SOLDER CONTACTS REMOVED CHANGE AS PER ECN 23-154	C	PART NAME 16mm - 19mm SM BATTERY CLIP			
8.15.22	B1 WAS .060, ADD RELIEF B2 CHANGE AS PER ECN 22-141	B	MATERIAL .012 [0.30] TH'K ANNEALED SPRING STEEL			
6.14.21	REMOVE HOLE FOR WIRE CHANGE AS PER ECN 21-053	A	FINISH TIN NICKEL PLATE		DRN BY NT	DATE 1.17.18
					APP'D RH	SCALE 2X
			TOLERANCES INCH [MM] DECIMAL ± .010 [± 0.25] ANGULAR ± 2° UNLESS OTHERWISE SPECIFIED		CODE C	DWG NO. 254
DATE	DESCRIPTION	REV.				

# Mouser Electronics

Authorized Distributor

Click to View Pricing, Inventory, Delivery & Lifecycle Information:

[Keystone Electronics:](#)

[254](#)