

THIS DOCUMENT IS THE PROPERTY OF
KEYSTONE ELECTRONICS CORP. AND
SHALL NOT BE REPRODUCED, DISTRIBUTED
OR USED AS A BASIS FOR MANUFACTURE
WITHOUT PRIOR WRITTEN PERMISSION
FROM KEYSTONE ELECTRONICS CORP.

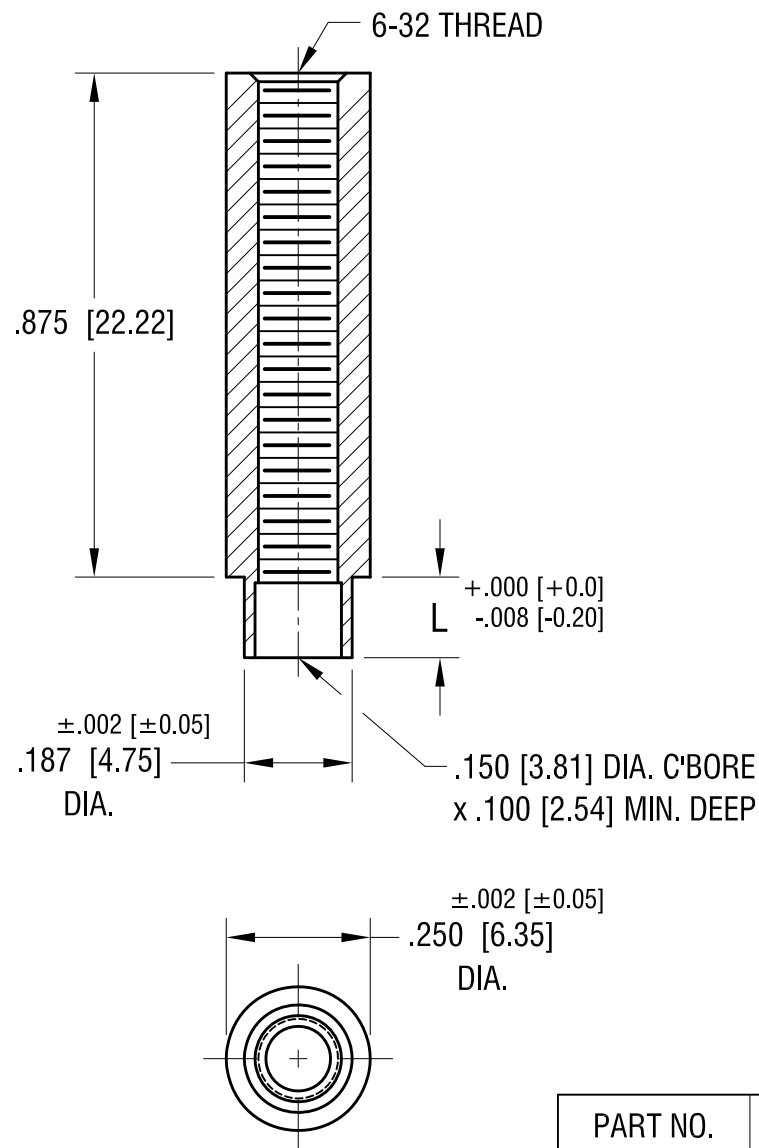

ACTUAL SIZE

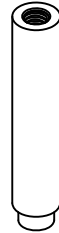

P/N 1796-2

PART NO.	'L' DIM.
1796-2	.109 [2.77]
1796-3	.140 [3.56]
1796-4	.171 [4.34]

11.22.21	CHANGE AS PER ECN 02-171	A
DATE	DESCRIPTION	REV.

KEYSTONE ELECTRONICS CORP.					
www.keyelco.com • NEW HYDE PARK NY 11040 • Tel (516)328-7500					
PART NAME					
SWAGE THREADED STANDOFF					
MATERIAL					
BRASS					
FINISH DUCTILE NICKEL PLATE		DRN BY	BOONE	DATE	5.14.02
		APP'D	LN	SCALE	3X
TOLERANCES INCH [MM]		CODE	DWG NO. 1796-		
DECIMAL ±.005 [±0.13]					
ANGULAR ± 1°					
UNLESS OTHERWISE SPECIFIED		C			

Mouser Electronics

Authorized Distributor

Click to View Pricing, Inventory, Delivery & Lifecycle Information:

[Keystone Electronics:](#)

[1796-3](#)