

ACTUAL SIZE

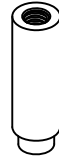

P/N 1605-2

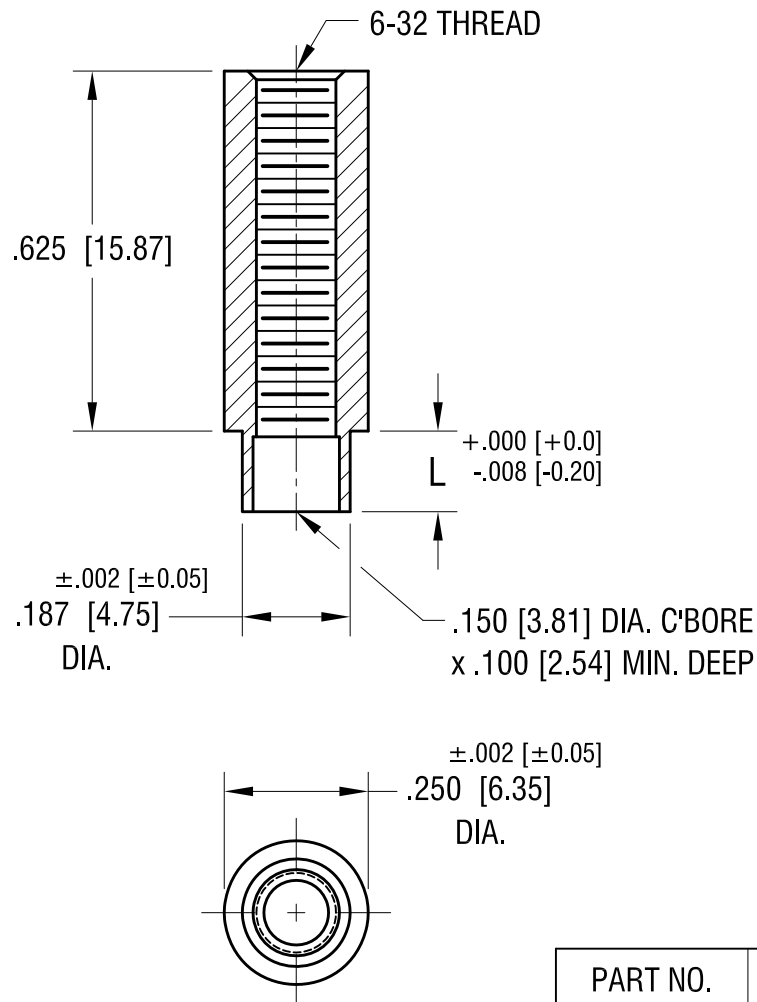

PART NO.	'L' DIM.
1605-2	.109 [2.77]
1605-3	.140 [3.56]
1605-4	.171 [4.34]

11.22.21	CHANGE AS PER ECN 02-170	A
DATE	DESCRIPTION	REV.

KEYSTONE ELECTRONICS CORP.			
www.keyelco.com • NEW HYDE PARK NY 11040 • Tel (516)328-7500			
PART NAME			
SWAGE THREADED STANDOFF			
MATERIAL			
BRASS			
FINISH	DUCTILE NICKEL PLATE	DRN BY	BOONE
		DATE	5.14.02
TOLERANCES	INCH [MM]	APP'D	LN
		SCALE	3X
DECIMAL	$\pm .005 [\pm 0.13]$	DWG NO.	
ANGULAR	$\pm 1^\circ$	1605-	
UNLESS OTHERWISE SPECIFIED		C	

Mouser Electronics

Authorized Distributor

Click to View Pricing, Inventory, Delivery & Lifecycle Information:

[Keystone Electronics:](#)

[1605-2](#)