

ACTUAL SIZE

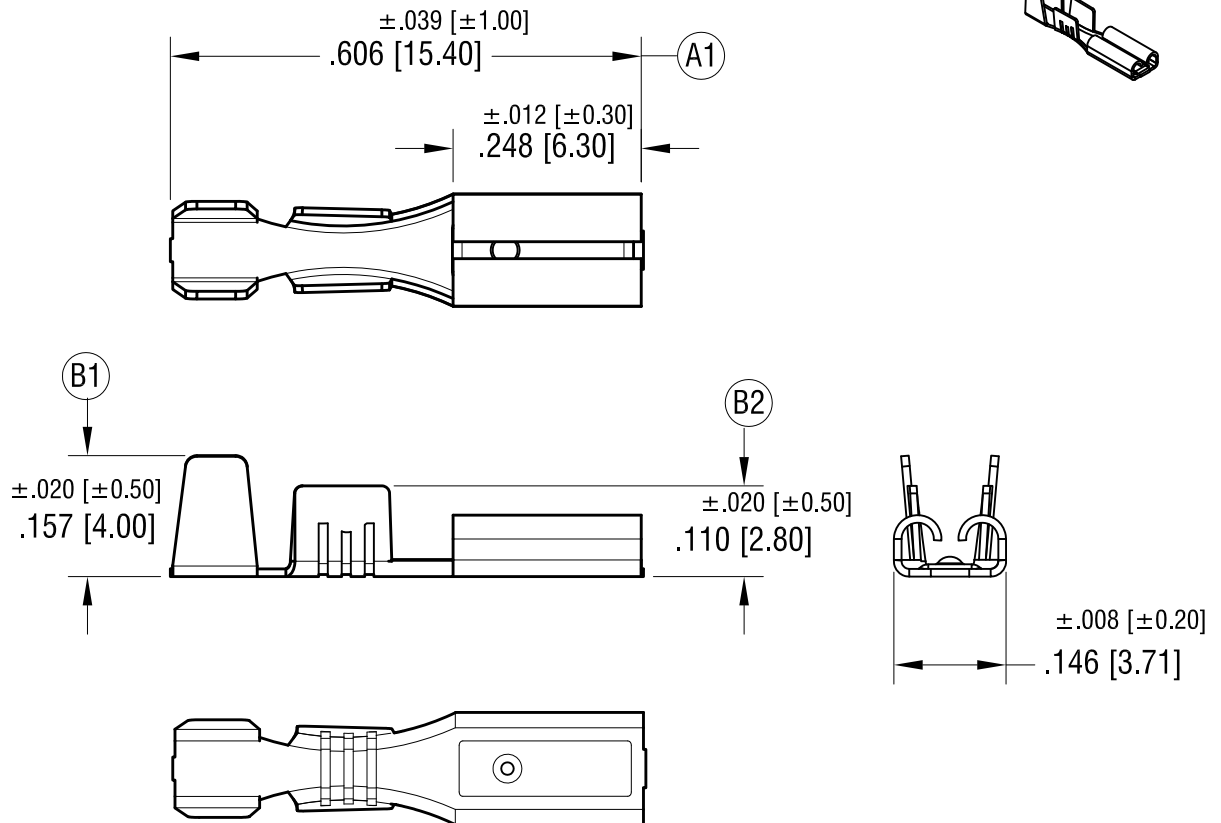

NOTES:

- DESIGNED FOR $.110$ [2.79] x $.020$ [0.51] TAB
- WIRE RANGE : 22-18 AWG

7.24.23	(B1) WAS $.130 \pm .012$, (B2) WAS $.110 \pm .012$ CHANGE AS PER ECN 23-125	B
12.01.14	(A1) WAS $.640$ [16.26], SPLIT C/M CHANGE AS PER ECN 14-116	A
DATE	DESCRIPTION	REV.

KEYSTONE ELECTRONICS CORP.			
www.keyelco.com • NEW HYDE PARK NY 11040 • Tel (516)328-7500			
PART NAME			
QUICK-FIT FEMALE TERMINAL			
MATERIAL			
.010 [0.25] TH'K BRASS			
FINISH		DRN BY	DATE
TIN PLATE		BOONE	10.08.99
		APP'D	SCALE
		RH	3X
TOLERANCES	INCH [MM]	CODE	DWG NO.
DECIMAL	± .010 [± 0.25]	C	1252
ANGULAR	± 1°		
UNLESS OTHERWISE SPECIFIED			

Mouser Electronics

Authorized Distributor

Click to View Pricing, Inventory, Delivery & Lifecycle Information:

[Keystone Electronics:](#)

[1252](#)