

ACTUAL SIZE

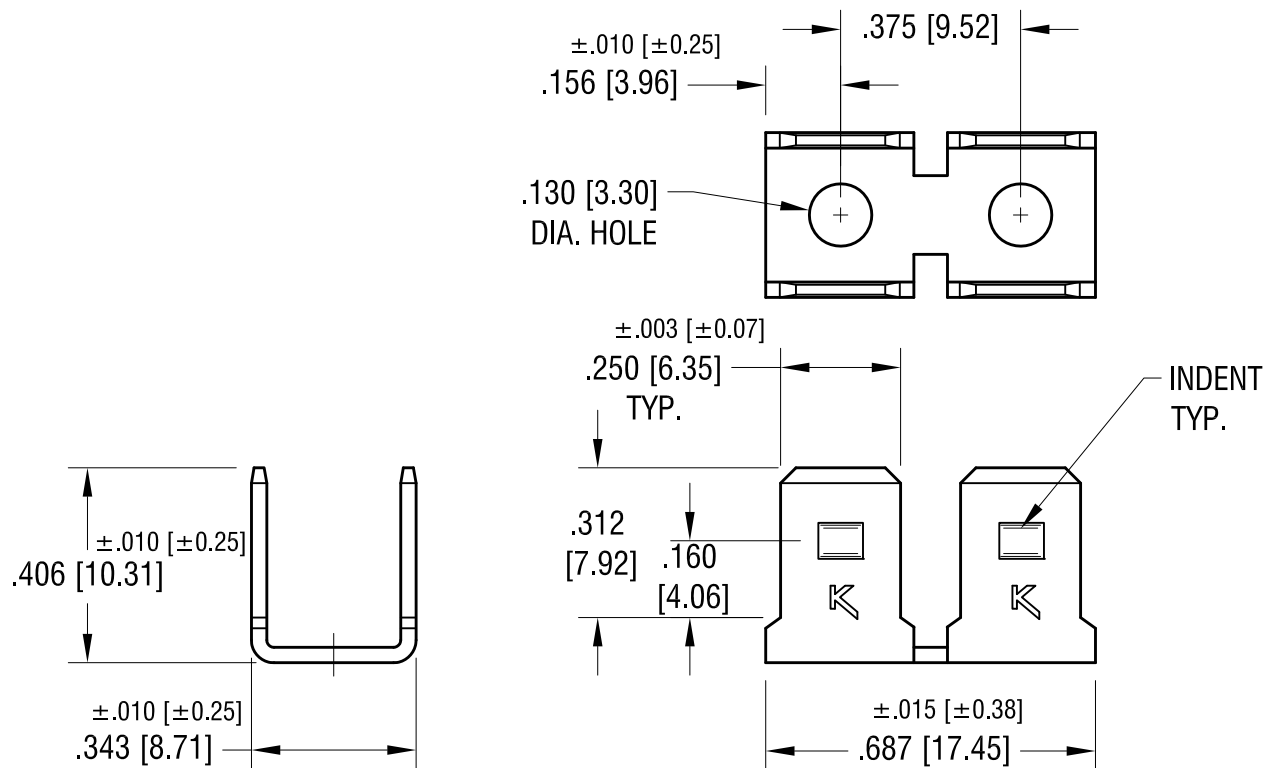
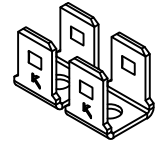

| | | |
|---------|--------------------------|------|
| 8.20.12 | CHANGE AS PER ECN 12-108 | D |
| 6.12.08 | CHANGE AS PER ECN 08-109 | C |
| 4.20.93 | REVISED | B |
| DATE | DESCRIPTION | REV. |

| KEYSTONE ELECTRONICS CORP. | | | |
|---|-----------------|--------|---------|
| www.keyelco.com • ASTORIA, N.Y. 11105-2017 • Tel (718) 956-8900 | | | |
| PART NAME | | | |
| MULTIPLE .250 QUICK-FIT TERMINAL | | | |
| MATERIAL | | | |
| .032 [0.81] TH'K BRASS | | | |
| FINISH | | DRN BY | BOONE |
| BRIGHT BRASS | | DATE | 3.31.82 |
| | | APP'D | LN |
| | | SCALE | 2.5X |
| TOLERANCES | INCH [MM] | CODE | DWG NO. |
| DECIMAL | ± .005 [± 0.15] | C | 1005 |
| ANGULAR | ± 1° | | |
| UNLESS OTHERWISE SPECIFIED | | | |

Mouser Electronics

Authorized Distributor

Click to View Pricing, Inventory, Delivery & Lifecycle Information:

[Keystone Electronics:](#)

[1005](#)