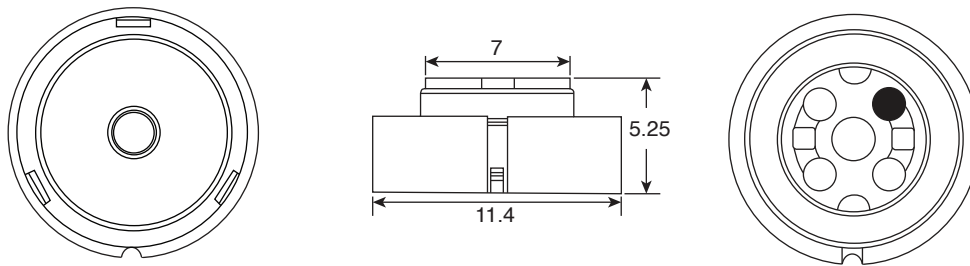
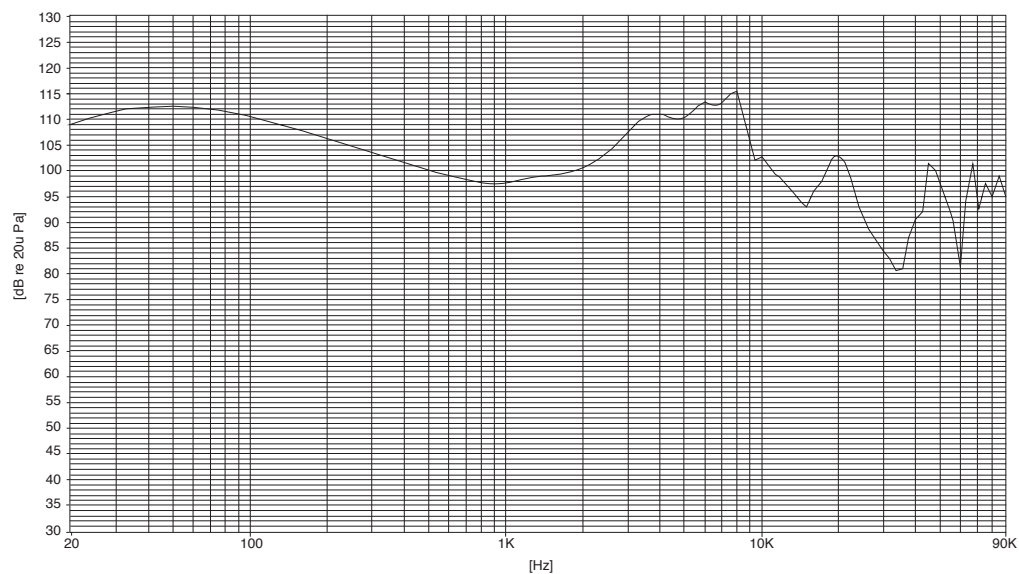

DIMENSIONS: mm**Frequency Response Curve****Specifications:**

- Nominal Impedance: $32\Omega \pm 15\%$ At 1000Hz/0.178V
- Power Rating: Normal 3mW. Maximum 5mW
- Output Sound Pressure: $97 \pm 3\text{dB}/0.178\text{V}$ at 1000Hz (Artificial Ear IEC-60711).
- Frequency Range: 20~20000Hz Average SPL-10dB
- Operating Temperature: -20°C to $+50^{\circ}\text{C}$
- Storage Temperature: -25°C to $+55^{\circ}\text{C}$

Note:

- RoHS Compliant by Exemption

Mouser Electronics

Authorized Distributor

Click to View Pricing, Inventory, Delivery & Lifecycle Information:

Kobitone:

[254-CS132-ROX](#)