



POS. 1	POS. 2
	
ON	MOM
1-3, 4-6	1-2, 4-5
	

SWITCH FUNCTION



Without locking ring.

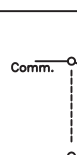
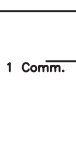
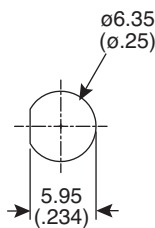
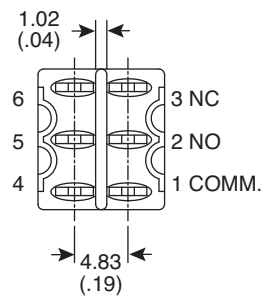
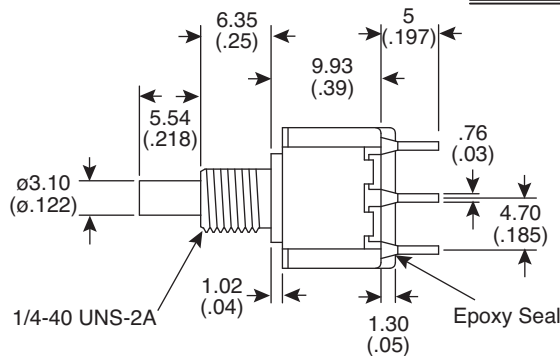
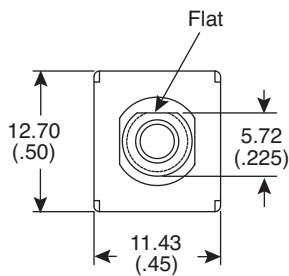
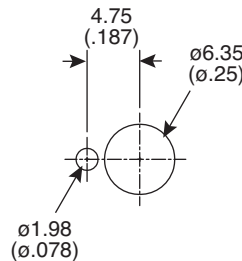

With standard locking ring.

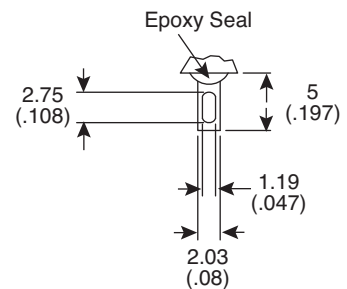

SOLDER LUG

- Rating: 1A/250VAC, 3A/120VAC or 28VDC
- Contact Resistance: 20mΩmax. initial @ 2-4VDC 100mA
- Insulation Resistance: 1,000MΩmin.
- Dielectric Strength: 1,000 V RMS@ sea level

- Mechanical Life: 50,000 make-and-break cycles.
- Operating Temperature: -30°C to 85°C

- Case: Diallyl phthalate (DAP) (UL94V-0)
- Plunger: Glass filled Nylon or Glass filled polyester
- Bushing: Brass, nickel plated
- Housing: Stainless steel.
- Contact: Silver plated.

- RoHS Compliant by Exemption

Mountain Switch

www.mouser.com 1-800-346-6873

Specifications are subject to change without notice. No liability or warranty implied by this information. Environmental compliance based on producer documentation.

Mouser Electronics

Authorized Distributor

Click to View Pricing, Inventory, Delivery & Lifecycle Information:

Mountain Switch:

[107-3009-EVX](#)