

## Dimensions: mm (In.)

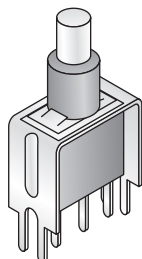
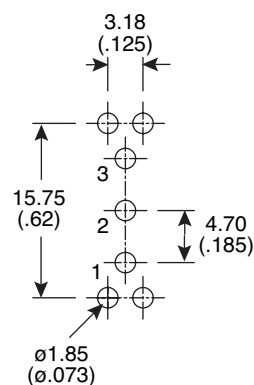
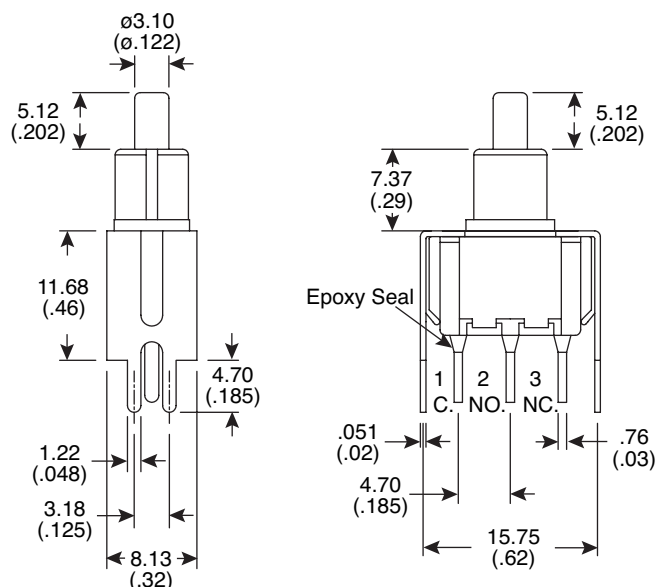
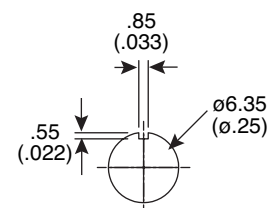

POS. 1	POS. 2
ON	MOM
1-3	1-2

SWITCH FUNCTIONP.C. MOUNTINGPANEL MOUNTING**Mechanical Specifications:**

- Mechanical Life: 50,000 make-and-break cycles.
- Operating Temperature: -30°C to 85°C

**Electrical Specifications:**

- Rating: 1A/250VAC, 3A/120VAC or 28 VDC
- Contact Resistance: 20mΩmax. initial @ 2-4VDC 100mA
- Insulation Resistance: 1,000MΩmin.
- Dielectric Strength: 1,000 V RMS@ sea level

**Materials:**

- Case: Diallyl phthalate (DAP)
- Plunger: Glass filled nylon or glass filled polyester
- Bushing: Brass, nickel plated.
- Housing: Stainless steel
- Contact: Silver plated.

**Note:**

- RoHS compliant by exemption

**Snap-Acting Pushbutton Switch**  
107-3006-EVX

**Mountain**  
**Switch**

# Mouser Electronics

Authorized Distributor

Click to View Pricing, Inventory, Delivery & Lifecycle Information:

Mountain Switch:

[107-3006-EVX](#)