

Dimensions: mm (in.)

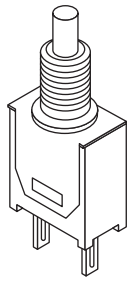

POS. 1	POS. 2
OFF	(ON)
OPEN	1-3

SWITCH FUNCTION

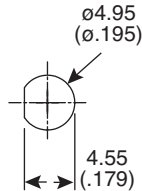
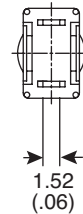
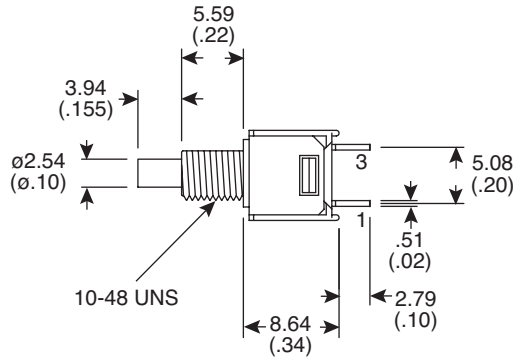
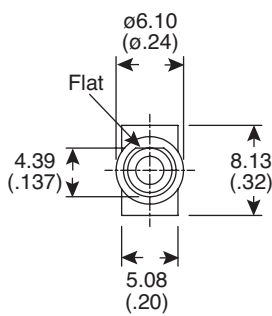

Without Locking Ring.

PANEL MOUNTING

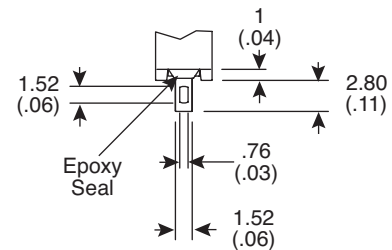

SOLDER LUG

Electrical Specifications:

- Rating: 1A, 250VAC; 3A 120VAC or 28VDC
- Contact Resistance: 20mΩmax. initial @ 2-4VDC 100mA
- Insulation Resistance: 1,000MΩmin.
- Dielectric Strength: 1,000 V RMS@ sea level

Mechanical Specifications:

- Mechanical Life: 60,000 make-and-break cycles.
- Operating Temperature: -30°C to 85°C

Materials:

- Case: Diallyl phthalate (DAP)
- Plunger: Thermoplastic Polyester-black
- Bushing: Brass, nickel plated.
- Housing: Stainless steel
- Contact: Silver or gold plated.
- Terminal: Brass, silver plated
- Terminal Support: Brass, electronin plated.

Note:

- RoHS compliant by exemption

Sub-Miniature Pushbutton Switch
107-3024-EVX



Mouser Electronics

Authorized Distributor

Click to View Pricing, Inventory, Delivery & Lifecycle Information:

[Mountain Switch:](#)

[107-3024-EVX](#)