

Dimensions: mm (in.)

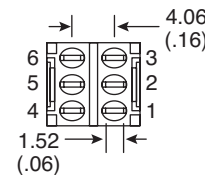

Solder Lug

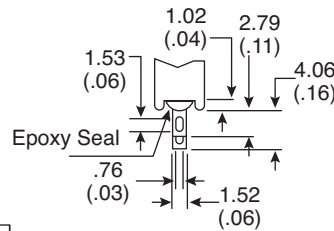
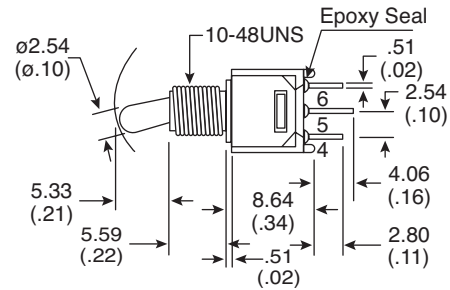
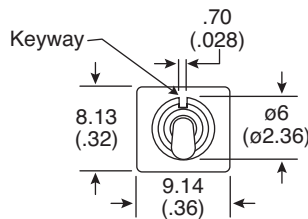
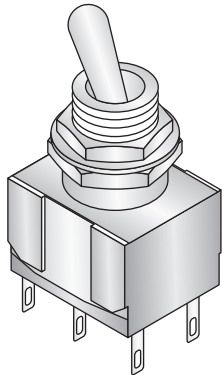
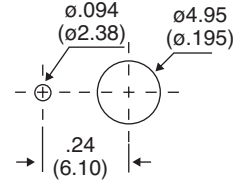
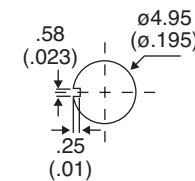

Without locking ring.

With standard locking ring.

PANEL MOUNTING

| POS.1   | POS.2   |
|---------|---------|
|         |         |
| ON      | ON      |
| 2-3,5-6 | 2-1,5-4 |
|         |         |
|         |         |

**Electrical Specifications:**

- Contact Resistance: 20mΩ max. initial @ 2-4VDC 100mA
- Insulation Resistance: 1,000MΩ min.
- Dielectric Strength: 1,000 V RMS@ sea level.
- Rating: 1A / 250 VAC, 3A / 120 VAC or 28 VDC

**Mechanical Specifications:**

- Operating Temperature: -30° C to +85° C

**Note:**

- RoHS Compliant by Exemption

**Materials:**

- Case: Diallyl phthalate (DAP)
- Acuatorator: Brass, chrome plated.
- Bushing: Brass, nickel plated.
- Housing: Stainless steel.
- Terminal/Contact: Brass, silver plated.
- Switch Support: Brass, tin plated.

**Toggle Switch**  
108-2MD1T2B3M1QE-EVX



# Mouser Electronics

Authorized Distributor

Click to View Pricing, Inventory, Delivery & Lifecycle Information:

[Mountain Switch:](#)

[108-2MD1T2B3M1QE-EVX](#)