

R13-412

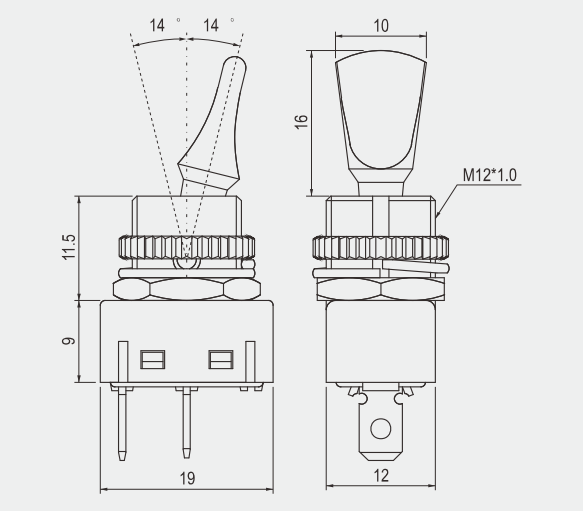

Rating
8A 125V AC 1/3HP 8A 250V AC 1/2HP
Contact resistance
50mΩ Max
Insulation resistance
DC 500V 100MΩ Min
Dielectric strength
AC 1500V 1 minute
Cut-out

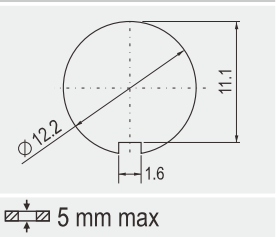

FEATURES

- \* MATERIAL: Paddle, frame and bushing are nylon (UL flame: 94V-2). Terminals are silver plated brass. Base is PBT (UL flame: 94V-0)..
- \* Watertight boot (W-70A) is optional for lever #2 only.

R13-412

FUNCTION	LEVER	TERMINAL
<b>A</b>  2P SPST	<b>1</b> Plastic Lever 	<b>0 2</b> .187" SQ
<b>C</b>  3P SPDT	<b>2</b> Metal Lever 	
<b>D</b>  3P SPDT		
<b>F</b>  2P SPST		

\* ( ) =momentary



# Mouser Electronics

Authorized Distributor

Click to View Pricing, Inventory, Delivery & Lifecycle Information:

[Shin Chin:](#)

[R13-412A1-02](#) [R13-412C1-02](#)