

Dimensions: mm (in)

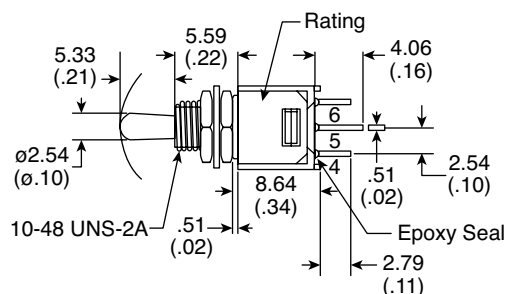

POS.1	POS.2	POS.3
2-3,5-6		2-1,5-4
	OPEN	

SWITCH FUNCTION

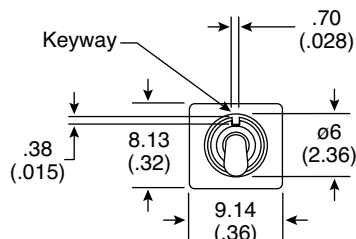
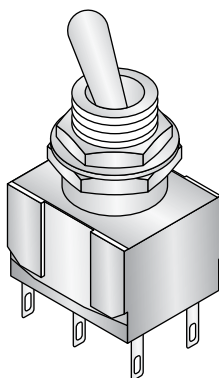
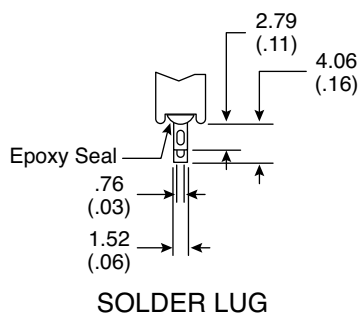

SOLDER LUG

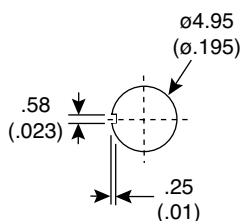
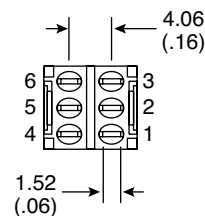

PANEL MOUNTING

Electrical Specifications:

- Contact Resistance: 20mΩ max. initial @ 2-4VDC 100mA
- Insulation Resistance: 1,000MΩ min.
- Dielectric Strength: 1,000 V RMS@ sea level
- Rating: 1A/250VAC, 3A/120VAC or 28VDC

Mechanical Specifications:

- Operating Temperature: -30°C to +85°C
- Mechanical Life: 30,000 make-and-break cycles

Note:

- RoHS compliant by exemption

Materials:

- Case: Diallyl phthalate (DAP)
- Actuator: Brass, chrome plated.
- Bushing: Brass, nickel plated.
- Housing: Stainless steel.
- Switch Support: Brass, Tin plated.
- Terminal/Contact: Brass, silver plated

Toggle Switch
108-2MD3T2B3M1QE-EVX

Mountain
Switch

Mouser Electronics

Authorized Distributor

Click to View Pricing, Inventory, Delivery & Lifecycle Information:

Mountain Switch:

[108-2MD3T2B3M1QE-EVX](#)