

| Date | Name | Description | No. |
|----------|------|--|-----|
| 07/07/20 | 袁浩徐 | Metal insert 材質依BOM由zinc alloy=> brass alloy | △ |
| | | | △ |

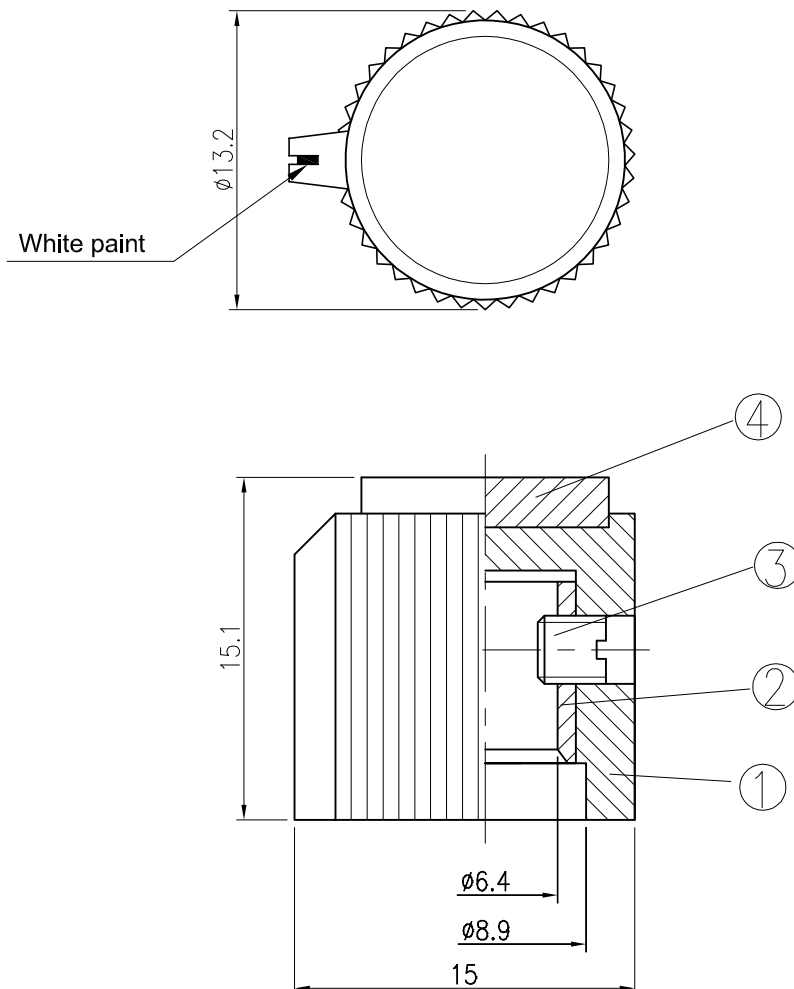

Shaft Hole $\phi 6.4$

Tolerances $\pm 0.3\text{mm}$ Unless Otherwise Specified

| 4 | Cover | 1 | ABS | Red | | |
|----------|--------------|----------|---------------|------------------------|--------------------------------|---------------|
| 3 | Screw | 1 | Brass alloy | M4*P0.7*5L | | |
| 2 | Metal insert | 1 | Brass alloy △ | $\phi 9.2*8L*\phi 6.4$ | | |
| 1 | Housing | 1 | PF | Black | | |
| No | Description | Q'ty | Material | Specification | Finish | Remark |
| Drawn | Checked | Approved | SCI BOM No. | 1430316 | Model Name | CONTROL KNOBS |
| 袁浩徐 | | | Customer No. | 112-RN-118F-BR/6.4 | Model No. | RN-118F-BR |
| 07/07/20 | | | Unit | mm | Shin Chin Industrial Co., Ltd. | |
| | | | | | | Rev. 1 |

Mouser Electronics

Authorized Distributor

Click to View Pricing, Inventory, Delivery & Lifecycle Information:

[Shin Chin:](#)

[RN-118F-BR/6.4](#)