

Series 11

MINIATURE 10 AMP DOUBLE-BREAK SNAP ACTION SWITCHES

This rugged miniature switch features the Butterfly® double-break snap action switch mechanism. It is ideal for tough applications where high current capability and Butterfly® reliability are needed.



ACTUAL SIZE

APPLICATIONS

- Welding guns
- Pipeline valve actuator
- Discrete length tape dispenser machines
- Lift trucks
- Electrical contractors

KEY FEATURES:

- Gold or silver contacts
- Variety of terminals configurations and styles available
- UL recognized and CSA certified
- Reset style switch available
- Roller lever and overtravel plunger actuator are available

ORDERING INFORMATION:

Switches

| Part Number | Terminals |
|---------------------|-----------------------|
| 11-104 | End Solder |
| 11-204 | #4 Screw |
| 11-304 | Side Solder |
| 11-314 Reset | Side Solder |
| 11-504 | Quick Disconnect .250 |

Actuators (see page 68 for additional specifications)

| Part Number | Oper. Force | Release Force | Pretravel | Overtravel | Movement Diff. | Operating Point |
|--------------------------------|-------------|---------------|-----------|------------|----------------|-----------------|
| 71-1040 Roller Lever | 3.5 oz max | 2 oz min | .093 max | .062 min | .030 ± .015 | .671 ± .031 |
| 71-2010 Over Travel | 8 ± 3 oz | 4 oz min | .050 max | .215 min | .020 ± .005 | .828 ± .015 |

STANDARDS / AGENCY / RATINGS:



END SOLDER

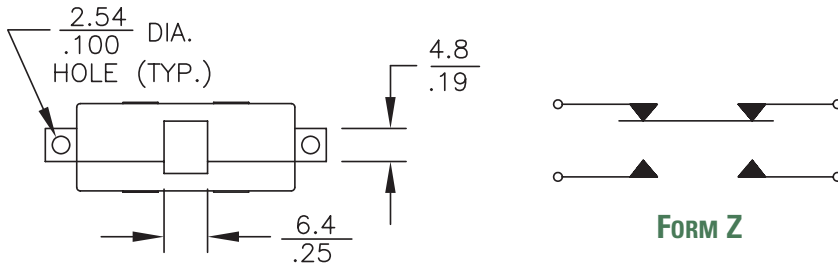

4 SCREW

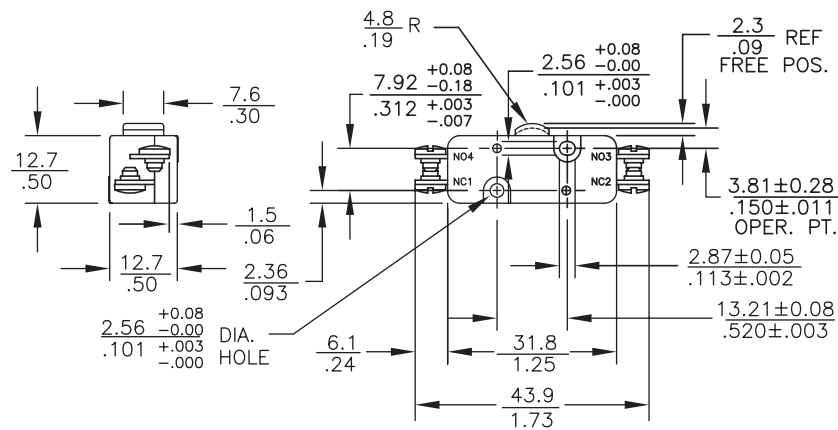
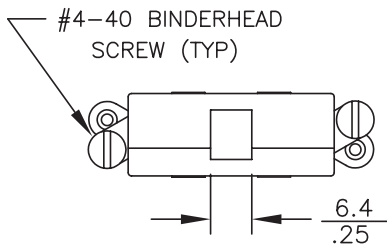

SIDE SOLDER

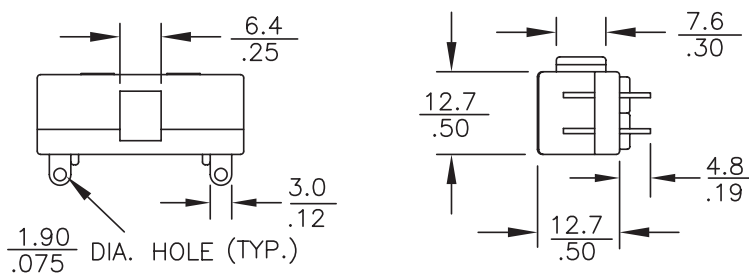

QUICK DISCONNECT

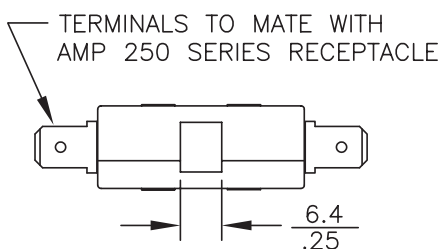

MECHANICAL / ELECTRICAL CHARACTERISTICS:

- Pretravel:**
0.050 inches max
- Overtravel:**
0.015 inches min
- Operating Force:**
8 oz + 3 oz
- Release Force:**
4 oz min
- Movement Differential:**
0.020 ± 0.007 inches
- Operating Point:**
0.150 ± 0.011 inches
(from mounting hold centers)
- Circuit:**
SPDT-DB (Form Z)

Electrical Ratings (Typical):

| Circuitry | 125/250 VAC | 28 VDC |
|---|--|--------------------------|
| SPST-DB NC (Form Y) or NO (Form X) | 10 amp (75-80% PF) 1/2 HP 125 VAC | 10 amp Ind 15 amp Res |
| SPDT-DB (Form Z) | 3/4 HP 250 VAC | 7 amp Ind 10 amp Res |
| SPDT-SB (Form C) | | 4 amp Ind 6 amp Res |

SEE PAGE 46
FOR SWITCHES

Series 11 Actuators

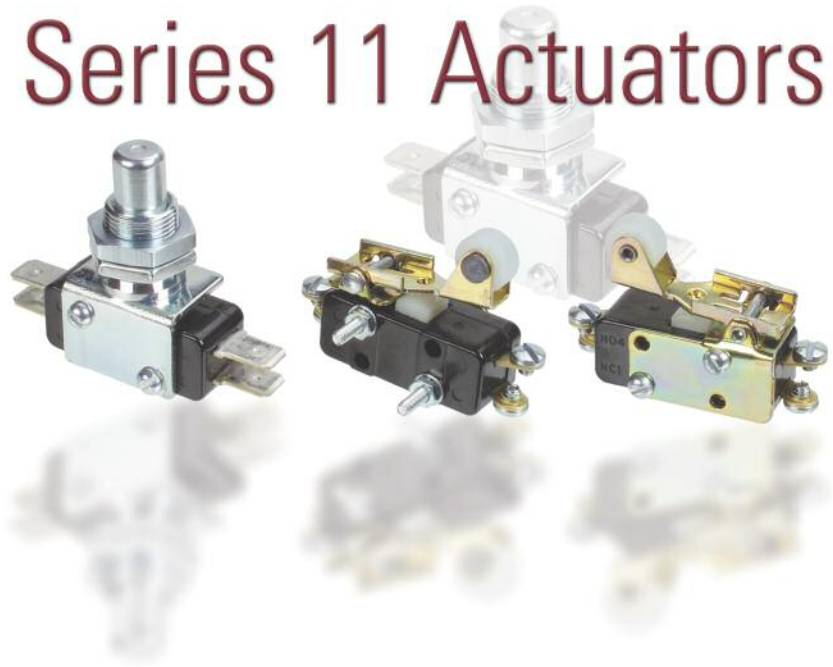

KEY FEATURES:

- Roller Lever
- Overtravel

MECHANICAL CHARACTERISTICS*:

| Part Number | Oper. Force | Release Force | Pretravel | Overtravel | Movement Diff. | Operating Point |
|--------------------------------------|-------------|---------------|-----------|------------|----------------|-----------------|
| 71-1040 Roller Lever | 3.5 oz max | 2 oz min | .093 max | .062 min | .030 ± .015 | .671 ± .031 |
| 71-2010 Overtravel Plunger | 8 ± .3 oz | 4 oz min | .050 max | .215 min | .020 ± .005 | .828 ± .015 |

*Mechanical characteristics when used with Basic Switch 11-104.

71-1040

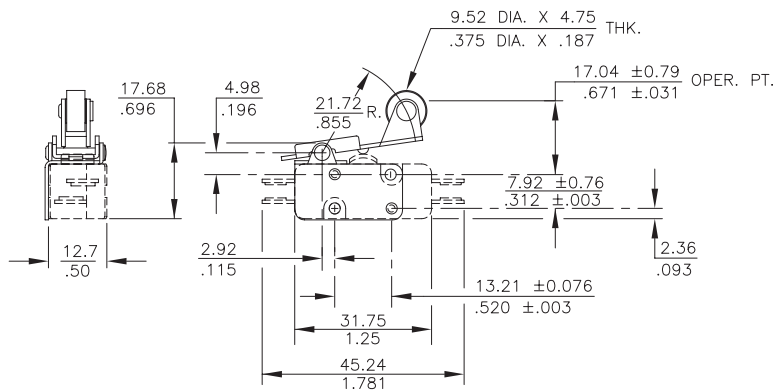

71-2010

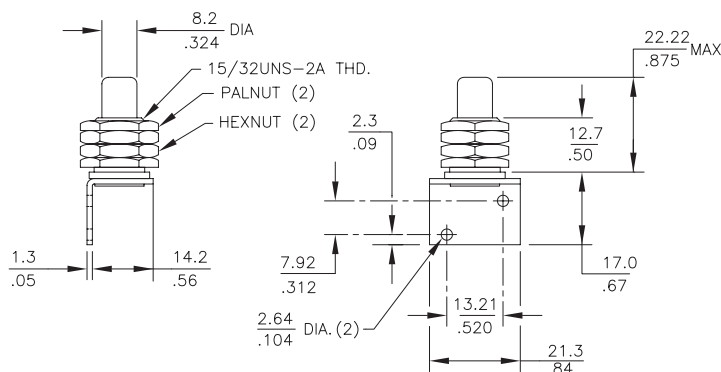

Mouser Electronics

Authorized Distributor

Click to View Pricing, Inventory, Delivery & Lifecycle Information:

[ITW Switches:](#)

[11-104](#) [11-304](#) [11-504](#)