



Inspired LED's **Clear Mounting Clips** pair with our Infinity Series Weather Resistant LED Dura-flex, allowing it to be securely installed in a variety of locations. The clear mounting clips screw into flat surfaces, providing additional support for the Infinity Dura-flex.

SKU #CLEAR

Product Features:

Clear plastic bridge clips over Infinity Dura-flex, serrated underside to prevent slippage, screw hole on either side for mounting

**Sold in packs of 10,
includes 20 screws**

Specifications:

External Dimensions- .

0.40" x 0.40" x 1.36"

Internal Dimensions-

0.55" x 0.32"

Screw Hole- 0.1"

Net Weight- 1g (ea)

Instructions:

1. Assemble Infinity Series LED system according to its instructions. Temporarily mount in place using masking or painter's tape.
2. Once satisfied with the placement of LEDs, use a bead of outdoor rated adhesive or silicone along the backside of Infinity Dura-flex to mount permanently in place, leaving tape up for support until glue has dried.
3. Install clear mounting clips over Infinity Dura-flex by screwing into place every few feet as needed for additional support.

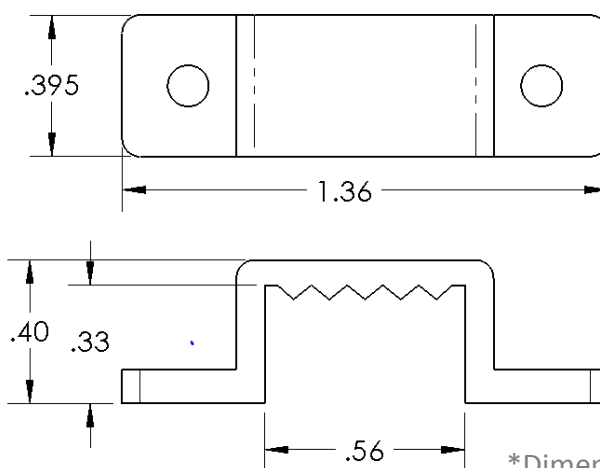

*Dimensions
shown in inches



Mouser Electronics

Authorized Distributor

Click to View Pricing, Inventory, Delivery & Lifecycle Information:

Inspired LED:

[CLEAR](#)