

# Battery and Connector Probes

## 100410 PROBE

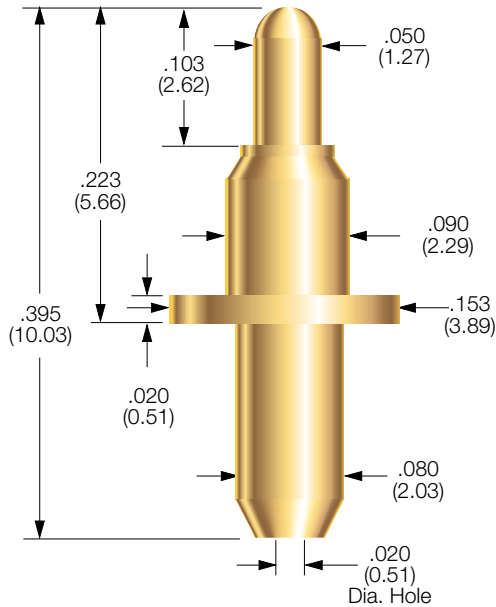

### PROBE SPECIFICATIONS

**Minimum Centers:** .175 (4.45)  
**Current Rating:** 15 amps continuous  
(Individual probe in free air @ ambient temperature)  
**Spring Force:** 6.2 oz. (176g) @ .060 (1.52) travel  
**Typical Resistance:** < 5 mΩ  
**Maximum Travel:** .090 (2.29)  
**Working Travel:** .060 (1.52)

### MATERIALS

**Barrel:** Nickel/silver, gold plated  
**Spring:** Stainless steel  
**Plunger:** Beryllium copper, gold plated  
**Bias Ball:** Stainless steel

## HOW TO ORDER

100410-005

## 101119 PROBE

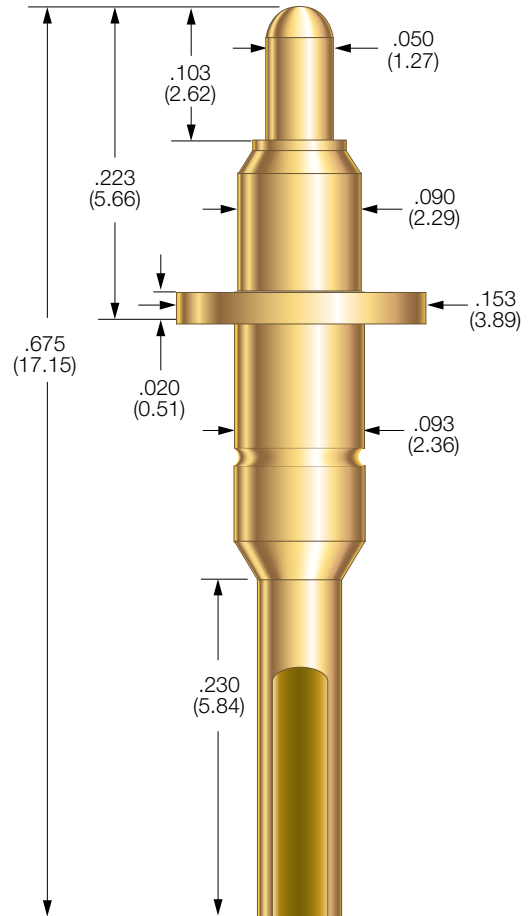

### PROBE SPECIFICATIONS

**Minimum Centers:** .175 (4.45)  
**Current Rating:** 15 amps continuous  
(Individual probe in free air @ ambient temperature)  
**Spring Force:** 6.2 oz. (176g) @ .060 (1.52) travel  
**Typical Resistance:** < 10 mΩ  
**Maximum Travel:** .090 (2.29)  
**Working Travel:** .060 (1.52)

### MATERIALS

**Barrel:** Nickel/silver, gold plated  
**Spring:** Stainless steel  
**Plunger:** Beryllium copper, gold plated  
**Bias Ball:** Stainless steel  
**Receptacle:** Nickel/silver, gold plated

## HOW TO ORDER

101119-001

Specifications subject to change without notice. Dimensions in inches (millimeters)

# Mouser Electronics

Authorized Distributor

Click to View Pricing, Inventory, Delivery & Lifecycle Information:

[Smiths Interconnect:](#)

[100410-005](#) [101119-001](#)