

HONEYWELL
PART NUMBER
77050

HONEYWELL PART NUMBER, PRESSURE
SETTING AND DATE CODE

REV	DOCUMENT	CHANGED BY	CHECK
D	0068753	VKK 03SEP10	CMH

MATES WITH PACKARD CONNECTOR
#12034147

CUSTOMER: _____

APPROVED BY: _____

DATE: _____

CUSTOMER
PART NO.: _____

1/8-27 NPT

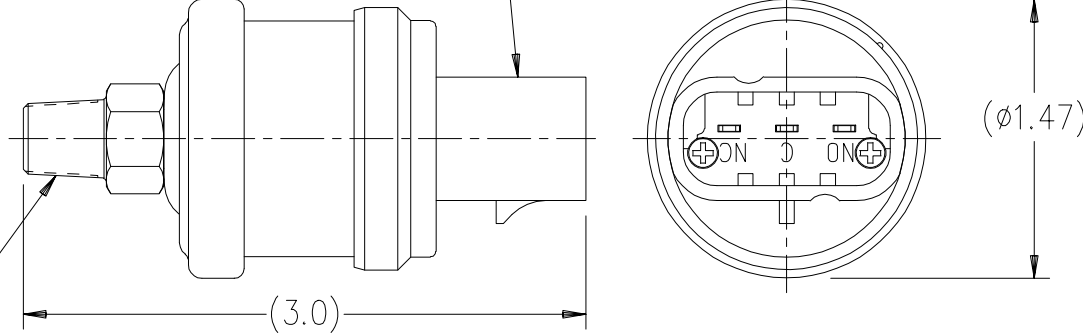

NOTES:

1. DUAL CIRCUIT PRESSURE SWITCH.
2. NORMALLY CLOSED CIRCUIT TO OPEN AT 25 - 46 PSI.
3. SWITCH MAY BE ADJUSTED SO THAT:
 - A) N.C. CIRCUIT OPENS BEFORE N.O. CIRCUIT CLOSES.
 - B) N.C. AND N.O. CIRCUIT HAVE SAME SET POINT.
 - C) N.O. CIRCUIT CLOSES BEFORE N.C. CIRCUIT OPENS.
 ORDER MUST SPECIFY TYPE OF SWITCH AND SET POINT FOR EACH CIRCUIT.
4. SWITCH IS FURNISHED WITH STEEL BASE ASSY. (.500 HEX)
AS A STANDARD UNLESS BRASS BASE ASSY. (.437 HEX)
IS SPECIFIED AS AN OPTION BY CUSTOMER ADDING
SUFFIX "B" TO THE HONEYWELL PART NUMBER ON THE
PURCHASE ORDER, e.g. XXXXXB.
5. DIMENSIONS ARE FOR REFERENCE ONLY UNLESS OTHERWISE SPECIFIED.

CUSTOMER PRINT

DESIGN UNITS: INCH

TOLERANCES UNLESS NOTED:

NO PLACES	X	±	-
ONE PLACE	.X	±	.020
TWO PLACE	.XX	±	.010
THREE PLACE	.XXX	±	.005
FOUR PLACE	.XXXX	±	.0005
ANGLES	X	±	0°30'

THIRD ANGLE PROJECTION

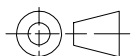

DRAWN D MCGEE 24OCT01

CHECK - -
THIS DRAWING COVERS A PROPRIETARY ITEM
AND IS THE PROPERTY OF HONEYWELL.
THIS DRAWING IS NOT TO BE COPIED OR USED
WITHOUT THE PERMISSION OF HONEYWELL.

INTERPRET PERASME Y14.5M-1994
OTHER HONEYWELL ENGINEERING
STANDARDS MAY APPLY

AUTOCAD

2D

Honeywell

TITLE PRESSURE SWITCH D.C.
(BOTH CIRCUITS ADJUSTABLE)
METRI-PACK 5000 SERIES SWITCH)

SIZE	TYPE	CAGE CODE	DRAWING NAME	REV
A	I	-	77050	D
SCALE	NONE		SHEET	1 OF 1

Mouser Electronics

Authorized Distributor

Click to View Pricing, Inventory, Delivery & Lifecycle Information:

[Honeywell:](#)

[77050-04000400-01](#)