

MICRO SWITCH
a Honeywell Division

FED.MFG.CODE 91929

SWITCH - BASIC

CATALOG LISTING

V7-1D10D8

CW-B2061

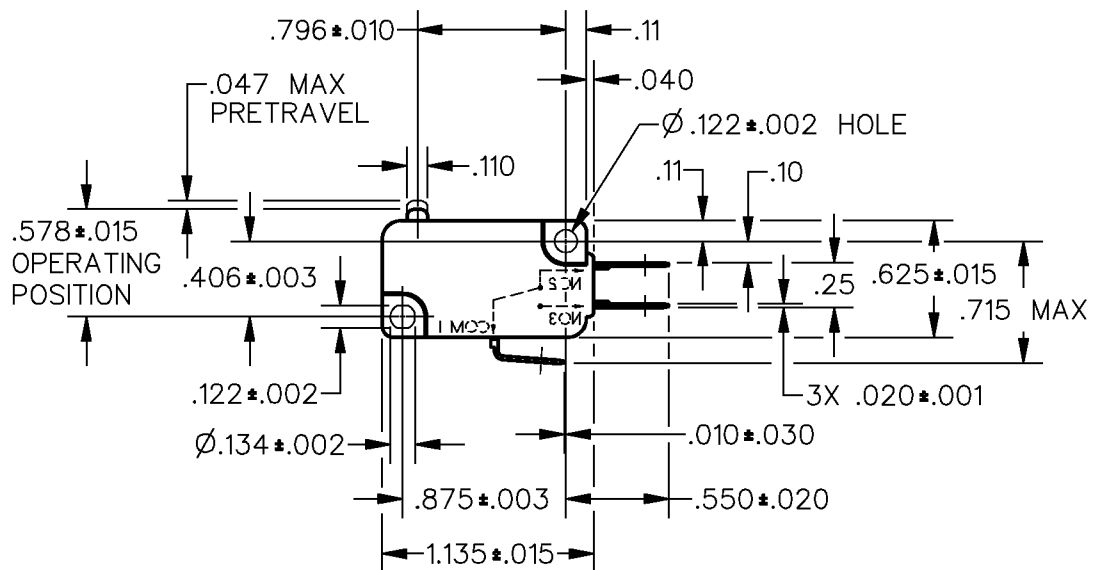
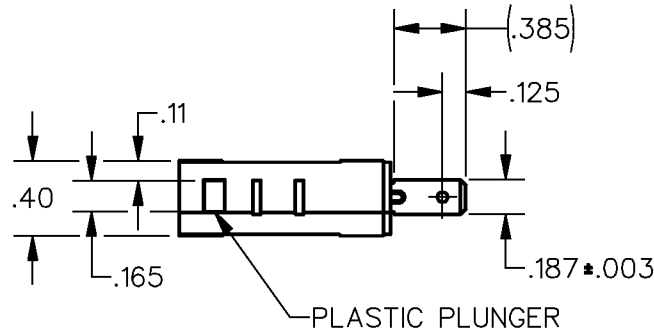

NOTES

- 1 - IN INSPECTION, DO NOT BURN OUT - GOLD CONTACTS
- 2 - IN INSPECTION, DO NOT EXCEED 10 VDC, .1A RESISTIVE LOAD
- 3 - INSPECT SWITCH RESISTANCE PER CONTROL PLAN

ANSI Y14.5M-1982 APPLIES

THIS DRAWING COVERS A PROPRIETARY ITEM AND IS THE PROPERTY OF MICRO SWITCH, A DIVISION OF HONEYWELL. THIS DRAWING IS NOT TO BE COPIED OR USED WITHOUT THE APPROVAL OF MICRO SWITCH.

THIRD ANGLE PROJECTION

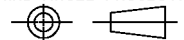

CHARACTERISTICS		ELECTRICAL DATA	SCALE FULL	DO NOT SCALE PRINT
OPERATING FORCE — — — 150 GRAMS MAX		CONTACT ARRANGEMENT	UNLESS OTHERWISE SPECIFIED TOLERANCES ARE	
RELEASE FORCE — — — 25 GRAMS MIN		S P D T		
DIFFERENTIAL TRAVEL — — — .002-.010		L22 1A 125 VAC	ONE PLACE (.0)	± .030
OVERTRAVEL — — — .050 MIN			TWO PLACE (.00)	± .015
FREE POSITION — — — .625 MAX			THREE PLACE (.000)	± .005
RELEASE TRAVEL — — — .010 MIN			ANGLES	±
			WEIGHT	



CATALOG LISTING
V7-1D10D8
PAGE 1 OF 1

ISSUE
M
4

REVISIONS

A	CO-1 93311	TSM 21 OCT 98
B	202141	JAH 11 JAN 01
C	0005782	RJ 04 JUN 04

REPLACES X110332-V7

RELEASE NO. PR-23274

CHECK

04 JUN 04

AK

CHECK

17 DEC 97

DCS

CHECK

17 DEC 97

DCS

CHECK

17 DEC 97

RASTER
DRAWN

Mouser Electronics

Authorized Distributor

Click to View Pricing, Inventory, Delivery & Lifecycle Information:

[Honeywell:](#)

[V7-1D10D8](#)