

**MICRO SWITCH**  
a Honeywell Division

FED. MFG. CODE 91929

SWITCH-BASIC

CATALOG LISTING

V7-3S17D8-148

CW-B8586

CATALOG LISTING  
V7-3S17D8-148  
PAGE 1 OF 1

ISSUE  
**M**  
3

REVISIONS  
A PR REL 24225  
JJA 27 AUG 99  
B CO- 95607  
DLT 4 NOV 99

REPLACES

RELEASE NO. PR-24225

CHECK

CHECK

25MAY99

JJA F

CHECK

25MAY99

DRAWN

FORMTEK

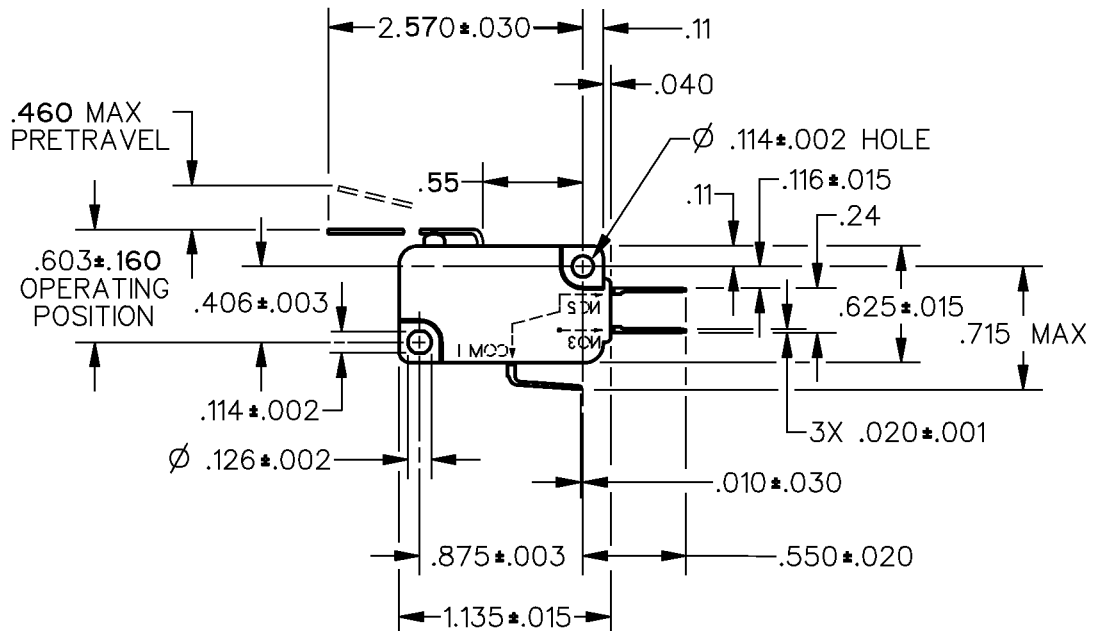
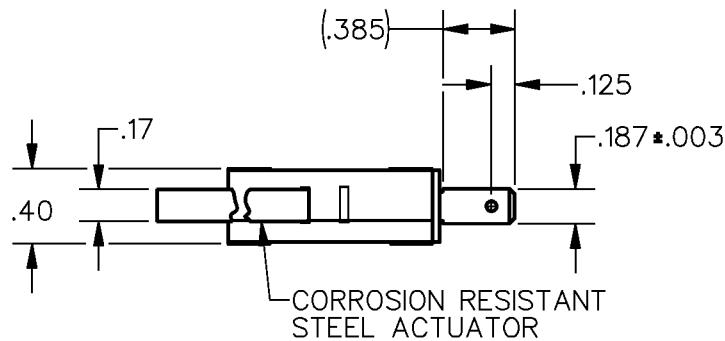

NOTES

- 1 - IN INSPECTION, DO NOT BURN OUT - GOLD CONTACTS
- 2 - IN INSPECTION, DO NOT EXCEED 10 VDC, .1A RESISTIVE LOAD

ANSI Y14.5M-1982 APPLIES

THIS DRAWING COVERS A PROPRIETARY ITEM AND IS THE PROPERTY OF MICRO SWITCH, A DIVISION OF HONEYWELL. THIS DRAWING IS NOT TO BE COPIED OR USED WITHOUT THE APPROVAL OF MICRO SWITCH.

THIRD ANGLE PROJECTION

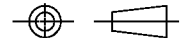

CHARACTERISTICS

OPERATING FORCE — — — 8 GRAMS MAX  
RELEASE FORCE — — — — 1/2 GRAM MIN  
DIFFERENTIAL TRAVEL — — — .103 MAX  
RELEASE TRAVEL — — — — .057 MIN  
OVERTRAVEL — — — — — .206 MIN

ELECTRICAL DATA

CONTACT ARRANGEMENT  
S P D T

L142

0.1A 125 VAC



SCALE FULL

DO NOT  
SCALE PRINT

UNLESS OTHERWISE SPECIFIED  
TOLERANCES ARE

ONE PLACE (.0) ±.030

TWO PLACE (.00) ±.015

THREE PLACE (.000) ±.005

ANGLES ±

WEIGHT

# Mouser Electronics

Authorized Distributor

Click to View Pricing, Inventory, Delivery & Lifecycle Information:

[Honeywell:](#)

[V7-3S17D8-148](#)