

Honeywell

FED. MFG. CODE 91929

SWITCH - BASIC

CATALOG LISTING

V7-6C17D8-162

CW-C6022

CATALOG LISTING

V7-6C17D8-162

REPLACES

RELEASE NO. PR-16980

M

ISSUE
7

CHECK

REVISIONS

A	PR 16980	11 JUL 08
	WJM	16 DEC 88
B	CO 66350	
	JAP	20 SEP 89
C	CO 73424	
	JWB	5 NOV 92
D	CO 74165	
	D H D	28 DEC 92
E	CO 76430	
	JWB	4 NOV 93
F	0041190	
	PK	11 JUL 08

ASD

CHECK

8 DEC 88

JAP

CHECK

8 DEC 88

JWB

DRAWN

WJM

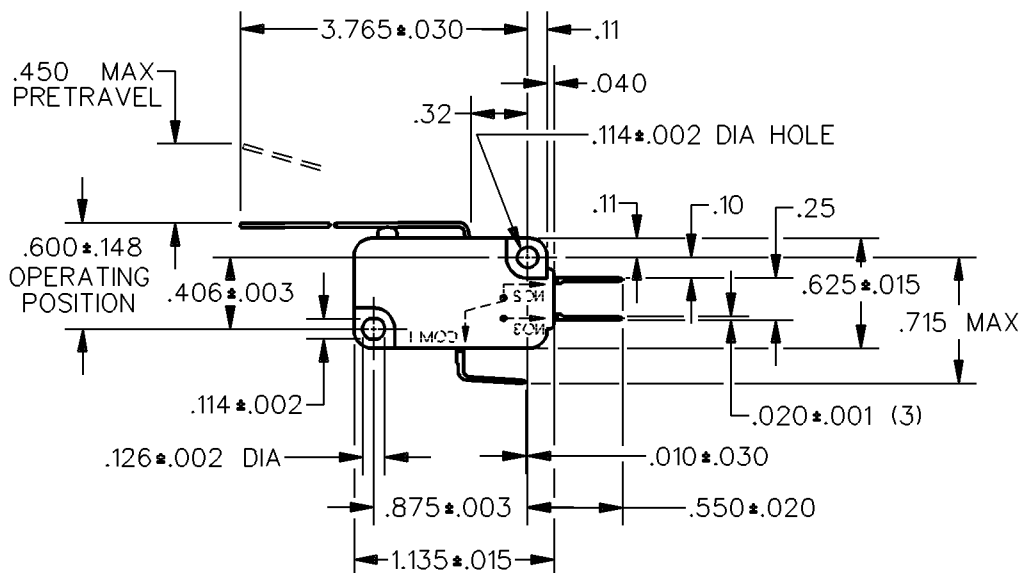
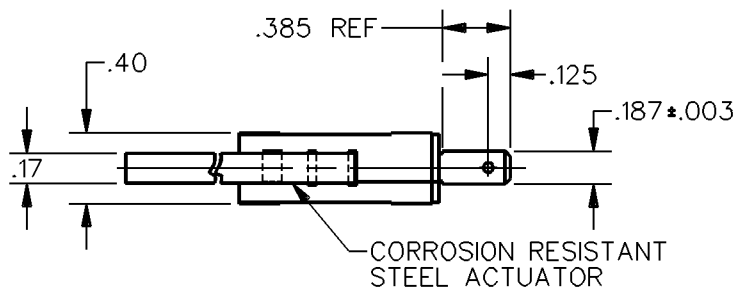

THIS DRAWING COVERS A PROPRIETARY ITEM AND IS THE PROPERTY OF HONEYWELL.
THIS DRAWING IS NOT TO BE COPIED OR USED WITHOUT THE APPROVAL OF HONEYWELL.

THIRD ANGLE PROJECTION

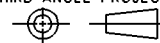

CHARACTERISTICS

OPERATING FORCE — — — — 3 OZ MAX
DIFFERENTIAL TRAVEL — — — .156 MAX
OVERTRAVEL — — — — — .142 MIN
RELEASE TRAVEL — — — — — .032 MIN

ELECTRICAL DATA

CONTACT ARRANGEMENT
S P D T

L215

15.1A 1/2HP 125, 250 OR 277 VAC
1/2A 125 VDC
1/4A 250 VDC; 5A 125 VAC "L"



SCALE

—

DO NOT
SCALE PRINT

UNLESS OTHERWISE SPECIFIED
TOLERANCES ARE

ONE PLACE (.0) ±.030

TWO PLACE (.00) ±.015

THREE PLACE (.000) ±.005

ANGLES ±

WEIGHT

RASTER

Mouser Electronics

Authorized Distributor

Click to View Pricing, Inventory, Delivery & Lifecycle Information:

[Honeywell:](#)

[V7-6C17D8-162](#)